

TRK

Trunking Sistemleri Trunking Systems

APEX METAL CABLE TRAY SYSTEMS



TRK Serisi / Serie

*ve Aksesuarlar
and Accessories*

TRK Trunking Sistemleri

Trunking Systems

| Kategoriler Categories | Sayfa No Page No | İNDEKS / INDEX |
|---------------------------|---------------------|--|
| h:50 | TRK 01 | Trunking ve Ek Elemanı / Trunking and Joint Pieces |
| | TRK 02 | Trunking Yatay 90° -T Dönüş - Dörtlü Dönüş / Trunking Horizontal Bends Bends 90° -Tee Branches - Crossing |
| | TRK 03 | Trunking İç Bükey - Dış Bükey - Sonlandırma Elemanı / Trunking Vertical Inside bend - Outside Bend and End Cap |
| | TRK 04 | Z Tip Redüksiyon Sol-Sağ-Ortadan / Z Type Reducer Left-Right-Center |
| h:75 | TRK 05 | Trunking ve Ek Elemanı / Trunking and Joint Pieces |
| | TRK 06 | Trunking Yatay 90° -T Dönüş - Dörtlü Dönüş / Trunking Horizontal Bends Bends 90° -Tee Branches - Crossing |
| | TRK 07 | Trunking İç Bükey - Dış Bükey - Sonlandırma Elemanı / Trunking Vertical Inside bend - Outside Bend and End Cap |
| | TRK 08 | Z Tip Redüksiyon Sol-Sağ-Ortadan / Z Type Reducer Left-Right-Center |
| h:100 | TRK 09 | Trunking ve Ek Elemanı / Trunking and Joint Pieces |
| | TRK 10 | Trunking Yatay 90° -T Dönüş - Dörtlü Dönüş / Trunking Horizontal Bends Bends 90° -Tee Branches - Crossing |
| | TRK 11 | Trunking İç Bükey - Dış Bükey - Sonlandırma Elemanı / Trunking Vertical Inside bend - Outside Bend and End Cap |
| | TRK 12 | Z Tip Redüksiyon Sol-Sağ-Ortadan / Z Type Reducer Left-Right-Center |
| h:125 | TRK 13 | Trunking ve Ek Elemanı / Trunking and Joint Pieces |
| | TRK 14 | Trunking Yatay 90° -T Dönüş - Dörtlü Dönüş / Trunking Horizontal Bends Bends 90° -Tee Branches - Crossing |
| | TRK 15 | Trunking İç Bükey - Dış Bükey - Sonlandırma Elemanı / Trunking Vertical Inside bend - Outside Bend and End Cap |
| | TRK 16 | Z Tip Redüksiyon Sol-Sağ-Ortadan / Z Type Reducer Left-Right-Center |
| h:150 | TRK 17 | Trunking ve Ek Elemanı / Trunking and Joint Pieces |
| | TRK 18 | Trunking Yatay 90° -T Dönüş - Dörtlü Dönüş / Trunking Horizontal Bends Bends 90° -Tee Branches - Crossing |
| | TRK 19 | Trunking İç Bükey - Dış Bükey - Sonlandırma Elemanı / Trunking Vertical Inside bend - Outside Bend and End Cap |
| | TRK 20 | Z Tip Redüksiyon Sol-Sağ-Ortadan / Z Type Reducer Left-Right-Center |
| h:200 | TRK 21 | Trunking ve Ek Elemanı / Trunking and Joint Pieces |
| | TRK 22 | Trunking Yatay 90° -T Dönüş - Dörtlü Dönüş / Trunking Horizontal Bends Bends 90° -Tee Branches - Crossing |
| | TRK 23 | Trunking İç Bükey - Dış Bükey - Sonlandırma Elemanı / Trunking Vertical Inside bend - Outside Bend and End Cap |
| | TRK 24 | Z Tip Redüksiyon Sol-Sağ-Ortadan / Z Type Reducer Left-Right-Center |
| h:250 | TRK 25 | Trunking ve Ek Elemanı / Trunking and Joint Pieces |
| | TRK 26 | Trunking Yatay 90° -T Dönüş - Dörtlü Dönüş / Trunking Horizontal Bends Bends 90° -Tee Branches - Crossing |
| | TRK 27 | Trunking İç Bükey - Dış Bükey - Sonlandırma Elemanı / Trunking Vertical Inside bend - Outside Bend and End Cap |
| | TRK 28 | Z Tip Redüksiyon Sol-Sağ-Ortadan / Z Type Reducer Left-Right-Center |
| h:300 | TRK 29 | Trunking ve Ek Elemanı / Trunking and Joint Pieces |
| | TRK 30 | Trunking Yatay 90° -T Dönüş - Dörtlü Dönüş / Trunking Horizontal Bends Bends 90° -Tee Branches - Crossing |
| | TRK 31 | Trunking İç Bükey - Dış Bükey - Sonlandırma Elemanı / Trunking Vertical Inside bend - Outside Bend and End Cap |
| COVERS | TRK 32 | Trunking - Trunking Yatay 90° -T Dönüş - Dörtlü Kapakları / Trunking Horizontal Bends Bends 90° -Tee Branches - Crossing Covers |
| | TRK 33 | Trunking İç Bükey - Dış Bükey Kapakları / Trunking Vertical Inside bend - Outside Bend Covers |

TRK SERİSİ / SERIE

TRK

TRK Serisi / Serie

| Sipariş Kodu (Order Code) | w (mm) | h (mm) | t (mm) | Kg/Mt (Kg/Mt) |
|------------------------------|-----------|-----------|-----------|------------------|
| AP-TR05.10/50 | 50 | 50 | 1,00 | 1,476 |
| AP-TR05.12/50 | 50 | 50 | 1,20 | 1,771 |
| AP-TR05.15/50 | 50 | 50 | 1,50 | 2,214 |
| AP-TR05.20/50 | 50 | 50 | 2,00 | 2,656 |
| AP-TR07.10/50 | 75 | 50 | 1,00 | 1,672 |
| AP-TR07.12/50 | 75 | 50 | 1,20 | 2,006 |
| AP-TR07.15/50 | 75 | 50 | 1,50 | 2,508 |
| AP-TR07.20/50 | 75 | 50 | 2,00 | 3,010 |
| AP-TR10.10/50 | 100 | 50 | 1,00 | 1,868 |
| AP-TR10.12/50 | 100 | 50 | 1,20 | 2,242 |
| AP-TR10.15/50 | 100 | 50 | 1,50 | 2,802 |
| AP-TR10.20/50 | 100 | 50 | 2,00 | 3,363 |
| AP-TR12.10/50 | 125 | 50 | 1,00 | 2,065 |
| AP-TR12.12/50 | 125 | 50 | 1,20 | 2,477 |
| AP-TR12.15/50 | 125 | 50 | 1,50 | 3,097 |
| AP-TR12.20/50 | 125 | 50 | 2,00 | 3,716 |
| AP-TR15.10/50 | 150 | 50 | 1,00 | 2,261 |
| AP-TR15.12/50 | 150 | 50 | 1,20 | 2,713 |
| AP-TR15.15/50 | 150 | 50 | 1,50 | 3,391 |
| AP-TR15.20/50 | 150 | 50 | 2,00 | 4,069 |
| AP-TR20.10/50 | 200 | 50 | 1,00 | 2,653 |
| AP-TR20.12/50 | 200 | 50 | 1,20 | 3,184 |
| AP-TR20.15/50 | 200 | 50 | 1,50 | 3,980 |
| AP-TR20.20/50 | 200 | 50 | 2,00 | 4,776 |
| AP-TR25.12/50 | 250 | 50 | 1,20 | 3,655 |
| AP-TR25.15/50 | 250 | 50 | 1,50 | 4,569 |
| AP-TR25.20/50 | 250 | 50 | 2,00 | 5,482 |
| AP-TR30.12/50 | 300 | 50 | 1,20 | 4,126 |
| AP-TR30.15/50 | 300 | 50 | 1,50 | 5,157 |
| AP-TR30.20/50 | 300 | 50 | 2,00 | 6,189 |

➤ AÇIKLAMALAR / INSTRUCTIONS :

NOT: Standart uzunluk 2500mm. İsteğe bağlı olarak uzunluklar değişebilir.

! Trunking'lerde ölçü toleransı ± 3 mm.'dir.

! Belirtilen ağırlıklar kesim ağırlıktır.

! Trunking'ler, Metrik 6, 8 civata ve somun kullanımına uygundur.

NOTE: Standart Length is 2500mm. On request the Lengths can change.

! The dimension tolerance in Trunking is ± 3 mm.

! The indicated weights are the weights before fabrication.

! All the Trunkings are convenient for M8 bolt and nut usage.

TRUNKING

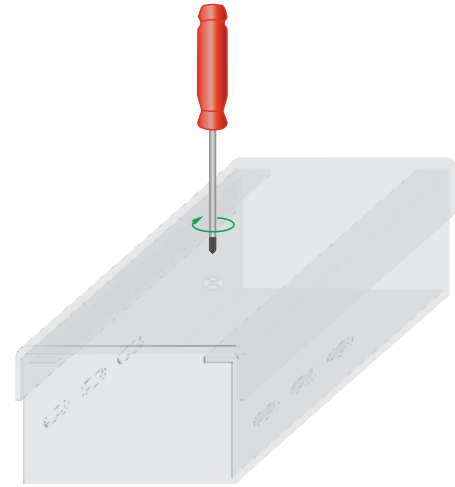
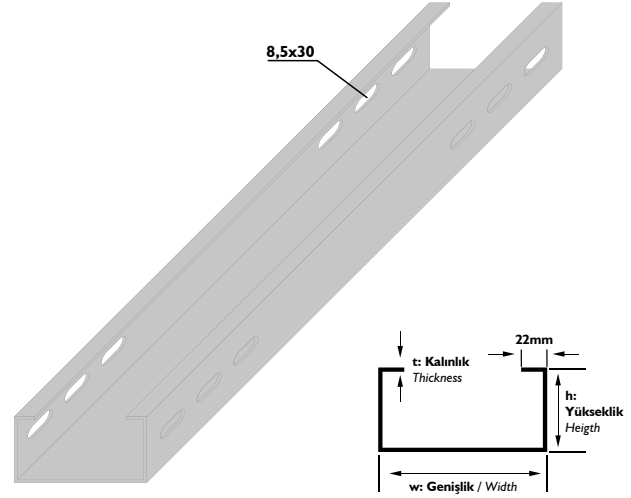

| Sipariş Kodu (Order Code) | w (mm) | h (mm) | t (mm) | L (mm) | Kg/Adet (Kg/Pcs.) |
|------------------------------|-----------|-----------|-----------|-----------|----------------------|
| AP-KNI-05.12 | 15 | 52 | 1,20 | 174 | 0,110 |

EK ELEMANI JOINT PIECE

➤ AÇIKLAMALAR / INSTRUCTIONS :

NOT: Ölçü toleransı ± 3 mm.'dir.

! Belirtilen ağırlıklar kesim ağırlıktır.

! Metrik 8 civata ve somun kullanımına uygundur.

NOTE: The dimension tolerance in perforated cable trays is ± 3 mm

! The indicated weights are the weights before fabrication.

! Convenient for M8 bolt and nut usage.

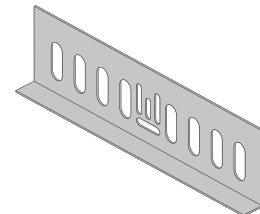
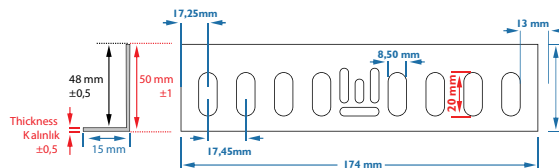

| Sipariş Kodu (Order Code) | a, b (mm) | h (mm) | t (mm) | Kg/Adet (Kg/Pcs.) |
|------------------------------|--------------|-----------|-----------|----------------------|
| AP-YDTR105/50 | 50 | 50 | 1,20 | 0,485 |
| AP-YDTR107/50 | 75 | 50 | 1,20 | 0,622 |
| AP-YDTR110/50 | 100 | 50 | 1,20 | 0,749 |
| AP-YDTR112/50 | 125 | 50 | 1,20 | 0,865 |
| AP-YDTR115/50 | 150 | 50 | 1,20 | 1,039 |
| AP-YDTR120/50 | 200 | 50 | 1,20 | 1,375 |
| AP-YDTR125/50 | 250 | 50 | 1,20 | 1,758 |
| AP-YDTR130/50 | 300 | 50 | 1,50 | 2,736 |

➤ **AÇIKLAMALAR / INSTRUCTIONS :**

NOT: Ölçü toleransı ± 3 mm.'dir.

! Belirtilen ağırlıklar kesim ağırlıktandır.

NOTE: The dimension tolerance in ± 3 mm

! The indicated weights are the weights before fabrication.

| Sipariş Kodu (Order Code) | a, b, c (mm) | h (mm) | t (mm) | Kg/Adet (Kg/Pcs.) |
|------------------------------|-----------------|-----------|-----------|----------------------|
| AP-TDTR205/50 | 50 | 50 | 1,20 | 0,624 |
| AP-TDTR207/50 | 75 | 50 | 1,20 | 0,780 |
| AP-TDTR210/50 | 100 | 50 | 1,20 | 0,898 |
| AP-TDTR212/50 | 125 | 50 | 1,20 | 1,024 |
| AP-TDTR215/50 | 150 | 50 | 1,20 | 1,214 |
| AP-TDTR220/50 | 200 | 50 | 1,20 | 1,576 |
| AP-TDTR225/50 | 250 | 50 | 1,20 | 1,986 |
| AP-TDTR230/50 | 300 | 50 | 1,50 | 3,054 |

➤ **AÇIKLAMALAR / INSTRUCTIONS :**

NOT: Ölçü toleransı ± 3 mm.'dir.

! Belirtilen ağırlıklar kesim ağırlıktandır.

NOTE: The dimension tolerance in ± 3 mm

! The indicated weights are the weights before fabrication.

| Sipariş Kodu (Order Code) | a, b, c, d (mm) | h (mm) | t (mm) | Kg/Adet (Kg/Pcs.) |
|------------------------------|--------------------|-----------|-----------|----------------------|
| AP-DDTR305/50 | 50 | 50 | 1,20 | 0,803 |
| AP-DDTR307/50 | 75 | 50 | 1,20 | 0,977 |
| AP-DDTR310/50 | 100 | 50 | 1,20 | 1,077 |
| AP-DDTR312/50 | 125 | 50 | 1,20 | 1,213 |
| AP-DDTR315/50 | 150 | 50 | 1,20 | 1,419 |
| AP-DDTR320/50 | 200 | 50 | 1,20 | 1,775 |
| AP-DDTR325/50 | 250 | 50 | 1,20 | 2,244 |
| AP-DDTR330/50 | 300 | 50 | 1,50 | 3,409 |

➤ **AÇIKLAMALAR / INSTRUCTIONS :**

NOT: Ölçü toleransı ± 3 mm.'dir.

! Belirtilen ağırlıklar kesim ağırlıktandır.

NOTE: The dimension tolerance in ± 3 mm

! The indicated weights are the weights before fabrication.

AÇIKLAMALAR / INSTRUCTIONS : Ekstra / Extra

Tüm dönüş uygulamaları, Metrik 8 civata ve somun kullanımına uygundur.
Belirtilen ağırlıklar kesim ağırlıktandır.

All the bend implementation are convenient for M8 bolt and Nut usage.
The indicated weights are the weights before fabrication.

TRUNKING 90° DÖNÜŞ ELEMANLARI
TRUNKING TYPE 90° BENDS

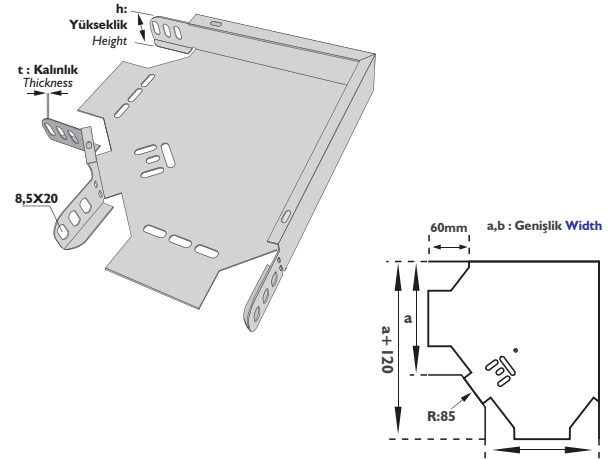

TRUNKING TİP T DÖNÜŞ ELEMANLARI
TRUNKING TYPE TEE-BRANCHES

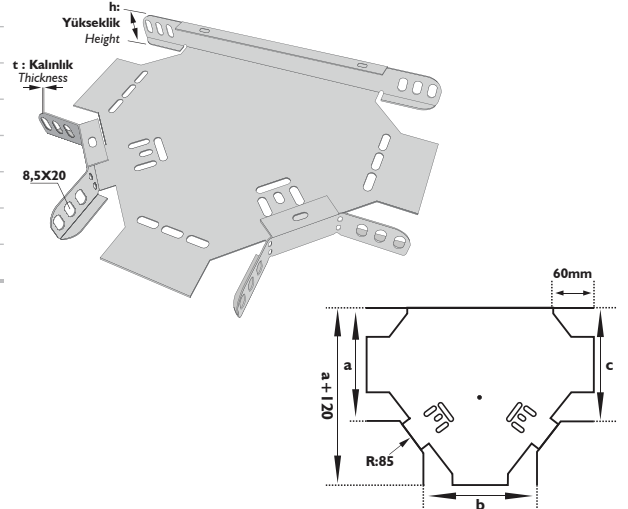

TRUNKING TİP DÖRTLÜ BAĞLANTILAR
TRUNKING TYPE CROSSINGS

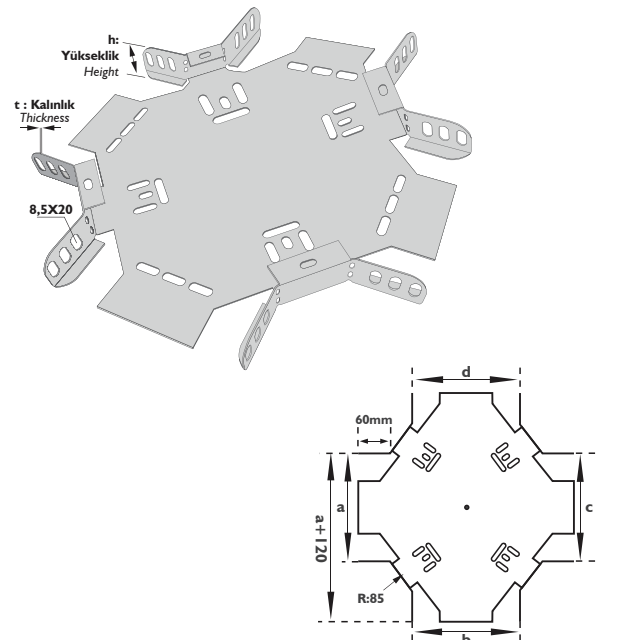

| Sipariş Kodu (Order Code) | w (mm) | h (mm) | t (mm) | Kg/Adet (Kg/Pcs.) |
|------------------------------|-----------|-----------|-----------|----------------------|
| AP-BTR505/50 | 50 | 50 | 1,20 | 1,083 |
| AP-BTR507/50 | 75 | 50 | 1,20 | 1,201 |
| AP-BTR510/50 | 100 | 50 | 1,20 | 1,319 |
| AP-BTR512/50 | 125 | 50 | 1,20 | 1,437 |
| AP-BTR515/50 | 150 | 50 | 1,20 | 1,554 |
| AP-BTR520/50 | 200 | 50 | 1,20 | 1,790 |
| AP-BTR525/50 | 250 | 50 | 1,20 | 2,025 |
| AP-BTR530/50 | 300 | 50 | 1,20 | 2,261 |

➤ AÇIKLAMALAR / INSTRUCTIONS :

NOT: Ölçü toleransı ± 3 mm.'dir.

! Belirtilen ağırlıklar kesim ağırlığıdır.

NOTE: The dimension tolerance in ± 3 mm

! The indicated weights are the weights before fabrication.

| Sipariş Kodu (Order Code) | w (mm) | h (mm) | t (mm) | Kg/Adet (Kg/Pcs.) |
|------------------------------|-----------|-----------|-----------|----------------------|
| AP-BTR605/50 | 50 | 50 | 1,20 | 1,036 |
| AP-BTR607/50 | 75 | 50 | 1,20 | 1,130 |
| AP-BTR610/50 | 100 | 50 | 1,20 | 1,225 |
| AP-BTR612/50 | 125 | 50 | 1,20 | 1,319 |
| AP-BTR615/50 | 150 | 50 | 1,20 | 1,413 |
| AP-BTR620/50 | 200 | 50 | 1,20 | 1,601 |
| AP-BTR625/50 | 250 | 50 | 1,20 | 1,790 |
| AP-BTR630/50 | 300 | 50 | 1,20 | 1,978 |

➤ AÇIKLAMALAR / INSTRUCTIONS :

NOT: Ölçü toleransı ± 3 mm.'dir.

! Belirtilen ağırlıklar kesim ağırlığıdır.

NOTE: The dimension tolerance in ± 3 mm

! The indicated weights are the weights before fabrication.

| Sipariş Kodu (Order Code) | w (mm) | h (mm) | t (mm) | Kg/Adet (Kg/Pcs.) |
|------------------------------|-----------|-----------|-----------|----------------------|
| AP-TRS05/50 | 45 | 50 | 1,20 | 0,078 |
| AP-TRS07/50 | 70 | 50 | 1,20 | 0,089 |
| AP-TRS10/50 | 95 | 50 | 1,20 | 0,101 |
| AP-TRS12/50 | 120 | 50 | 1,20 | 0,113 |
| AP-TRS15/50 | 145 | 50 | 1,20 | 0,125 |
| AP-TRS20/50 | 195 | 50 | 1,20 | 0,148 |
| AP-TRS25/50 | 245 | 50 | 1,20 | 0,172 |
| AP-TRS30/50 | 295 | 50 | 1,20 | 0,195 |

➤ AÇIKLAMALAR / INSTRUCTIONS :

NOT: Ölçü toleransı ± 3 mm.'dir.

! Belirtilen ağırlıklar kesim ağırlığıdır.

NOTE: The dimension tolerance in ± 3 mm

! The indicated weights are the weights before fabrication.

TRUNKING İÇ BÜKEY DÖNÜŞ ELEMANLARI
TRUNKING INTERNAL BEND ELEMENTS

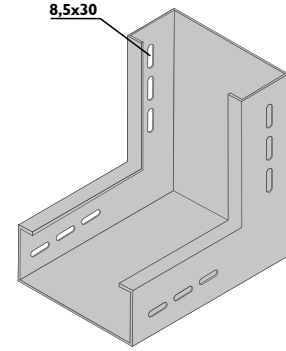
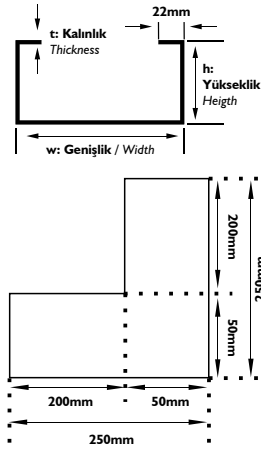

TRUNKING DIŞ BÜKEY DÖNÜŞ ELEMANLARI
TRUNKING EXTERNAL BEND ELEMENTS

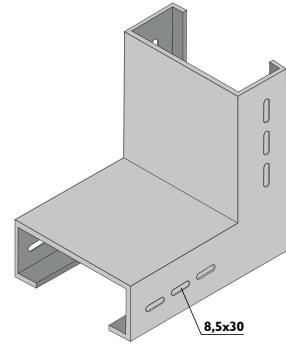
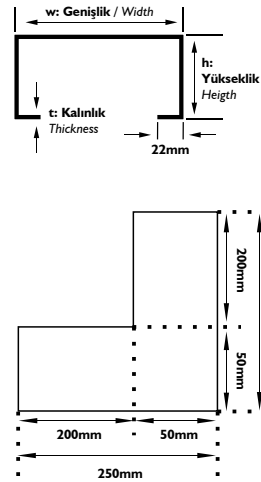

SONLANDIRMA
END CAP

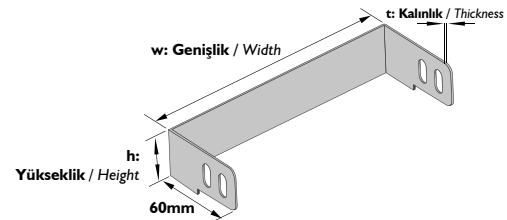

| Sipariş Kodu (Order Code) | w (mm) | h (mm) | t (mm) | Kg/Takım (Kg/Set) |
|------------------------------|-----------|-----------|-----------|----------------------|
| AP-TRZI-25 | 25 | 50 | 1,50 | 0,189 |
| AP-TRZI-50 | 50 | 50 | 1,50 | 0,204 |
| AP-TRZI-75 | 75 | 50 | 1,50 | 0,219 |
| AP-TRZI-100 | 100 | 50 | 1,50 | 0,237 |
| AP-TRZI-125 | 125 | 50 | 1,50 | 0,248 |
| AP-TRZI-150 | 150 | 50 | 1,50 | 0,263 |
| AP-TRZI-175 | 175 | 50 | 1,50 | 0,278 |
| AP-TRZI-200 | 200 | 50 | 1,50 | 0,293 |
| AP-TRZI-225 | 225 | 50 | 1,50 | 0,307 |
| AP-TRZI-250 | 250 | 50 | 1,50 | 0,322 |

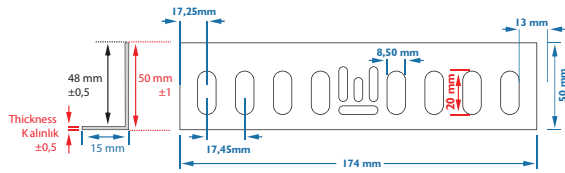

SOLA / LEFT

Z TİPİ REDÜKSİYONLAR SOLA
Z TYPE REDUCERS LEFT

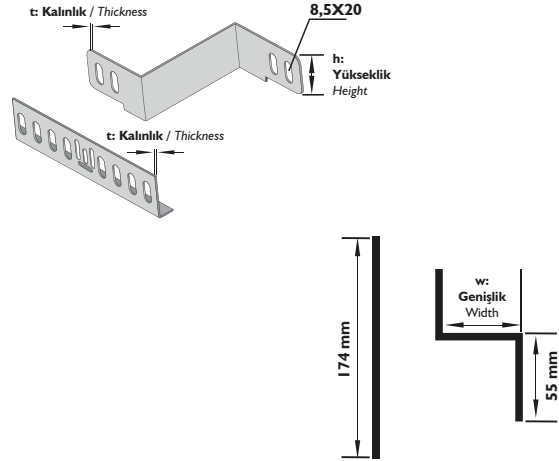

| Sipariş Kodu (Order Code) | w (mm) | h (mm) | t (mm) | Kg/Takım (Kg/Set) |
|------------------------------|-----------|-----------|-----------|----------------------|
| AP-TRZI-25 | 25 | 50 | 1,50 | 0,189 |
| AP-TRZI-50 | 50 | 50 | 1,50 | 0,204 |
| AP-TRZI-75 | 75 | 50 | 1,50 | 0,219 |
| AP-TRZI-100 | 100 | 50 | 1,50 | 0,237 |
| AP-TRZI-125 | 125 | 50 | 1,50 | 0,248 |
| AP-TRZI-150 | 150 | 50 | 1,50 | 0,263 |
| AP-TRZI-175 | 175 | 50 | 1,50 | 0,278 |
| AP-TRZI-200 | 200 | 50 | 1,50 | 0,293 |
| AP-TRZI-225 | 225 | 50 | 1,50 | 0,307 |
| AP-TRZI-250 | 250 | 50 | 1,50 | 0,322 |

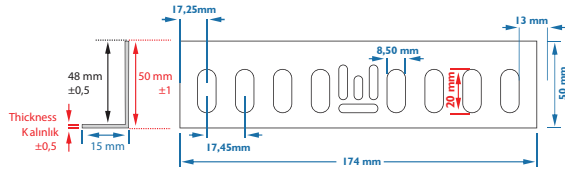

SAĞA / RIGHT

Z TİPİ REDÜKSİYONLAR SAĞA
Z TYPE REDUCERS RIGHT

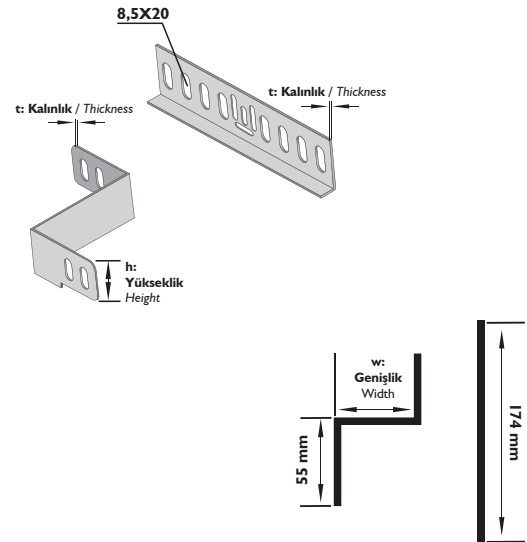

| Sipariş Kodu (Order Code) | w (mm) | h (mm) | t (mm) | Kg/Takım (Kg/Set) |
|------------------------------|-----------|-----------|-----------|----------------------|
| AP-TRZ2-12 | 12 | 50 | 1,50 | 0,144 |
| AP-TRZ2-25 | 25 | 50 | 1,50 | 0,159 |
| AP-TRZ2-50 | 50 | 50 | 1,50 | 0,188 |
| AP-TRZ2-75 | 75 | 50 | 1,50 | 0,218 |
| AP-TRZ2-100 | 100 | 50 | 1,50 | 0,247 |
| AP-TRZ2-125 | 125 | 50 | 1,50 | 0,277 |
| AP-TRZ2-137 | 150 | 50 | 1,50 | 0,291 |

ORTADAN / CENTER

Z TİPİ REDÜKSİYONLAR ORTADAN
Z TYPE REDUCERS CENTER

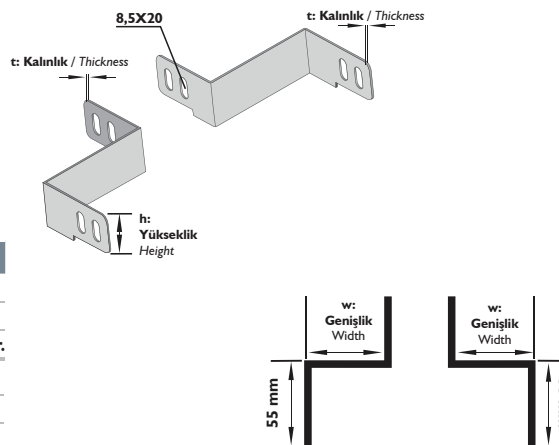

► AÇIKLAMALAR / INSTRUCTIONS :

NOT: Lütfen siparişlerinizde redüksiyon tipini ve "w" ölçüsünü belirtiniz.

! Özel ölçüler için lütfen Örmamız ile irtibata geçiniz.

! Metrik 8 civata ve somun kullanımına uygundur. Belirtilen ağırlıklar kesim ağırlıklarıdır.

NOTE: Please assert the reduction type and "w" dimension.

! For special dimensions please contact our Örm

! M8 bolt and Nut usage. The indicated weights are the weights before fabrication.

| Sipariş Kodu (Order Code) | w (mm) | h (mm) | t (mm) | Kg/Mt (Kg/Mt) |
|------------------------------|-----------|-----------|-----------|------------------|
| AP-TR07.10/75 | 75 | 75 | 1,00 | 2,065 |
| AP-TR07.12/75 | 75 | 75 | 1,20 | 2,477 |
| AP-TR07.15/75 | 75 | 75 | 1,50 | 3,097 |
| AP-TR07.20/75 | 75 | 75 | 2,00 | 3,716 |
| AP-TR10.10/75 | 100 | 75 | 1,00 | 2,261 |
| AP-TR10.12/75 | 100 | 75 | 1,20 | 2,713 |
| AP-TR10.15/75 | 100 | 75 | 1,50 | 3,391 |
| AP-TR10.20/75 | 100 | 75 | 2,00 | 4,069 |
| AP-TR12.10/75 | 125 | 75 | 1,00 | 2,457 |
| AP-TR12.12/75 | 125 | 75 | 1,20 | 2,948 |
| AP-TR12.15/75 | 125 | 75 | 1,50 | 3,686 |
| AP-TR12.20/75 | 125 | 75 | 2,00 | 4,423 |
| AP-TR15.10/75 | 150 | 75 | 1,00 | 2,653 |
| AP-TR15.12/75 | 150 | 75 | 1,20 | 3,184 |
| AP-TR15.15/75 | 150 | 75 | 1,50 | 3,980 |
| AP-TR15.20/75 | 150 | 75 | 2,00 | 4,776 |
| AP-TR20.10/75 | 200 | 75 | 1,00 | 3,046 |
| AP-TR20.12/75 | 200 | 75 | 1,20 | 3,655 |
| AP-TR20.15/75 | 200 | 75 | 1,50 | 4,569 |
| AP-TR20.20/75 | 200 | 75 | 2,00 | 5,482 |
| AP-TR25.12/75 | 250 | 75 | 1,20 | 4,126 |
| AP-TR25.15/75 | 250 | 75 | 1,50 | 5,157 |
| AP-TR25.20/75 | 250 | 75 | 2,00 | 6,189 |
| AP-TR30.12/75 | 300 | 75 | 1,20 | 4,597 |
| AP-TR30.15/75 | 300 | 75 | 1,50 | 5,746 |
| AP-TR30.20/75 | 300 | 75 | 2,00 | 6,895 |

TRUNKING

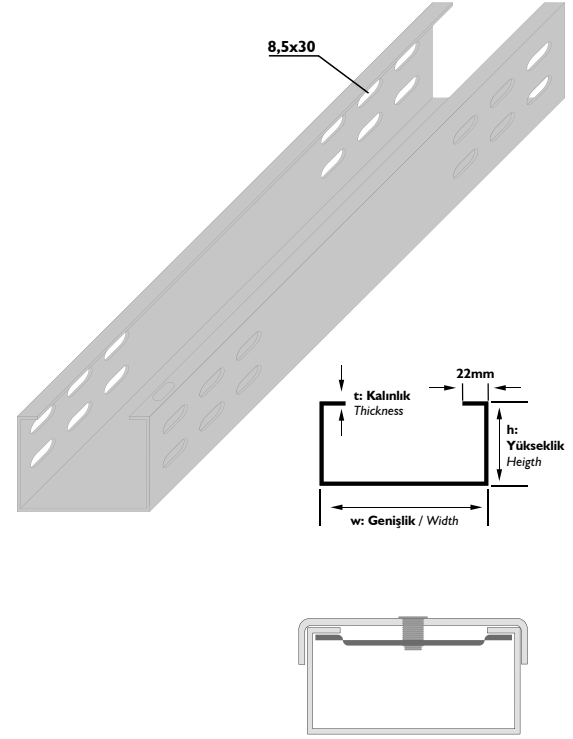

AÇIKLAMALAR / INSTRUCTIONS :

NOT: Standart uzunluk 2500mm. İsteğe bağlı olarak uzunluklar değişebilir.

! Trunking'lerde ölçü toleransı ± 3 mm.'dir.

! Belirtilen ağırlıklar kesim ağırlıklarıdır.

! Trunking'ler, Metrik 6, 8 cıvata ve somun kullanımına uygundur.

NOTE: Standart Length is 2500mm. On request the Lengths can change.

! The dimension tolerance in Trunking is ± 3 mm.

! The indicated weights are the weights before fabrication.

! All the Trunkings are convenient for M8 bolt and nut usage.

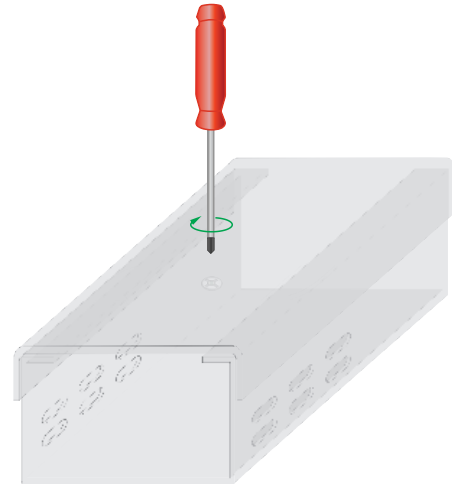

| Sipariş Kodu (Order Code) | w (mm) | h (mm) | t (mm) | L (mm) | Kg/Adet (Kg/Pcs.) |
|------------------------------|-----------|-----------|-----------|-----------|----------------------|
| AP-KNI-07.12 | 15 | 75 | 1,20 | 174 | 0,148 |

EK ELEMANI
JOINT PIECE

AÇIKLAMALAR / INSTRUCTIONS :

NOT: Ölçü toleransı ± 3 mm.'dir.

! Belirtilen ağırlıklar kesim ağırlıklarıdır.

! Metrik 8 cıvata ve somun kullanımına uygundur.

NOTE: The dimension tolerance in perforated cable trays is ± 3 mm

! The indicated weights are the weights before fabrication.

! Convenient for M8 bolt and nut usage.

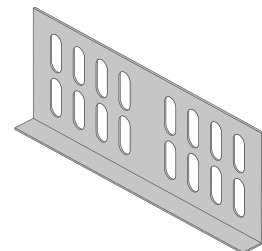
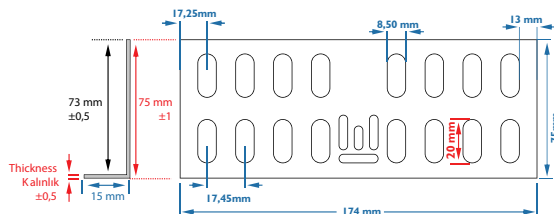

| Sipariş Kodu (Order Code) | a, b (mm) | h (mm) | t (mm) | Kg/Adet (Kg/Pcs.) |
|------------------------------|--------------|-----------|-----------|----------------------|
| AP-YDTR107/75 | 75 | 75 | 1,20 | 1,082 |
| AP-YDTR110/75 | 100 | 75 | 1,20 | 1,204 |
| AP-YDTR112/75 | 125 | 75 | 1,20 | 1,337 |
| AP-YDTR115/75 | 150 | 75 | 1,20 | 1,482 |
| AP-YDTR120/75 | 200 | 75 | 1,20 | 1,808 |
| AP-YDTR125/75 | 250 | 75 | 1,20 | 2,181 |
| AP-YDTR130/75 | 300 | 75 | 1,50 | 3,252 |

➤ **AÇIKLAMALAR / INSTRUCTIONS :**

NOT: Ölçü toleransı ± 3 mm.'dir.

! Belirtilen ağırlıklar kesim ağırlıklarıdır.

NOTE: The dimension tolerance in ± 3 mm

! The indicated weights are the weights before fabrication.

| Sipariş Kodu (Order Code) | a, b, c (mm) | h (mm) | t (mm) | Kg/Adet (Kg/Pcs.) |
|------------------------------|-----------------|-----------|-----------|----------------------|
| AP-TDTR207/75 | 75 | 75 | 1,20 | 1,420 |
| AP-TDTR210/75 | 100 | 75 | 1,20 | 1,525 |
| AP-TDTR212/75 | 125 | 75 | 1,20 | 1,642 |
| AP-TDTR215/75 | 150 | 75 | 1,20 | 1,770 |
| AP-TDTR220/75 | 200 | 75 | 1,20 | 2,063 |
| AP-TDTR225/75 | 250 | 75 | 1,20 | 2,402 |
| AP-TDTR230/75 | 300 | 75 | 1,50 | 3,486 |

➤ **AÇIKLAMALAR / INSTRUCTIONS :**

NOT: Ölçü toleransı ± 3 mm.'dir.

! Belirtilen ağırlıklar kesim ağırlıklarıdır.

NOTE: The dimension tolerance in ± 3 mm

! The indicated weights are the weights before fabrication.

| Sipariş Kodu (Order Code) | a, b, c, d (mm) | h (mm) | t (mm) | Kg/Adet (Kg/Pcs.) |
|------------------------------|--------------------|-----------|-----------|----------------------|
| AP-DDTR307/75 | 75 | 75 | 1,20 | 1,665 |
| AP-DDTR310/75 | 100 | 75 | 1,20 | 1,742 |
| AP-DDTR312/75 | 125 | 75 | 1,20 | 1,830 |
| AP-DDTR315/75 | 150 | 75 | 1,20 | 1,930 |
| AP-DDTR320/75 | 200 | 75 | 1,20 | 2,165 |
| AP-DDTR325/75 | 250 | 75 | 1,20 | 2,448 |
| AP-DDTR330/75 | 300 | 75 | 1,50 | 3,472 |

➤ **AÇIKLAMALAR / INSTRUCTIONS :**

NOT: Ölçü toleransı ± 3 mm.'dir.

! Belirtilen ağırlıklar kesim ağırlıklarıdır.

NOTE: The dimension tolerance in ± 3 mm

! The indicated weights are the weights before fabrication.

AÇIKLAMALAR / INSTRUCTIONS : Ekstra / Extra

Tüm dönüş uygulamaları, Metrik 8 civata ve somun kullanımına uygundur.
Belirtilen ağırlıklar kesim ağırlıklarıdır.

All the bend implementation are convenient for M8 bolt and Nut usage.
The indicated weights are the weights before fabrication.

TRUNKING 90° DÖNÜŞ ELEMANLARI
TRUNKING TYPE 90° BENDS

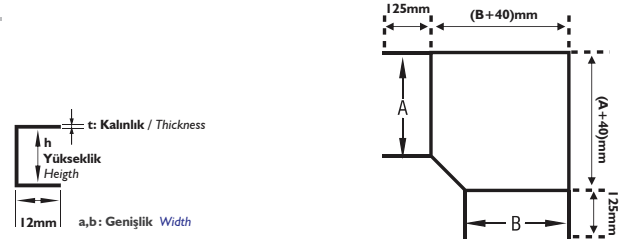
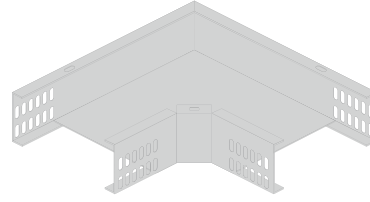

TRUNKING TİP T DÖNÜŞ ELEMANLARI
TRUNKING TYPE TEE-BRANCHES

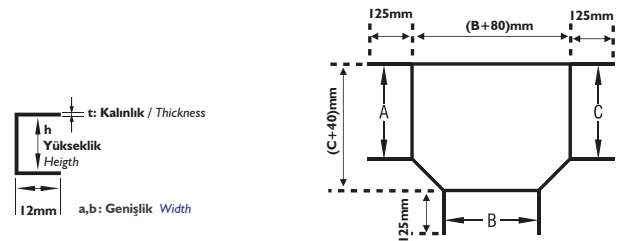
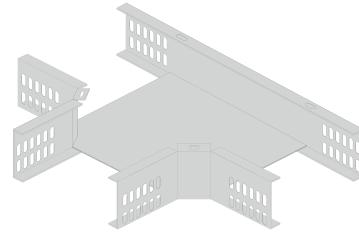

TRUNKING TİP DÖRTLÜ BAĞLANTILAR
TRUNKING TYPE CROSSINGS

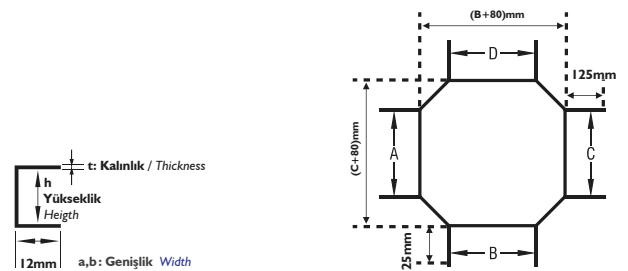
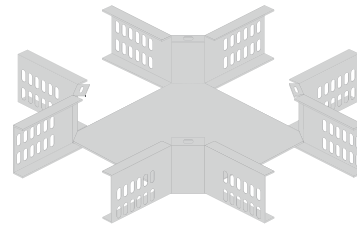

| Sipariş Kodu (Order Code) | w (mm) | h (mm) | t (mm) | Kg/Adet (Kg/Pcs.) |
|------------------------------|-----------|-----------|-----------|----------------------|
| AP-BTR507/75 | 75 | 75 | 1,20 | 1,437 |
| AP-BTR510/75 | 100 | 75 | 1,20 | 1,554 |
| AP-BTR512/75 | 125 | 75 | 1,20 | 1,672 |
| AP-BTR515/75 | 150 | 75 | 1,20 | 1,790 |
| AP-BTR520/75 | 200 | 75 | 1,20 | 2,025 |
| AP-BTR525/75 | 250 | 75 | 1,20 | 2,261 |
| AP-BTR530/75 | 300 | 75 | 1,20 | 2,496 |

➤ AÇIKLAMALAR / INSTRUCTIONS :

NOT: Ölçü toleransı ± 3 mm.'dir.

! Belirtilen ağırlıklar kesim ağırlıklarıdır.

NOTE: The dimension tolerance in ± 3 mm

! The indicated weights are the weights before fabrication.

| Sipariş Kodu (Order Code) | w (mm) | h (mm) | t (mm) | Kg/Adet (Kg/Pcs.) |
|------------------------------|-----------|-----------|-----------|----------------------|
| AP-BTR607/75 | 75 | 75 | 1,20 | 1,366 |
| AP-BTR610/75 | 100 | 75 | 1,20 | 1,460 |
| AP-BTR612/75 | 125 | 75 | 1,20 | 1,554 |
| AP-BTR615/75 | 150 | 75 | 1,20 | 1,649 |
| AP-BTR620/75 | 200 | 75 | 1,20 | 1,837 |
| AP-BTR625/75 | 250 | 75 | 1,20 | 2,025 |
| AP-BTR630/75 | 300 | 75 | 1,20 | 2,214 |

➤ AÇIKLAMALAR / INSTRUCTIONS :

NOT: Ölçü toleransı ± 3 mm.'dir.

! Belirtilen ağırlıklar kesim ağırlıklarıdır.

NOTE: The dimension tolerance in ± 3 mm

! The indicated weights are the weights before fabrication.

| Sipariş Kodu (Order Code) | w (mm) | h (mm) | t (mm) | Kg/Adet (Kg/Pcs.) |
|------------------------------|-----------|-----------|-----------|----------------------|
| AP-TRS07/75 | 70 | 75 | 1,20 | 0,134 |
| AP-TRS10/75 | 95 | 75 | 1,20 | 0,152 |
| AP-TRS12/75 | 120 | 75 | 1,20 | 0,170 |
| AP-TRS15/75 | 145 | 75 | 1,20 | 0,187 |
| AP-TRS20/75 | 195 | 75 | 1,20 | 0,223 |
| AP-TRS25/75 | 245 | 75 | 1,20 | 0,258 |
| AP-TRS30/75 | 295 | 75 | 1,20 | 0,293 |

➤ AÇIKLAMALAR / INSTRUCTIONS :

NOT: Ölçü toleransı ± 3 mm.'dir.

! Belirtilen ağırlıklar kesim ağırlıklarıdır.

NOTE: The dimension tolerance in ± 3 mm

! The indicated weights are the weights before fabrication.

TRUNKING İÇ BÜKEY DÖNÜŞ ELEMANLARI
TRUNKING INTERNAL BEND ELEMENTS

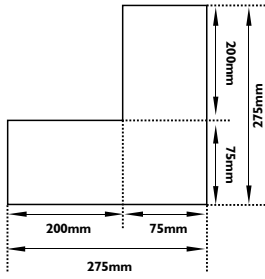
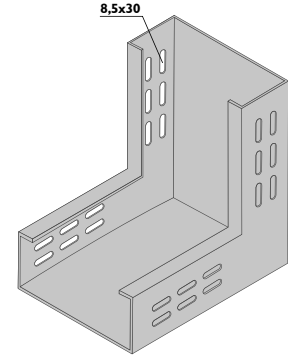
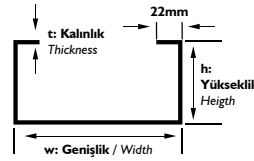

TRUNKING DIŞ BÜKEY DÖNÜŞ ELEMANLARI
TRUNKING EXTERNAL BEND ELEMENTS

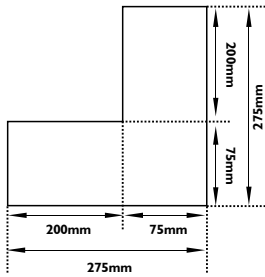
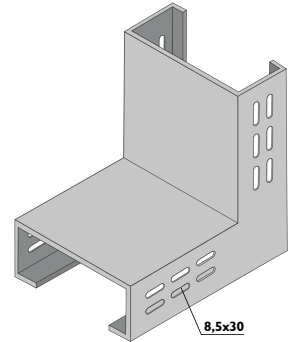
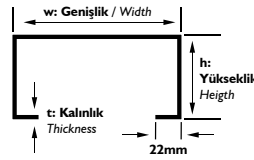

SONLANDIRMA
END CAP

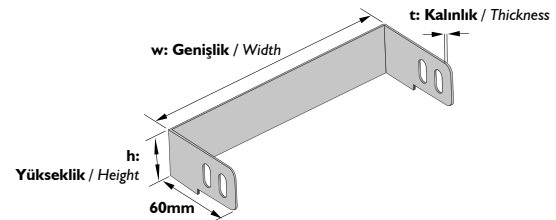

| Sipariş Kodu (Order Code) | w (mm) | h (mm) | t (mm) | Kg/Takım (Kg/Set) |
|------------------------------|-----------|-----------|-----------|----------------------|
| AP-TRZHI-25 | 25 | 75 | 1,50 | 0,267 |
| AP-TRZHI-50 | 50 | 75 | 1,50 | 0,289 |
| AP-TRZHI-75 | 75 | 75 | 1,50 | 0,311 |
| AP-TRZHI-100 | 100 | 75 | 1,50 | 0,338 |
| AP-TRZHI-125 | 125 | 75 | 1,50 | 0,356 |
| AP-TRZHI-150 | 150 | 75 | 1,50 | 0,378 |
| AP-TRZHI-175 | 175 | 75 | 1,50 | 0,400 |
| AP-TRZHI-200 | 200 | 75 | 1,50 | 0,422 |
| AP-TRZHI-225 | 225 | 75 | 1,50 | 0,444 |
| AP-TRZHI-250 | 250 | 75 | 1,50 | 0,466 |

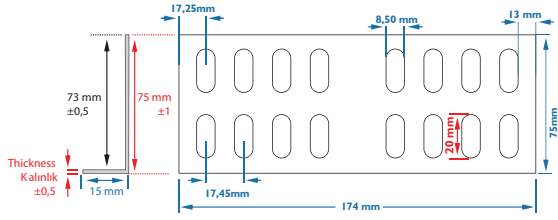

SOLA / LEFT

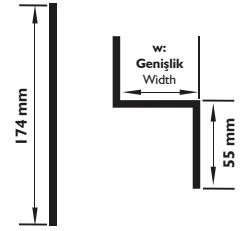
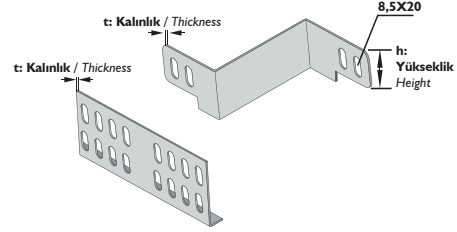
Z TİPİ REDÜKSİYONLAR SOLA
Z TYPE REDUCERS LEFT

| Sipariş Kodu (Order Code) | w (mm) | h (mm) | t (mm) | Kg/Takım (Kg/Set) |
|------------------------------|-----------|-----------|-----------|----------------------|
| AP-TRZHI-25 | 25 | 75 | 1,50 | 0,267 |
| AP-TRZHI-50 | 50 | 75 | 1,50 | 0,289 |
| AP-TRZHI-75 | 75 | 75 | 1,50 | 0,311 |
| AP-TRZHI-100 | 100 | 75 | 1,50 | 0,338 |
| AP-TRZHI-125 | 125 | 75 | 1,50 | 0,356 |
| AP-TRZHI-150 | 150 | 75 | 1,50 | 0,378 |
| AP-TRZHI-175 | 175 | 75 | 1,50 | 0,400 |
| AP-TRZHI-200 | 200 | 75 | 1,50 | 0,422 |
| AP-TRZHI-225 | 225 | 75 | 1,50 | 0,444 |
| AP-TRZHI-250 | 250 | 75 | 1,50 | 0,466 |

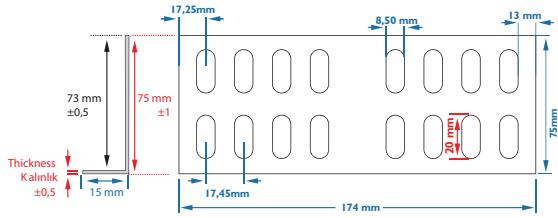

SAĞA / RIGHT

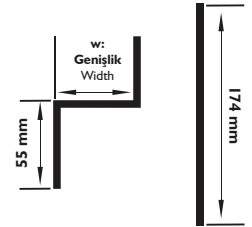
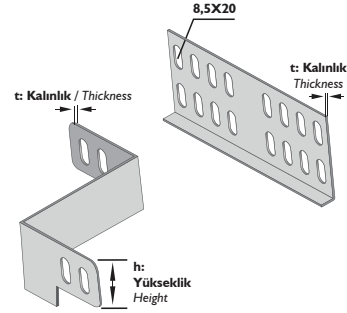
Z TİPİ REDÜKSİYONLAR SAĞA
Z TYPE REDUCERS RIGHT

| Sipariş Kodu (Order Code) | w (mm) | h (mm) | t (mm) | Kg/Takım (Kg/Set) |
|------------------------------|-----------|-----------|-----------|----------------------|
| AP-TRZH2-12 | 12 | 75 | 1,50 | 0,216 |
| AP-TRZH2-25 | 25 | 75 | 1,50 | 0,238 |
| AP-TRZH2-50 | 50 | 75 | 1,50 | 0,283 |
| AP-TRZH2-75 | 75 | 75 | 1,50 | 0,327 |
| AP-TRZH2-100 | 100 | 75 | 1,50 | 0,371 |
| AP-TRZH2-125 | 125 | 75 | 1,50 | 0,415 |
| AP-TRZH2-137 | 150 | 75 | 1,50 | 0,437 |

ORTADAN / CENTER

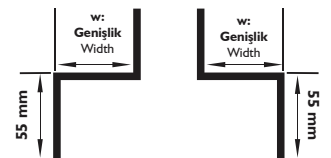
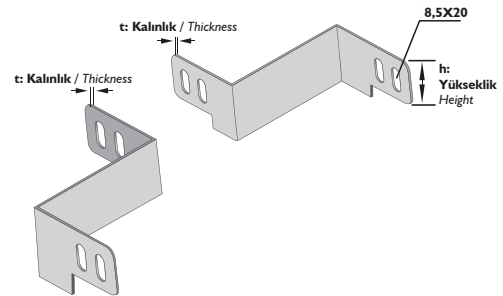
Z TİPİ REDÜKSİYONLAR ORTADAN
Z TYPE REDUCERS CENTER

AÇIKLAMALAR / INSTRUCTIONS :
NOT: Lütfen siparişlerinizde redüksiyon tipini ve "w" ölçüsünü belirtiniz.

! Özel ölçüler için lütfen Örmamız ile irtibata geçiniz.

! Metrik 8 civata ve somun kullanımına uygundur. Belirtilen ağırlıklar kesim ağırlıklarıdır.

NOTE: Please assert the reduction type and "w" dimension.

! For special dimensions please contact our Örm

! M8 bolt and Nut usage. The indicated weights are the weights before fabrication.

| Sipariş Kodu (Order Code) | w (mm) | h (mm) | t (mm) | Kg/Mt (Kg/Mt) |
|------------------------------|-----------|-----------|-----------|------------------|
| AP-TR10.12/100 | 100 | 100 | 1,20 | 3,184 |
| AP-TR10.15/100 | 100 | 100 | 1,50 | 3,980 |
| AP-TR10.20/100 | 100 | 100 | 2,00 | 4,776 |
| AP-TR12.12/100 | 125 | 100 | 1,20 | 3,419 |
| AP-TR12.15/100 | 125 | 100 | 1,50 | 4,274 |
| AP-TR12.20/100 | 125 | 100 | 2,00 | 5,129 |
| AP-TR15.12/100 | 150 | 100 | 1,20 | 3,655 |
| AP-TR15.15/100 | 150 | 100 | 1,50 | 4,569 |
| AP-TR15.20/100 | 150 | 100 | 2,00 | 5,482 |
| AP-TR20.12/100 | 200 | 100 | 1,20 | 4,126 |
| AP-TR20.15/100 | 200 | 100 | 1,50 | 5,157 |
| AP-TR20.20/100 | 200 | 100 | 2,00 | 6,189 |
| AP-TR25.12/100 | 250 | 100 | 1,20 | 4,597 |
| AP-TR25.15/100 | 250 | 100 | 1,50 | 5,746 |
| AP-TR25.20/100 | 250 | 100 | 2,00 | 6,895 |
| AP-TR30.12/100 | 300 | 100 | 1,20 | 5,068 |
| AP-TR30.15/100 | 300 | 100 | 1,50 | 6,335 |
| AP-TR30.20/100 | 300 | 100 | 2,00 | 7,602 |

TRUNKING

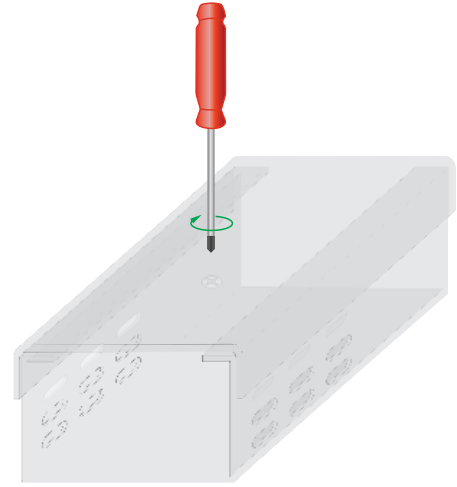
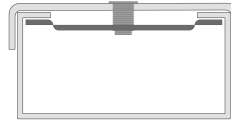
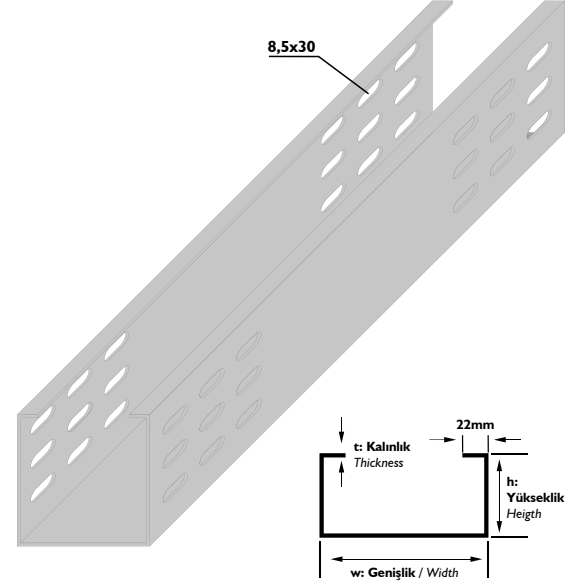

AÇIKLAMALAR / INSTRUCTIONS :

NOT: Standart uzunluk 2500mm. İsteğe bağlı olarak uzunluklar değişebilir.

! Trunking'lerde ölçü toleransı ± 3 mm.'dir.

! Belirtilen ağırlıklar kesim ağırlıklarıdır.

! Trunking'ler, Metrik 6, 8 çvata ve somun kullanımına uygundur.

NOTE: Standart Length is 2500mm. On request the Lengths can change.

! The dimension tolerance in Trunking is ± 3 mm.

! The indicated weights are the weights before fabrication.

! All the Trunkings are convenient for M8 bolt and nut usage.

| Sipariş Kodu (Order Code) | w (mm) | h (mm) | t (mm) | L (mm) | Kg/Adet (Kg/Pcs.) |
|------------------------------|-----------|-----------|-----------|-----------|----------------------|
| AP-AI-10.12 | 15 | 102 | 1,20 | 174 | 0,191 |

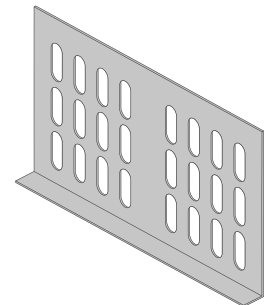
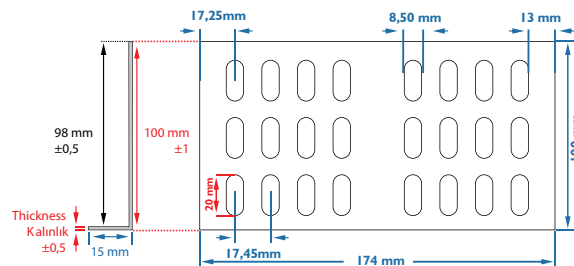
EK ELEMANI
JOINT PIECE

AÇIKLAMALAR / INSTRUCTIONS :

NOT: Ölçü toleransı ± 3 mm.'dir.

! Belirtilen ağırlıklar kesim ağırlıklarıdır.

! Metrik 8 çvata ve somun kullanımına uygundur.

NOTE: The dimension tolerance in perforated cable trays is ± 3 mm

! The indicated weights are the weights before fabrication.

! Convenient for M8 bolt and nut usage.

| Sipariş Kodu (Order Code) | a, b (mm) | h (mm) | t (mm) | Kg/Adet (Kg/Pcs.) |
|------------------------------|--------------|-----------|-----------|----------------------|
| AP-YDTR110/100 | 100 | 100 | 1,20 | 1,408 |
| AP-YDTR112/100 | 125 | 100 | 1,20 | 1,554 |
| AP-YDTR115/100 | 150 | 100 | 1,20 | 1,711 |
| AP-YDTR120/100 | 200 | 100 | 1,20 | 2,060 |
| AP-YDTR125/100 | 250 | 100 | 1,20 | 2,457 |
| AP-YDTR130/100 | 300 | 100 | 1,50 | 3,626 |

► AÇIKLAMALAR / INSTRUCTIONS :
NOT: Ölçü toleransı ± 3 mm.'dir.

! Belirtilen ağırlıklar kesim ağırlıktır.

NOTE: The dimension tolerance in ± 3 mm

! The indicated weights are the weights before fabrication.

| Sipariş Kodu (Order Code) | a, b, c (mm) | h (mm) | t (mm) | Kg/Adet (Kg/Pcs.) |
|------------------------------|-----------------|-----------|-----------|----------------------|
| AP-TDTR210/100 | 100 | 100 | 1,20 | 1,782 |
| AP-TDTR212/100 | 125 | 100 | 1,20 | 1,904 |
| AP-TDTR215/100 | 150 | 100 | 1,20 | 2,039 |
| AP-TDTR220/100 | 200 | 100 | 1,20 | 2,343 |
| AP-TDTR225/100 | 250 | 100 | 1,20 | 2,694 |
| AP-TDTR230/100 | 300 | 100 | 1,50 | 3,866 |

► AÇIKLAMALAR / INSTRUCTIONS :
NOT: Ölçü toleransı ± 3 mm.'dir.

! Belirtilen ağırlıklar kesim ağırlıktır.

NOTE: The dimension tolerance in ± 3 mm

! The indicated weights are the weights before fabrication.

| Sipariş Kodu (Order Code) | a, b, c, d (mm) | h (mm) | t (mm) | Kg/Adet (Kg/Pcs.) |
|------------------------------|--------------------|-----------|-----------|----------------------|
| AP-DDTR310/100 | 100 | 100 | 1,20 | 2,043 |
| AP-DDTR312/100 | 125 | 100 | 1,20 | 2,131 |
| AP-DDTR315/100 | 150 | 100 | 1,20 | 2,231 |
| AP-DDTR320/100 | 200 | 100 | 1,20 | 2,467 |
| AP-DDTR325/100 | 250 | 100 | 1,20 | 2,750 |
| AP-DDTR330/100 | 300 | 100 | 1,50 | 3,849 |

► AÇIKLAMALAR / INSTRUCTIONS :
NOT: Ölçü toleransı ± 3 mm.'dir.

! Belirtilen ağırlıklar kesim ağırlıktır.

NOTE: The dimension tolerance in ± 3 mm

! The indicated weights are the weights before fabrication.

AÇIKLAMALAR / INSTRUCTIONS : Ekstra / Extra

 Tüm dönüş uygulamaları, Metrik 8 civata ve somun kullanımına uygundur.
 Belirtilen ağırlıklar kesim ağırlıktır.

 All the bend implementation are convenient for M8 bolt and Nut usage.
 The indicated weights are the weights before fabrication.

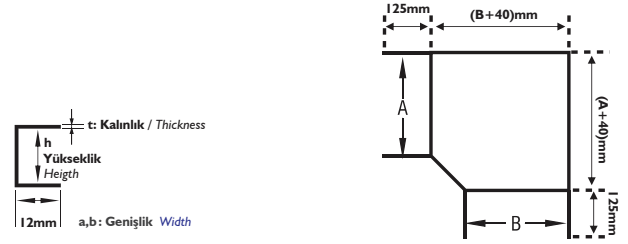
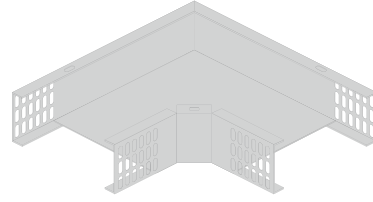
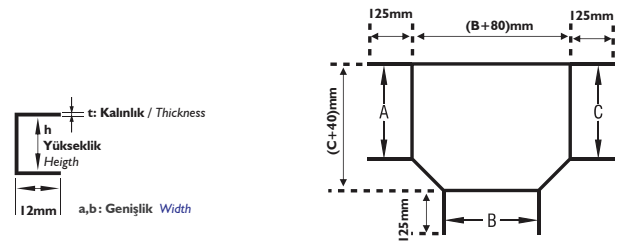
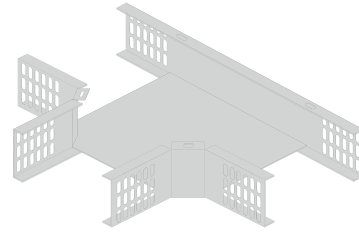
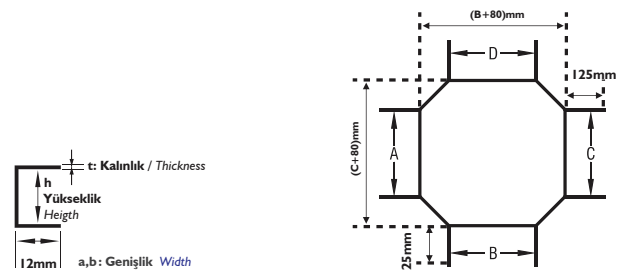
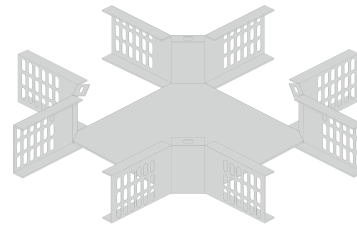
TRUNKING 90° DÖNÜŞ ELEMANLARI
TRUNKING TYPE 90° BENDS

TRUNKING TİP T DÖNÜŞ ELEMANLARI
TRUNKING TYPE TEE-BRANCHES

TRUNKING TİP DÖRTLÜ BAĞLANTILAR
TRUNKING TYPE CROSSINGS

| Sipariş Kodu (Order Code) | w (mm) | h (mm) | t (mm) | Kg/Adet (Kg/Pcs.) |
|------------------------------|-----------|-----------|-----------|----------------------|
| AP-BTR510/100 | 100 | 100 | 1,20 | 1,790 |
| AP-BTR512/100 | 125 | 100 | 1,20 | 1,908 |
| AP-BTR515/100 | 150 | 100 | 1,20 | 2,025 |
| AP-BTR520/100 | 200 | 100 | 1,20 | 2,261 |
| AP-BTR525/100 | 250 | 100 | 1,20 | 2,496 |
| AP-BTR530/100 | 300 | 100 | 1,20 | 2,732 |

➤ AÇIKLAMALAR / INSTRUCTIONS :

NOT: Ölçü toleransı ± 3 mm.'dir.

! Belirtilen ağırlıklar kesim ağırlıktır.

NOTE: The dimension tolerance in ± 3 mm

! The indicated weights are the weights before fabrication.

| Sipariş Kodu (Order Code) | w (mm) | h (mm) | t (mm) | Kg/Adet (Kg/Pcs.) |
|------------------------------|-----------|-----------|-----------|----------------------|
| AP-BTR610/100 | 100 | 100 | 1,20 | 1,696 |
| AP-BTR612/100 | 125 | 100 | 1,20 | 1,790 |
| AP-BTR615/100 | 150 | 100 | 1,20 | 1,884 |
| AP-BTR620/100 | 200 | 100 | 1,20 | 2,072 |
| AP-BTR625/100 | 250 | 100 | 1,20 | 2,261 |
| AP-BTR630/100 | 300 | 100 | 1,20 | 2,449 |

➤ AÇIKLAMALAR / INSTRUCTIONS :

NOT: Ölçü toleransı ± 3 mm.'dir.

! Belirtilen ağırlıklar kesim ağırlıktır.

NOTE: The dimension tolerance in ± 3 mm

! The indicated weights are the weights before fabrication.

| Sipariş Kodu (Order Code) | w (mm) | h (mm) | t (mm) | Kg/Adet (Kg/Pcs.) |
|------------------------------|-----------|-----------|-----------|----------------------|
| AP-TRSEA10 | 95 | 100 | 1,20 | 0,203 |
| AP-TRSEA12 | 120 | 100 | 1,20 | 0,226 |
| AP-TRSEA15 | 145 | 100 | 1,20 | 0,250 |
| AP-TRSEA20 | 195 | 100 | 1,20 | 0,297 |
| AP-TRSEA25 | 245 | 100 | 1,20 | 0,344 |
| AP-TRSEA30 | 295 | 100 | 1,20 | 0,391 |

➤ AÇIKLAMALAR / INSTRUCTIONS :

NOT: Ölçü toleransı ± 3 mm.'dir.

! Belirtilen ağırlıklar kesim ağırlıktır.

NOTE: The dimension tolerance in ± 3 mm

! The indicated weights are the weights before fabrication.

TRUNKING İÇ BÜKEY DÖNÜŞ ELEMANLARI
TRUNKING INTERNAL BEND ELEMENTS

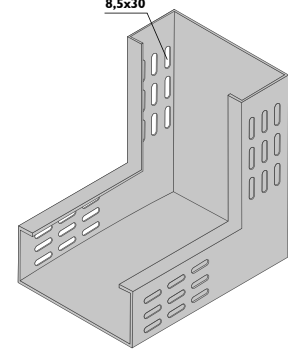
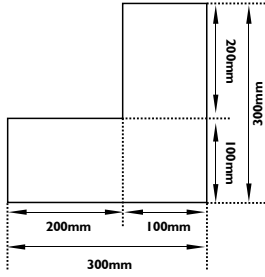
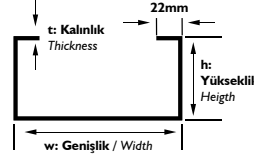

TRUNKING DIŞ BÜKEY DÖNÜŞ ELEMANLARI
TRUNKING EXTERNAL BEND ELEMENTS

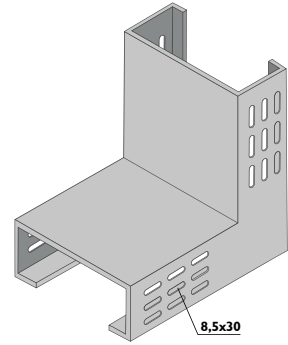
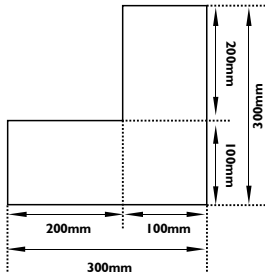
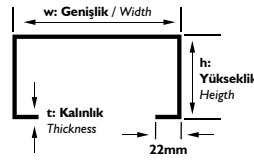

SONLANDIRMA
END CAP

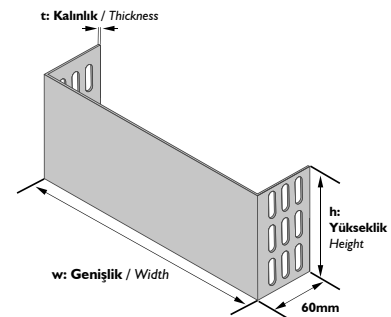

| Sipariş Kodu (Order Code) | w (mm) | h (mm) | t (mm) | Kg/Takım (Kg/Set) |
|------------------------------|-----------|-----------|-----------|----------------------|
| AP-TRZEA1-25 | 25 | 100 | 1,50 | 0,348 |
| AP-TRZEA1-50 | 50 | 100 | 1,50 | 0,377 |
| AP-TRZEA1-75 | 75 | 100 | 1,50 | 0,407 |
| AP-TRZEA1-100 | 100 | 100 | 1,50 | 0,442 |
| AP-TRZEA1-125 | 125 | 100 | 1,50 | 0,466 |
| AP-TRZEA1-150 | 150 | 100 | 1,50 | 0,495 |
| AP-TRZEA1-175 | 175 | 100 | 1,50 | 0,525 |
| AP-TRZEA1-200 | 200 | 100 | 1,50 | 0,554 |
| AP-TRZEA1-225 | 225 | 100 | 1,50 | 0,583 |
| AP-TRZEA1-250 | 250 | 100 | 1,50 | 0,613 |

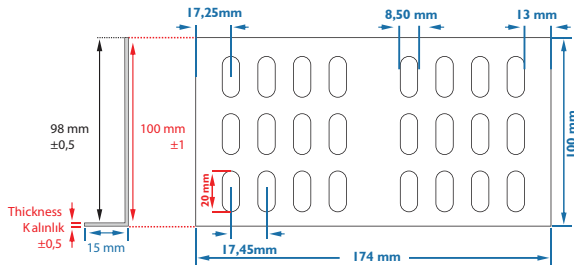

SOLA / LEFT

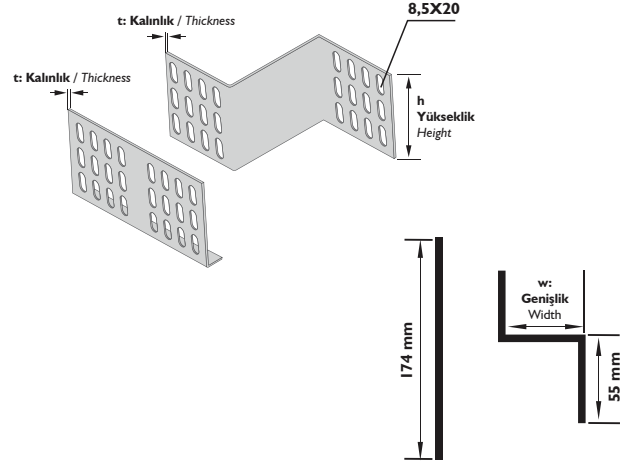
Z TİPİ REDÜKSİYONLAR SOLA
Z TYPE REDUCERS LEFT

| Sipariş Kodu (Order Code) | w (mm) | h (mm) | t (mm) | Kg/Takım (Kg/Set) |
|------------------------------|-----------|-----------|-----------|----------------------|
| AP-TRZEA1-25 | 25 | 100 | 1,50 | 0,348 |
| AP-TRZEA1-50 | 50 | 100 | 1,50 | 0,377 |
| AP-TRZEA1-75 | 75 | 100 | 1,50 | 0,407 |
| AP-TRZEA1-100 | 100 | 100 | 1,50 | 0,442 |
| AP-TRZEA1-125 | 125 | 100 | 1,50 | 0,466 |
| AP-TRZEA1-150 | 150 | 100 | 1,50 | 0,495 |
| AP-TRZEA1-175 | 175 | 100 | 1,50 | 0,525 |
| AP-TRZEA1-200 | 200 | 100 | 1,50 | 0,554 |
| AP-TRZEA1-225 | 225 | 100 | 1,50 | 0,583 |
| AP-TRZEA1-250 | 250 | 100 | 1,50 | 0,613 |

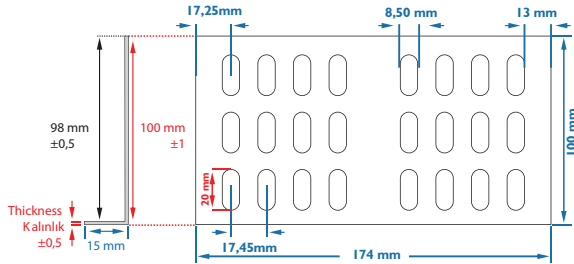

SAĞA / RIGHT

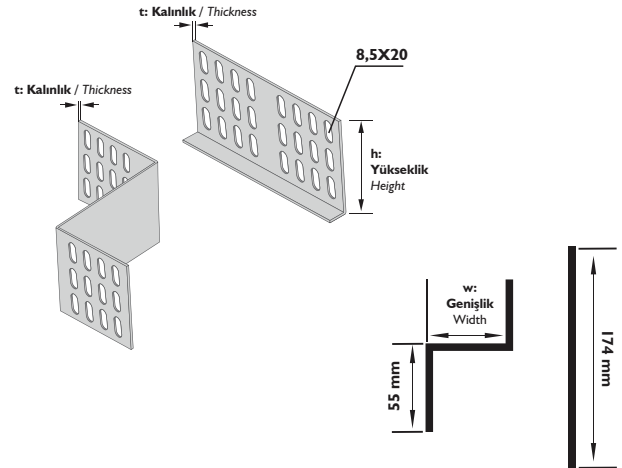
Z TİPİ REDÜKSİYONLAR SAĞA
Z TYPE REDUCERS RIGHT

| Sipariş Kodu (Order Code) | w (mm) | h (mm) | t (mm) | Kg/Takım (Kg/Set) |
|------------------------------|-----------|-----------|-----------|----------------------|
| AP-TRZEA2-12 | 12 | 100 | 1,50 | 0,288 |
| AP-TRZEA2-25 | 25 | 100 | 1,50 | 0,318 |
| AP-TRZEA2-50 | 50 | 100 | 1,50 | 0,377 |
| AP-TRZEA2-75 | 75 | 100 | 1,50 | 0,436 |
| AP-TRZEA2-100 | 100 | 100 | 1,50 | 0,495 |
| AP-TRZEA2-125 | 125 | 100 | 1,50 | 0,553 |
| AP-TRZEA2-137 | 150 | 100 | 1,50 | 0,583 |

ORTADAN / CENTER

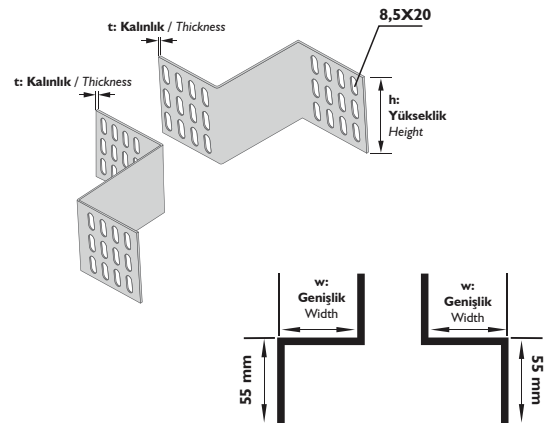
Z TİPİ REDÜKSİYONLAR ORTADAN
Z TYPE REDUCERS CENTER

AÇIKLAMALAR / INSTRUCTIONS :
NOT: Lütfen siparişlerinizde reduksiyon tipini ve "w" ölçüsünü belirtiniz.

! Özel ölçüler için lütfen Örmamız ile irtibata geçiniz.

! Metrik 8 civata ve somun kullanımına uygundur. Belirtilen ağırlıklar kesim ağırlıklarıdır.

NOTE: Please assert the reduction type and "w" dimension.

! For special dimensions please contact our Örm

! M8 bolt and Nut usage. The indicated weights are the weights before fabrication.

| Sipariş Kodu (Order Code) | w (mm) | h (mm) | t (mm) | Kg/Mt (Kg/Mt) |
|------------------------------|-----------|-----------|-----------|------------------|
| AP-TR12.12/125 | 125 | 125 | 1,20 | 3,890 |
| AP-TR12.15/125 | 125 | 125 | 1,50 | 4,863 |
| AP-TR12.20/125 | 125 | 125 | 2,00 | 5,836 |
| AP-TR15.12/125 | 150 | 125 | 1,20 | 4,126 |
| AP-TR15.15/125 | 150 | 125 | 1,50 | 5,157 |
| AP-TR15.20/125 | 150 | 125 | 2,00 | 6,189 |
| AP-TR20.12/125 | 200 | 125 | 1,20 | 4,597 |
| AP-TR20.15/125 | 200 | 125 | 1,50 | 5,746 |
| AP-TR20.20/125 | 200 | 125 | 2,00 | 6,895 |
| AP-TR25.12/125 | 250 | 125 | 1,20 | 5,068 |
| AP-TR25.15/125 | 250 | 125 | 1,50 | 6,335 |
| AP-TR25.20/125 | 250 | 125 | 2,00 | 7,602 |
| AP-TR30.12/125 | 300 | 125 | 1,20 | 5,539 |
| AP-TR30.15/125 | 300 | 125 | 1,50 | 6,924 |
| AP-TR30.20/125 | 300 | 125 | 2,00 | 8,308 |

TRUNKING

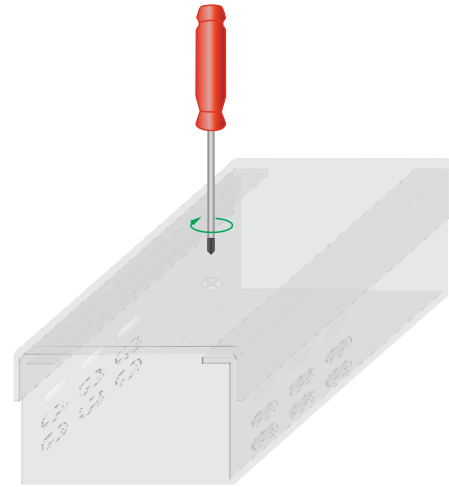
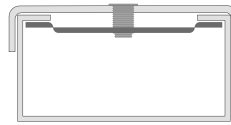
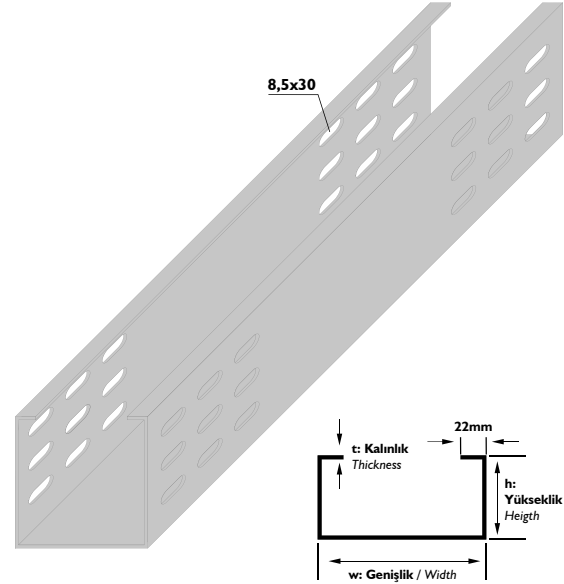

➤ AÇIKLAMALAR / INSTRUCTIONS :

NOT: Standart uzunluk 2500mm. İsteğe bağlı olarak uzunluklar değişebilir.

! Trunking'lerde ölçü toleransı ± 3 mm.'dir.

! Belirtilen ağırlıklar kesim ağırlıklarıdır.

! Trunking'ler, Metrik 6, 8 cıvata ve somun kullanımına uygundur.

NOTE: Standart Length is 2500mm. On request the Lengths can change.

! The dimension tolerance in Trunking is ± 3 mm.

! The indicated weights are the weights before fabrication.

! All the Trunkings are convenient for M8 bolt and nut usage.

| Sipariş Kodu (Order Code) | w (mm) | h (mm) | t (mm) | L (mm) | Kg/Adet (Kg/Pcs.) |
|------------------------------|-----------|-----------|-----------|-----------|----------------------|
| AP-AI-12.12 | 15 | 125 | 1,20 | 174 | 0,229 |

EK ELEMANI
JOINT PIECE

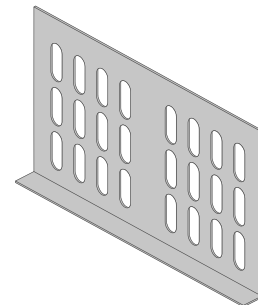
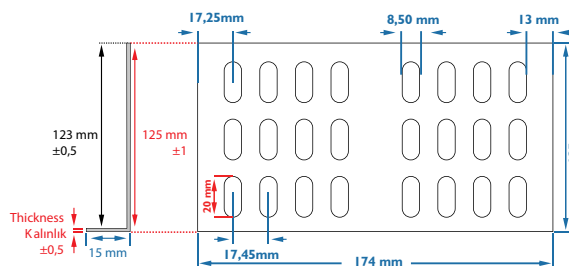

➤ AÇIKLAMALAR / INSTRUCTIONS :

NOT: Ölçü toleransı ± 3 mm.'dir.

! Belirtilen ağırlıklar kesim ağırlıklarıdır.

! Metrik 8 cıvata ve somun kullanımına uygundur.

NOTE: The dimension tolerance in perforated cable trays is ± 3 mm

! The indicated weights are the weights before fabrication.

! Convenient for M8 bolt and nut usage.

| Sipariş Kodu (Order Code) | a, b (mm) | h (mm) | t (mm) | Kg/Adet (Kg/Pcs.) |
|------------------------------|--------------|-----------|-----------|----------------------|
| AP-YDTR112/125 | 125 | 125 | 1,20 | 1,770 |
| AP-YDTR115/125 | 150 | 125 | 1,20 | 1,930 |
| AP-YDTR120/125 | 200 | 125 | 1,20 | 2,312 |
| AP-YDTR125/125 | 250 | 125 | 1,20 | 2,732 |
| AP-YDTR130/125 | 300 | 125 | 1,50 | 4,000 |

► AÇIKLAMALAR / INSTRUCTIONS :
NOT: Ölçü toleransı ± 3 mm.'dir.

! Belirtilen ağırlıklar kesim ağırlıklarıdır.

NOTE: The dimension tolerance in ± 3 mm

! The indicated weights are the weights before fabrication.

| Sipariş Kodu (Order Code) | a, b, c (mm) | h (mm) | t (mm) | Kg/Adet (Kg/Pcs.) |
|------------------------------|-----------------|-----------|-----------|----------------------|
| AP-TDTR212/125 | 125 | 125 | 1,20 | 2,167 |
| AP-TDTR215/125 | 150 | 125 | 1,20 | 2,307 |
| AP-TDTR220/125 | 200 | 125 | 1,20 | 2,623 |
| AP-TDTR225/125 | 250 | 125 | 1,20 | 2,987 |
| AP-TDTR230/125 | 300 | 125 | 1,50 | 4,246 |

► AÇIKLAMALAR / INSTRUCTIONS :
NOT: Ölçü toleransı ± 3 mm.'dir.

! Belirtilen ağırlıklar kesim ağırlıklarıdır.

NOTE: The dimension tolerance in ± 3 mm

! The indicated weights are the weights before fabrication.

| Sipariş Kodu (Order Code) | a, b, c, d (mm) | h (mm) | t (mm) | Kg/Adet (Kg/Pcs.) |
|------------------------------|--------------------|-----------|-----------|----------------------|
| AP-DDTR312/125 | 125 | 125 | 1,20 | 2,433 |
| AP-DDTR315/125 | 150 | 125 | 1,20 | 2,533 |
| AP-DDTR320/125 | 200 | 125 | 1,20 | 2,768 |
| AP-DDTR325/125 | 250 | 125 | 1,20 | 3,051 |
| AP-DDTR330/125 | 300 | 125 | 1,50 | 4,226 |

► AÇIKLAMALAR / INSTRUCTIONS :
NOT: Ölçü toleransı ± 3 mm.'dir.

! Belirtilen ağırlıklar kesim ağırlıklarıdır.

NOTE: The dimension tolerance in ± 3 mm

! The indicated weights are the weights before fabrication.

AÇIKLAMALAR / INSTRUCTIONS : Ekstra / Extra

 Tüm dönüş uygulamaları, Metrik 8 civata ve somun kullanımına uygundur.
 Belirtilen ağırlıklar kesim ağırlıklarıdır.

 All the bend implementation are convenient for M8 bolt and Nut usage.
 The indicated weights are the weights before fabrication.

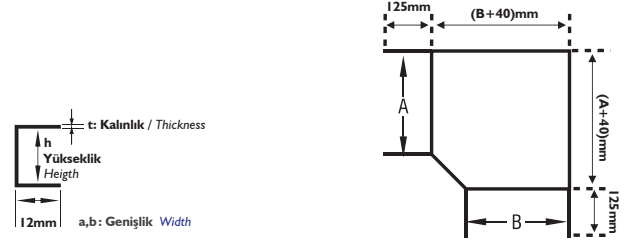
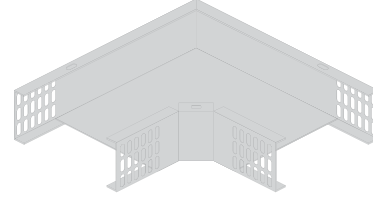
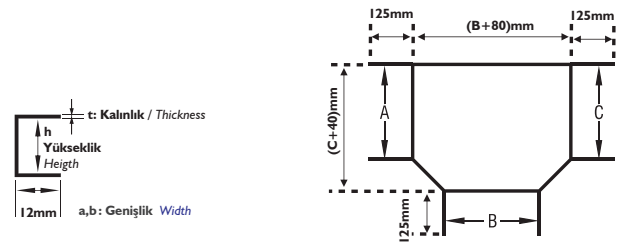
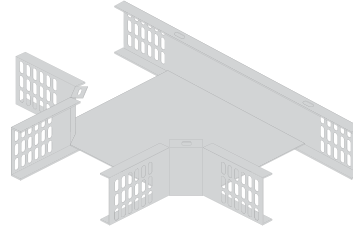
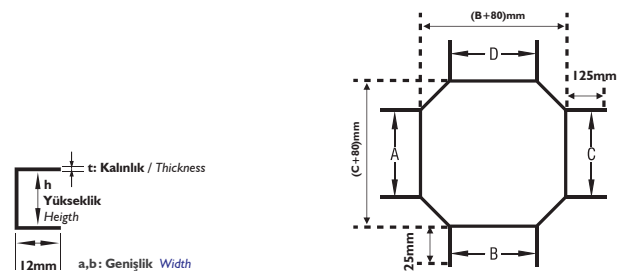
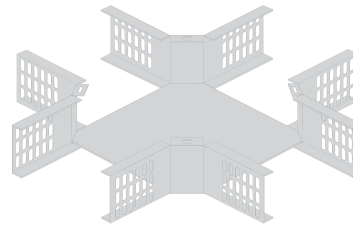
TRUNKING 90° DÖNÜŞ ELEMANLARI
TRUNKING TYPE 90° BENDS

TRUNKING TİP T DÖNÜŞ ELEMANLARI
TRUNKING TYPE TEE-BRANCHES

TRUNKING TİP DÖRTLÜ BAĞLANTILAR
TRUNKING TYPE CROSSINGS

| Sipariş Kodu (Order Code) | w (mm) | h (mm) | t (mm) | Kg/Adet (Kg/Pcs.) |
|------------------------------|-----------|-----------|-----------|----------------------|
| AP-BTR512/125 | 125 | 125 | 1,20 | 2,143 |
| AP-BTR515/125 | 150 | 125 | 1,20 | 2,261 |
| AP-BTR520/125 | 200 | 125 | 1,20 | 2,496 |
| AP-BTR525/125 | 250 | 125 | 1,20 | 2,732 |
| AP-BTR530/125 | 300 | 125 | 1,20 | 2,967 |

➤ AÇIKLAMALAR / INSTRUCTIONS :

NOT: Ölçü toleransı ± 3 mm.'dir.

! Belirtilen ağırlıklar kesim ağırlıklarıdır.

NOTE: The dimension tolerance in ± 3 mm

! The indicated weights are the weights before fabrication.

| Sipariş Kodu (Order Code) | w (mm) | h (mm) | t (mm) | Kg/Adet (Kg/Pcs.) |
|------------------------------|-----------|-----------|-----------|----------------------|
| AP-BTR612/125 | 125 | 125 | 1,20 | 2,025 |
| AP-BTR615/125 | 150 | 125 | 1,20 | 2,120 |
| AP-BTR620/125 | 200 | 125 | 1,20 | 2,308 |
| AP-BTR625/125 | 250 | 125 | 1,20 | 2,496 |
| AP-BTR630/125 | 300 | 125 | 1,20 | 2,685 |

➤ AÇIKLAMALAR / INSTRUCTIONS :

NOT: Ölçü toleransı ± 3 mm.'dir.

! Belirtilen ağırlıklar kesim ağırlıklarıdır.

NOTE: The dimension tolerance in ± 3 mm

! The indicated weights are the weights before fabrication.

| Sipariş Kodu (Order Code) | w (mm) | h (mm) | t (mm) | Kg/Adet (Kg/Pcs.) |
|------------------------------|-----------|-----------|-----------|----------------------|
| AP-TRSAE12 | 120 | 125 | 1,20 | 0,283 |
| AP-TRSAE15 | 145 | 125 | 1,20 | 0,312 |
| AP-TRSAE20 | 195 | 125 | 1,20 | 0,371 |
| AP-TRSAE25 | 245 | 125 | 1,20 | 0,430 |
| AP-TRSAE30 | 295 | 125 | 1,20 | 0,489 |

➤ AÇIKLAMALAR / INSTRUCTIONS :

NOT: Ölçü toleransı ± 3 mm.'dir.

! Belirtilen ağırlıklar kesim ağırlıklarıdır.

NOTE: The dimension tolerance in ± 3 mm

! The indicated weights are the weights before fabrication.

TRUNKING İÇ BÜKEY DÖNÜŞ ELEMANLARI
TRUNKING INTERNAL BEND ELEMENTS

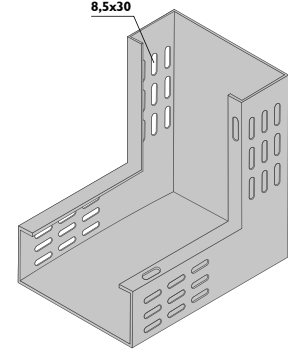
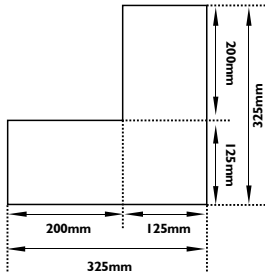
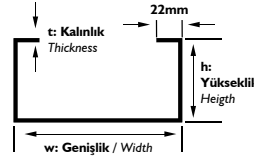

TRUNKING DIŞ BÜKEY DÖNÜŞ ELEMANLARI
TRUNKING EXTERNAL BEND ELEMENTS

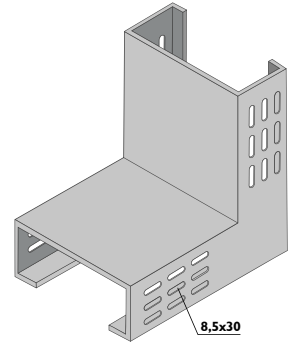
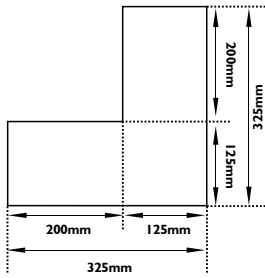
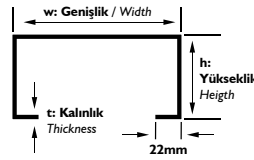

SONLANDIRMA
END CAP

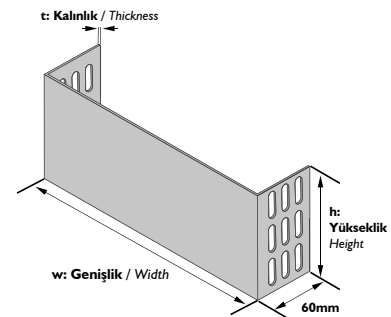

| Sipariş Kodu (Order Code) | w (mm) | h (mm) | t (mm) | Kg/Takım (Kg/Set) |
|------------------------------|-----------|-----------|-----------|----------------------|
| AP-TRZAEI-25 | 25 | 125 | 1,50 | 0,428 |
| AP-TRZAEI-50 | 50 | 125 | 1,50 | 0,465 |
| AP-TRZAEI-75 | 75 | 125 | 1,50 | 0,501 |
| AP-TRZAEI-100 | 100 | 125 | 1,50 | 0,545 |
| AP-TRZAEI-125 | 125 | 125 | 1,50 | 0,575 |
| AP-TRZAEI-150 | 150 | 125 | 1,50 | 0,612 |
| AP-TRZAEI-175 | 175 | 125 | 1,50 | 0,648 |
| AP-TRZAEI-200 | 200 | 125 | 1,50 | 0,685 |
| AP-TRZAEI-225 | 225 | 125 | 1,50 | 0,722 |
| AP-TRZAEI-250 | 250 | 125 | 1,50 | 0,759 |

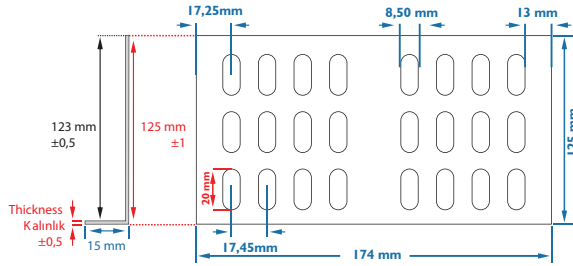

SOLA / LEFT

Z TİPİ REDÜKSİYONLAR SOLA
Z TYPE REDUCERS LEFT

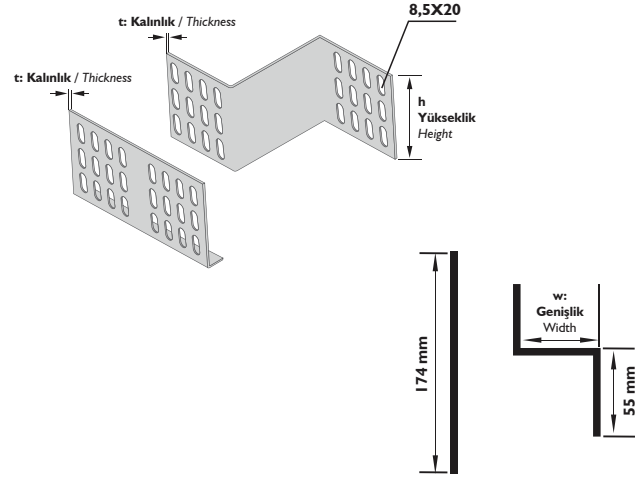

| Sipariş Kodu (Order Code) | w (mm) | h (mm) | t (mm) | Kg/Takım (Kg/Set) |
|------------------------------|-----------|-----------|-----------|----------------------|
| AP-TRZAEI-25 | 25 | 125 | 1,50 | 0,428 |
| AP-TRZAEI-50 | 50 | 125 | 1,50 | 0,465 |
| AP-TRZAEI-75 | 75 | 125 | 1,50 | 0,501 |
| AP-TRZAEI-100 | 100 | 125 | 1,50 | 0,545 |
| AP-TRZAEI-125 | 125 | 125 | 1,50 | 0,575 |
| AP-TRZAEI-150 | 150 | 125 | 1,50 | 0,612 |
| AP-TRZAEI-175 | 175 | 125 | 1,50 | 0,648 |
| AP-TRZAEI-200 | 200 | 125 | 1,50 | 0,685 |
| AP-TRZAEI-225 | 225 | 125 | 1,50 | 0,722 |
| AP-TRZAEI-250 | 250 | 125 | 1,50 | 0,759 |

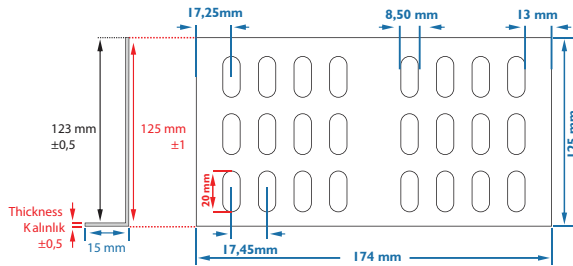

SAĞA / RIGHT

Z TİPİ REDÜKSİYONLAR SAĞA
Z TYPE REDUCERS RIGHT

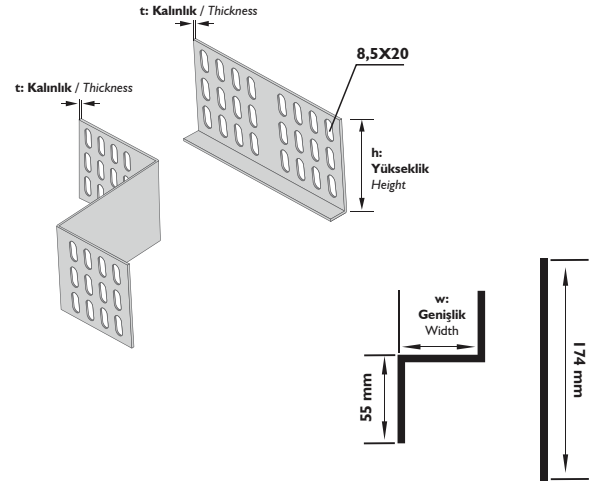

| Sipariş Kodu (Order Code) | w (mm) | h (mm) | t (mm) | Kg/Takım (Kg/Set) |
|------------------------------|-----------|-----------|-----------|----------------------|
| AP-TRZAE2-12 | 12 | 125 | 1,50 | 0,361 |
| AP-TRZAE2-25 | 25 | 125 | 1,50 | 0,397 |
| AP-TRZAE2-50 | 50 | 125 | 1,50 | 0,471 |
| AP-TRZAE2-75 | 75 | 125 | 1,50 | 0,545 |
| AP-TRZAE2-100 | 100 | 125 | 1,50 | 0,618 |
| AP-TRZAE2-125 | 125 | 125 | 1,50 | 0,692 |
| AP-TRZAE2-137 | 150 | 125 | 1,50 | 0,729 |

ORTADAN / CENTER

Z TİPİ REDÜKSİYONLAR ORTADAN
Z TYPE REDUCERS CENTER

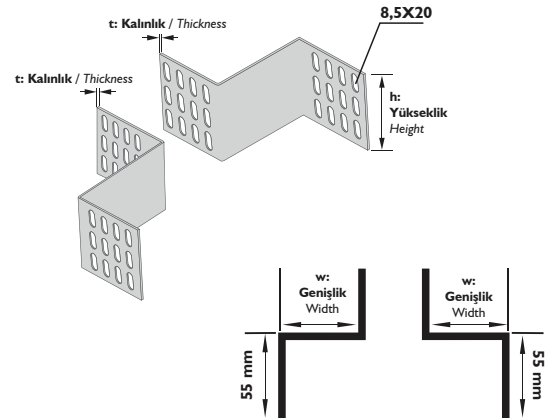

► AÇIKLAMALAR / INSTRUCTIONS :

NOT: Lütfen siparişlerinizde redüksiyon tipini ve "w" ölçüsünü belirtiniz.

! Özel ölçüler için lütfen Örmamız ile irtibata geçiniz.

! Metrik 8 civata ve somun kullanımına uygundur. Belirtilen ağırlıklar kesim ağırlıklarıdır.

NOTE: Please assert the reduction type and "w" dimension.

! For special dimensions please contact our Örm

! M8 bolt and Nut usage. The indicated weights are the weights before fabrication.

| Sipariş Kodu (Order Code) | w (mm) | h (mm) | t (mm) | Kg/Mt (Kg/Mt) |
|------------------------------|-----------|-----------|-----------|------------------|
| AP-TR15.12/150 | 150 | 150 | 1,20 | 4,597 |
| AP-TR15.15/150 | 150 | 150 | 1,50 | 5,746 |
| AP-TR15.20/150 | 150 | 150 | 2,00 | 6,895 |
| AP-TR20.12/150 | 200 | 150 | 1,20 | 5,068 |
| AP-TR20.15/150 | 200 | 150 | 1,50 | 6,335 |
| AP-TR20.20/150 | 200 | 150 | 2,00 | 7,602 |
| AP-TR25.12/150 | 250 | 150 | 1,20 | 5,539 |
| AP-TR25.15/150 | 250 | 150 | 1,50 | 6,924 |
| AP-TR25.20/150 | 250 | 150 | 2,00 | 8,308 |
| AP-TR30.12/150 | 300 | 150 | 1,20 | 6,010 |
| AP-TR30.15/150 | 300 | 150 | 1,50 | 7,513 |
| AP-TR30.20/150 | 300 | 150 | 2,00 | 9,015 |

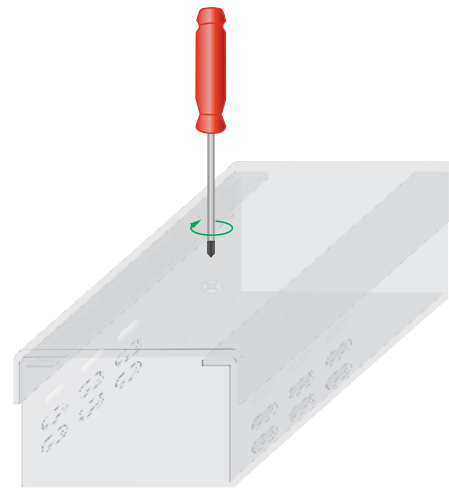
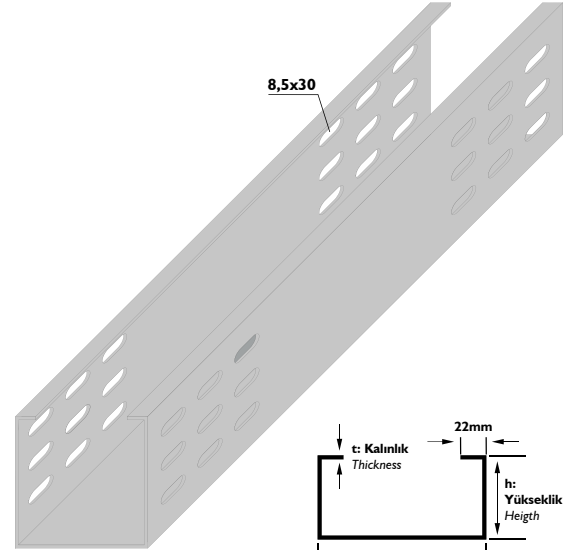
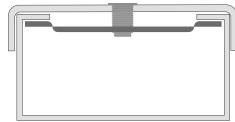

► AÇIKLAMALAR / INSTRUCTIONS :

NOT: Standart uzunluk 2500mm. İsteğe bağlı olarak uzunluklar değişebilir.

! Trunking'lerde ölçü toleransı ± 3 mm.'dir.

! Belirtilen ağırlıklar kesim ağırlıklardır.

! Trunking'ler, Metrik 6, 8 cıvata ve somun kullanımına uygundur.

NOTE: Standart Length is 2500mm. On request the Lengths can change.

! The dimension tolerance in Trunking is ± 3 mm.

! The indicated weights are the weights before fabrication.

! All the Trunkings are convenient for M8 bolt and nut usage.

| Sipariş Kodu (Order Code) | w (mm) | h (mm) | t (mm) | L (mm) | Kg/Adet (Kg/Pcs.) |
|------------------------------|-----------|-----------|-----------|-----------|----------------------|
| AP-AI-15.15 | 15 | 152 | 1,50 | 234 | 0,454 |

EK ELEMANI JOINT PIECE

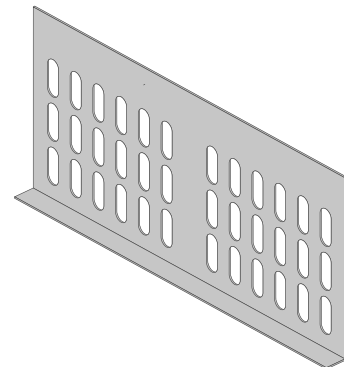
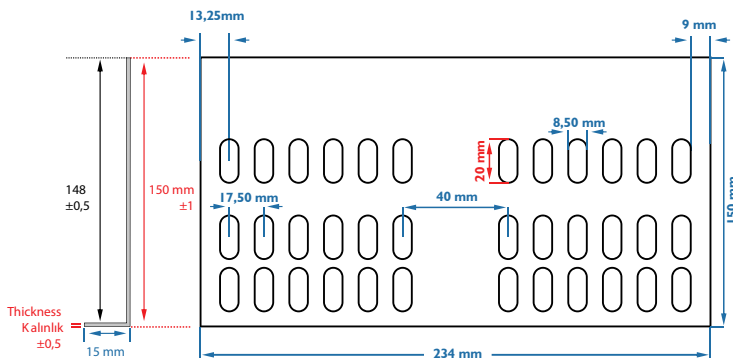

► AÇIKLAMALAR / INSTRUCTIONS :

NOT: Ölçü toleransı ± 3 mm.'dir.

! Belirtilen ağırlıklar kesim ağırlıklardır.

! Metrik 8 cıvata ve somun kullanımına uygundur.

NOTE: The dimension tolerance in perforated cable trays is ± 3 mm

! The indicated weights are the weights before fabrication.

! Convenient for M8 bolt and nut usage.

| Sipariş Kodu (Order Code) | a, b (mm) | h (mm) | t (mm) | Kg/Adet (Kg/Pcs.) |
|------------------------------|--------------|-----------|-----------|----------------------|
| AP-YDTR115/150 | 150 | 150 | 1,20 | 2,168 |
| AP-YDTR120/150 | 200 | 150 | 1,20 | 2,564 |
| AP-YDTR125/150 | 250 | 150 | 1,20 | 3,008 |
| AP-YDTR130/150 | 300 | 150 | 1,50 | 4,373 |

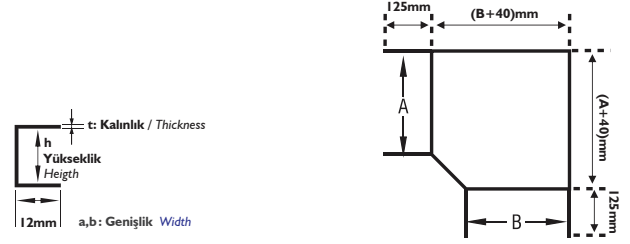
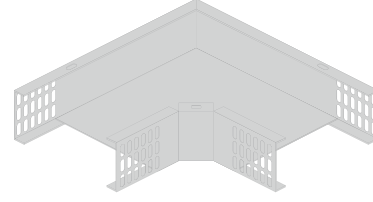
TRUNKING 90° DÖNÜŞ ELEMANLARI
TRUNKING TYPE 90° BENDS

AÇIKLAMALAR / INSTRUCTIONS :

NOT: Ölçü toleransı ± 3 mm.'dir.

! Belirtilen ağırlıklar kesim ağırlıktır.

NOTE: The dimension tolerance in ± 3 mm

! The indicated weights are the weights before fabrication.

| Sipariş Kodu (Order Code) | a, b, c (mm) | h (mm) | t (mm) | Kg/Adet (Kg/Pcs.) |
|------------------------------|-----------------|-----------|-----------|----------------------|
| AP-TDTR215/150 | 150 | 150 | 1,20 | 2,576 |
| AP-TDTR220/150 | 200 | 150 | 1,20 | 2,904 |
| AP-TDTR225/150 | 250 | 150 | 1,20 | 3,279 |
| AP-TDTR230/150 | 300 | 150 | 1,50 | 4,626 |

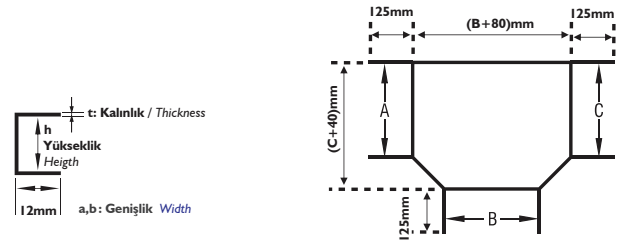
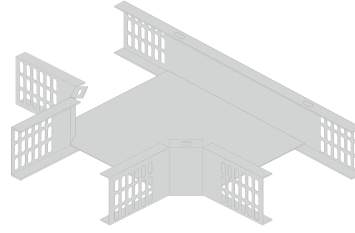
TRUNKING TİP T DÖNÜŞ ELEMANLARI
TRUNKING TYPE TEE-BRANCHES

AÇIKLAMALAR / INSTRUCTIONS :

NOT: Ölçü toleransı ± 3 mm.'dir.

! Belirtilen ağırlıklar kesim ağırlıktır.

NOTE: The dimension tolerance in ± 3 mm

! The indicated weights are the weights before fabrication.

| Sipariş Kodu (Order Code) | a, b, c, d (mm) | h (mm) | t (mm) | Kg/Adet (Kg/Pcs.) |
|------------------------------|--------------------|-----------|-----------|----------------------|
| AP-DDTR315/150 | 150 | 150 | 1,20 | 2,834 |
| AP-DDTR320/150 | 200 | 150 | 1,20 | 3,070 |
| AP-DDTR325/150 | 250 | 150 | 1,20 | 3,352 |
| AP-DDTR330/150 | 300 | 150 | 1,50 | 4,603 |

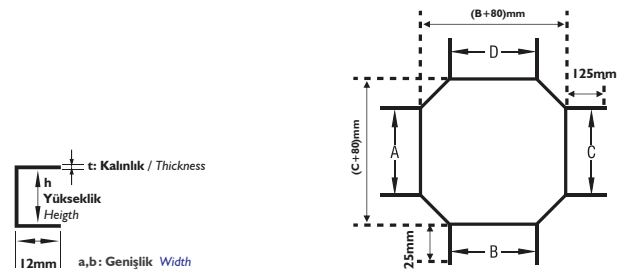
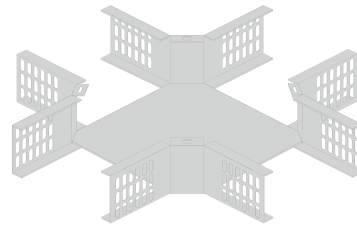
TRUNKING TİP DÖRTLÜ BAĞLANTILAR
TRUNKING TYPE CROSSINGS

AÇIKLAMALAR / INSTRUCTIONS :

NOT: Ölçü toleransı ± 3 mm.'dir.

! Belirtilen ağırlıklar kesim ağırlıktır.

NOTE: The dimension tolerance in ± 3 mm

! The indicated weights are the weights before fabrication.

AÇIKLAMALAR / INSTRUCTIONS : Ekstra / Extra

Tüm dönüş uygulamaları, Metrik 8 civata ve somun kullanımına uygundur.
 Belirtilen ağırlıklar kesim ağırlıktır.

All the bend implementation are convenient for M8 bolt and Nut usage.
 The indicated weights are the weights before fabrication.

| Sipariş Kodu (Order Code) | w (mm) | h (mm) | t (mm) | Kg/Adet (Kg/Pcs.) |
|------------------------------|-----------|-----------|-----------|----------------------|
| AP-BTR515/150 | 150 | 150 | 1,20 | 2,496 |
| AP-BTR520/150 | 200 | 150 | 1,20 | 2,732 |
| AP-BTR525/150 | 250 | 150 | 1,20 | 2,967 |
| AP-BTR530/150 | 300 | 150 | 1,20 | 3,203 |

➤ AÇIKLAMALAR / INSTRUCTIONS :

NOT: Ölçü toleransı ± 3 mm.'dir.

! Belirtilen ağırlıklar kesim ağırlıklarıdır.

NOTE: The dimension tolerance in ± 3 mm

! The indicated weights are the weights before fabrication.

| Sipariş Kodu (Order Code) | w (mm) | h (mm) | t (mm) | Kg/Adet (Kg/Pcs.) |
|------------------------------|-----------|-----------|-----------|----------------------|
| AP-BTR615/150 | 150 | 150 | 1,20 | 2,355 |
| AP-BTR620/150 | 200 | 150 | 1,20 | 2,543 |
| AP-BTR625/150 | 250 | 150 | 1,20 | 2,732 |
| AP-BTR630/150 | 300 | 150 | 1,20 | 2,920 |

➤ AÇIKLAMALAR / INSTRUCTIONS :

NOT: Ölçü toleransı ± 3 mm.'dir.

! Belirtilen ağırlıklar kesim ağırlıklarıdır.

NOTE: The dimension tolerance in ± 3 mm

! The indicated weights are the weights before fabrication.

| Sipariş Kodu (Order Code) | w (mm) | h (mm) | t (mm) | Kg/Adet (Kg/Pcs.) |
|------------------------------|-----------|-----------|-----------|----------------------|
| AP-TRSEAH15 | 145 | 150 | 1,20 | 0,374 |
| AP-TRSEAH20 | 195 | 150 | 1,20 | 0,445 |
| AP-TRSEAH25 | 245 | 150 | 1,20 | 0,516 |
| AP-TRSEAH30 | 295 | 150 | 1,20 | 0,586 |

➤ AÇIKLAMALAR / INSTRUCTIONS :

NOT: Ölçü toleransı ± 3 mm.'dir.

! Belirtilen ağırlıklar kesim ağırlıklarıdır.

NOTE: The dimension tolerance in ± 3 mm

! The indicated weights are the weights before fabrication.

TRUNKING İÇ BÜKEY DÖNÜŞ ELEMANLARI
TRUNKING INTERNAL BEND ELEMENTS

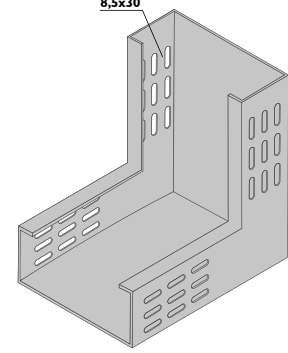
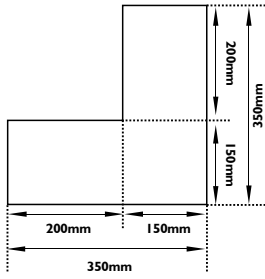
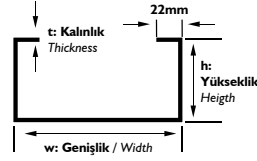

TRUNKING DIŞ BÜKEY DÖNÜŞ ELEMANLARI
TRUNKING EXTERNAL BEND ELEMENTS

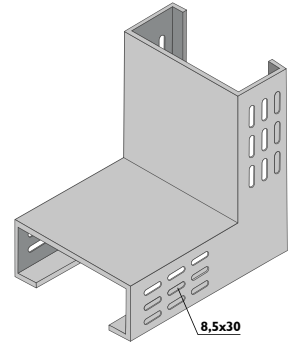
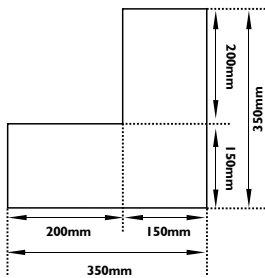
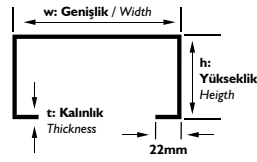

SONLANDIRMA
END CAP

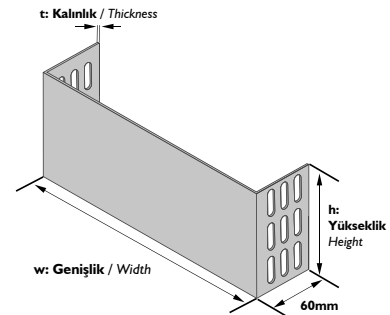

| Sipariş Kodu (Order Code) | w (mm) | h (mm) | t (mm) | Kg/Takım (Kg/Set) |
|------------------------------|-----------|-----------|-----------|----------------------|
| AP-TRZEAH1-50 | 50 | 150 | 1,50 | 0,738 |
| AP-TRZEAH-100 | 100 | 150 | 1,50 | 0,835 |
| AP-TRZEAH-150 | 150 | 150 | 1,50 | 0,914 |

SOLA / LEFT

Z TİPİ REDÜKSİYONLAR SOLA
Z TYPE REDUCERS LEFT

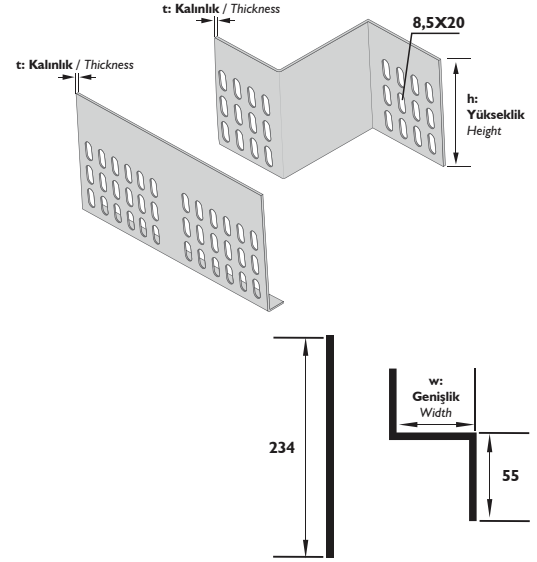
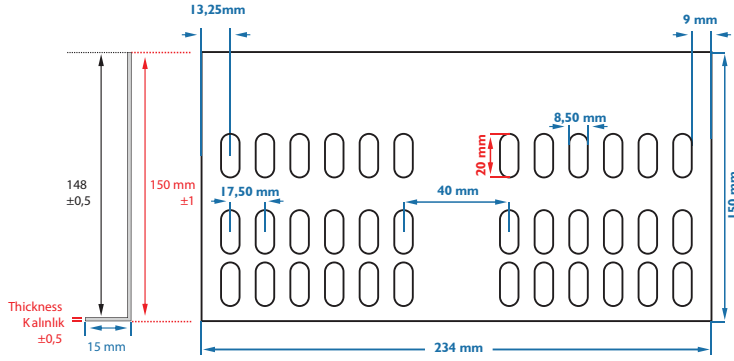

| Sipariş Kodu (Order Code) | w (mm) | h (mm) | t (mm) | Kg/Takım (Kg/Set) |
|------------------------------|-----------|-----------|-----------|----------------------|
| AP-TRZEAH1-50 | 50 | 150 | 1,50 | 0,738 |
| AP-TRZEAH-100 | 100 | 150 | 1,50 | 0,835 |
| AP-TRZEAH-150 | 150 | 150 | 1,50 | 0,914 |

SAĞA / RIGHT

Z TİPİ REDÜKSİYONLAR SAĞA
Z TYPE REDUCERS RIGHT

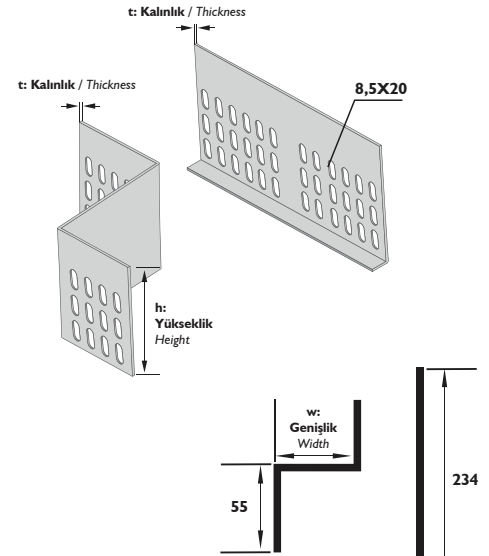
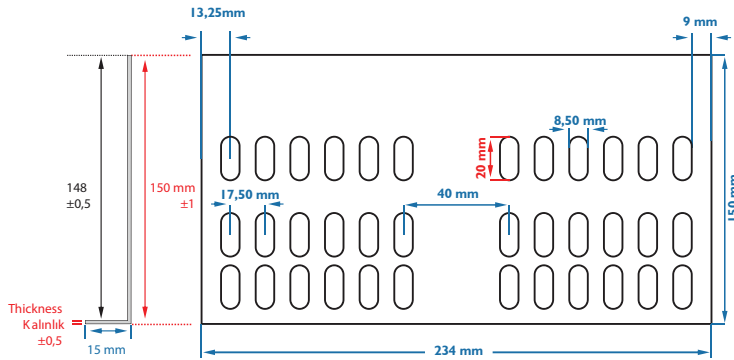

| Sipariş Kodu (Order Code) | w (mm) | h (mm) | t (mm) | Kg/Takım (Kg/Set) |
|------------------------------|-----------|-----------|-----------|----------------------|
| AP-TRZEAH2-25 | 25 | 150 | 1,50 | 0,477 |
| AP-TRZEAH2-50 | 50 | 150 | 1,50 | 0,565 |
| AP-TRZEAH2-75 | 75 | 150 | 1,50 | 0,654 |

ORTADAN / CENTER

Z TİPİ REDÜKSİYONLAR ORTADAN
Z TYPE REDUCERS CENTER

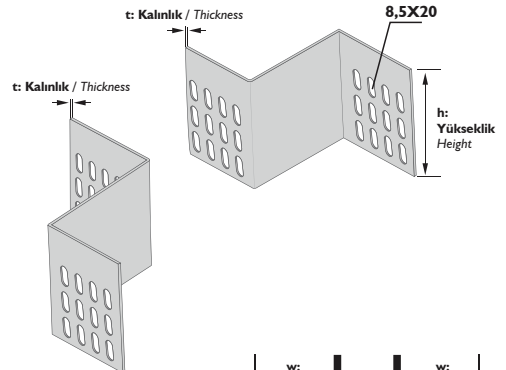

► AÇIKLAMALAR / INSTRUCTIONS :

NOT: Lütfen siparişlerinizde redüksiyon tipini ve "w" ölçüsünü belirtiniz.

! Özel ölçüler için lütfen Örmamız ile irtibata geçiniz.

! Metrik 8 cıvata ve somun kullanımına uygundur. Belirtilen ağırlıklar kesim ağırlıklarıdır.

NOTE: Please assert the reduction type and "w" dimension.

! For special dimensions please contact our Örmamız

! M8 bolt and Nut usage. The indicated weights are the weights before fabrication.

| Sipariş Kodu (Order Code) | w (mm) | h (mm) | t (mm) | Kg/Mt (Kg/Mt) |
|------------------------------|-----------|-----------|-----------|------------------|
| AP-TR20.12/200 | 200 | 200 | 1,20 | 6,010 |
| AP-TR20.15/200 | 200 | 200 | 1,50 | 0,712 |
| AP-TR20.20/200 | 200 | 200 | 2,00 | 9,015 |
| AP-TR25.12/200 | 250 | 200 | 1,20 | 6,481 |
| AP-TR25.15/200 | 250 | 200 | 1,50 | 8,101 |
| AP-TR25.20/200 | 250 | 200 | 2,00 | 9,721 |
| AP-TR30.12/200 | 300 | 200 | 1,20 | 6,952 |
| AP-TR30.15/200 | 300 | 200 | 1,50 | 8,690 |
| AP-TR30.20/200 | 300 | 200 | 2,00 | 10,428 |

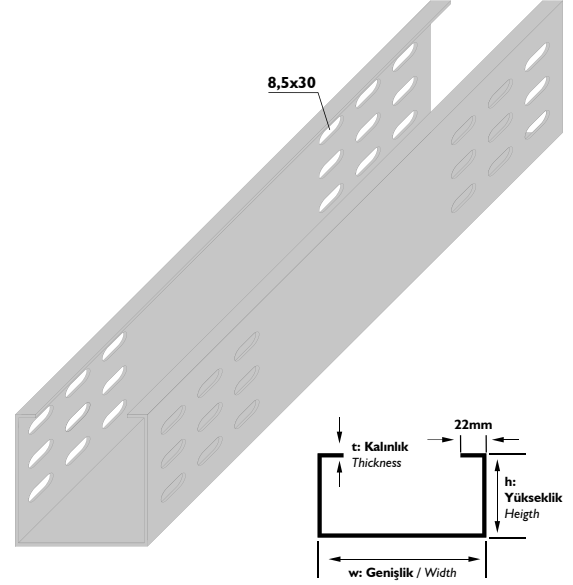

► AÇIKLAMALAR / INSTRUCTIONS :

NOT: Standart uzunluk 2500mm. İsteğe bağlı olarak uzunluklar değişebilir.

! Trunking'lerde ölçü toleransı ± 3 mm.'dir.

! Belirtilen ağırlıklar kesim ağırlıklardır.

! Trunking'ler, Metrik 6, 8 cıvata ve somun kullanımına uygundur.

NOTE: Standart Length is 2500mm. On request the Lengths can change.

! The dimension tolerance in Trunking is ± 3 mm.

! The indicated weights are the weights before fabrication.

! All the Trunkings are convenient for M8 bolt and nut usage.

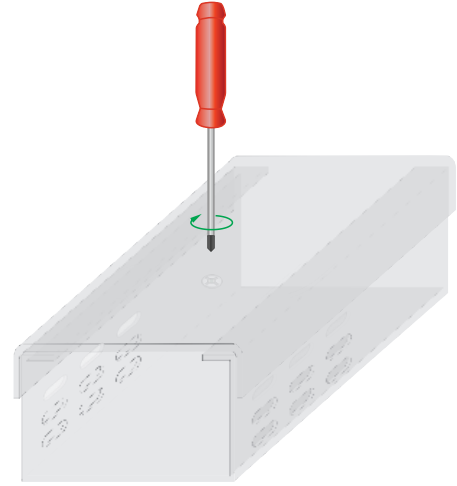

| Sipariş Kodu (Order Code) | w (mm) | h (mm) | t (mm) | L (mm) | Kg/Adet (Kg/Pcs.) |
|------------------------------|-----------|-----------|-----------|-----------|----------------------|
| AP-AI-20.15 | 15 | 200 | 1,50 | 234 | 0,592 |

EK ELEMANI JOINT PIECE

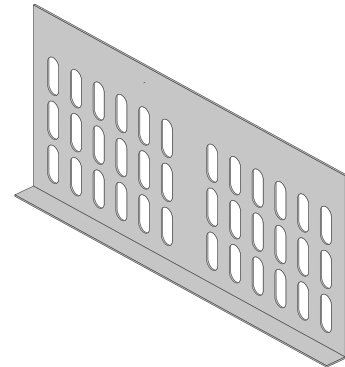
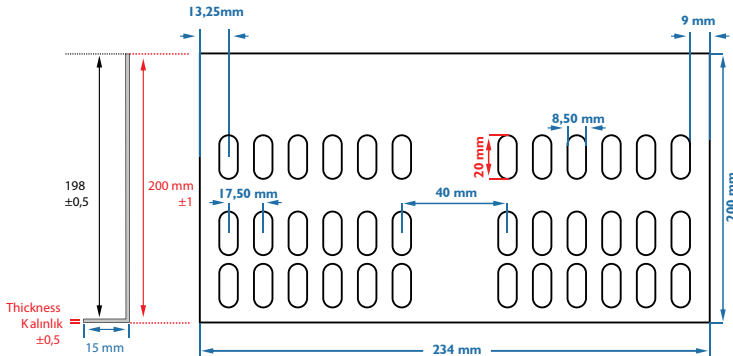

► AÇIKLAMALAR / INSTRUCTIONS :

NOT: Ölçü toleransı ± 3 mm.'dir.

! Belirtilen ağırlıklar kesim ağırlıklardır.

! Metrik 8 cıvata ve somun kullanımına uygundur.

NOTE: The dimension tolerance in perforated cable trays is ± 3 mm

! The indicated weights are the weights before fabrication.

! Convenient for M8 bolt and nut usage.

| Sipariş Kodu (Order Code) | a, b (mm) | h (mm) | t (mm) | Kg/Adet (Kg/Pcs.) |
|------------------------------|--------------|-----------|-----------|----------------------|
| AP-YDTR120/200 | 200 | 200 | 1,20 | 3,068 |
| AP-YDTR125/200 | 250 | 200 | 1,20 | 3,559 |
| AP-YDTR130/200 | 300 | 200 | 1,50 | 5,121 |

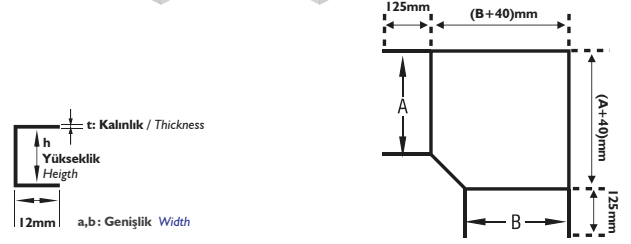
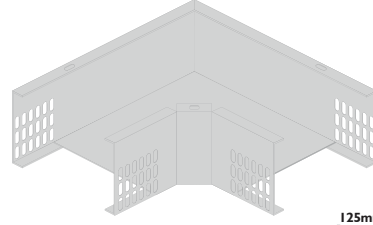
TRUNKING 90° DÖNÜŞ ELEMANLARI
 TRUNKING TYPE 90° BENDS

AÇIKLAMALAR / INSTRUCTIONS :

NOT: Ölçü toleransı ± 3 mm.'dir.

! Belirtilen ağırlıklar kesim ağırlıklarıdır.

NOTE: The dimension tolerance in ± 3 mm

! The indicated weights are the weights before fabrication.

| Sipariş Kodu (Order Code) | a, b, c (mm) | h (mm) | t (mm) | Kg/Adet (Kg/Pcs.) |
|------------------------------|-----------------|-----------|-----------|----------------------|
| AP-TDTR220/200 | 200 | 200 | 1,20 | 3,464 |
| AP-TDTR225/200 | 250 | 200 | 1,20 | 3,869 |
| AP-TDTR230/200 | 300 | 200 | 1,50 | 5,385 |

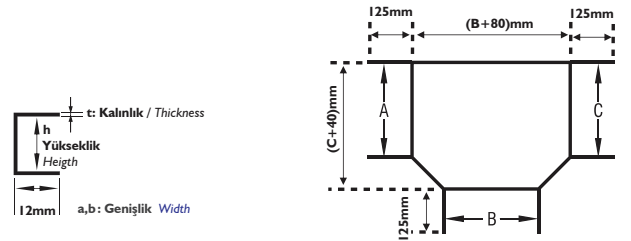
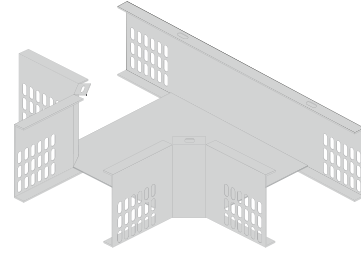
TRUNKING TİP T DÖNÜŞ ELEMANLARI
 TRUNKING TYPE TEE-BRANCHES

AÇIKLAMALAR / INSTRUCTIONS :

NOT: Ölçü toleransı ± 3 mm.'dir.

! Belirtilen ağırlıklar kesim ağırlıklarıdır.

NOTE: The dimension tolerance in ± 3 mm

! The indicated weights are the weights before fabrication.

| Sipariş Kodu (Order Code) | a, b, c, d (mm) | h (mm) | t (mm) | Kg/Adet (Kg/Pcs.) |
|------------------------------|--------------------|-----------|-----------|----------------------|
| AP-DDTR320/200 | 200 | 200 | 1,20 | 3,673 |
| AP-DDTR325/200 | 250 | 200 | 1,20 | 3,955 |
| AP-DDTR330/200 | 300 | 200 | 1,50 | 5,356 |

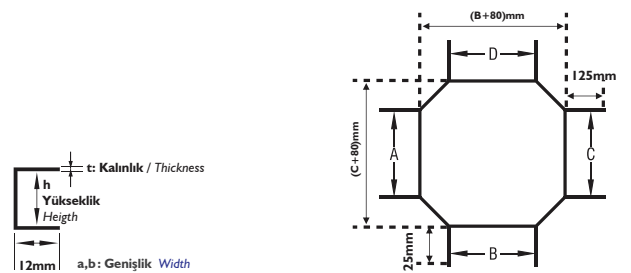
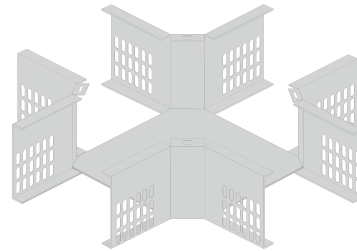
TRUNKING TİP DÖRTLÜ BAĞLANTILAR
 TRUNKING TYPE CROSSINGS

AÇIKLAMALAR / INSTRUCTIONS :

NOT: Ölçü toleransı ± 3 mm.'dir.

! Belirtilen ağırlıklar kesim ağırlıklarıdır.

NOTE: The dimension tolerance in ± 3 mm

! The indicated weights are the weights before fabrication.

AÇIKLAMALAR / INSTRUCTIONS : Ekstra / Extra

Tüm dönüş uygulamaları, Metrik 8 civata ve somun kullanımına uygundur.
 Belirtilen ağırlıklar kesim ağırlıklarıdır.

All the bend implementation are convenient for M8 bolt and Nut usage.
 The indicated weights are the weights before fabrication.

| Sipariş Kodu (Order Code) | w (mm) | h (mm) | t (mm) | Kg/Adet (Kg/Pcs.) |
|------------------------------|-----------|-----------|-----------|----------------------|
| AP-BTR520/200 | 200 | 200 | 1,20 | 3,203 |
| AP-BTR525/200 | 250 | 200 | 1,20 | 3,438 |
| AP-BTR530/200 | 300 | 200 | 1,20 | 3,674 |

➤ AÇIKLAMALAR / INSTRUCTIONS :

NOT: Ölçü toleransı ± 3 mm.'dir.

! Belirtilen ağırlıklar kesim ağırlıktır.

NOTE: The dimension tolerance in ± 3 mm

! The indicated weights are the weights before fabrication.

| Sipariş Kodu (Order Code) | w (mm) | h (mm) | t (mm) | Kg/Adet (Kg/Pcs.) |
|------------------------------|-----------|-----------|-----------|----------------------|
| AP-BTR620/200 | 200 | 200 | 1,20 | 3,014 |
| AP-BTR625/200 | 250 | 200 | 1,20 | 3,203 |
| AP-BTR630/200 | 300 | 200 | 1,20 | 3,391 |

➤ AÇIKLAMALAR / INSTRUCTIONS :

NOT: Ölçü toleransı ± 3 mm.'dir.

! Belirtilen ağırlıklar kesim ağırlıktır.

NOTE: The dimension tolerance in ± 3 mm

! The indicated weights are the weights before fabrication.

| Sipariş Kodu (Order Code) | w (mm) | h (mm) | t (mm) | Kg/Adet (Kg/Pcs.) |
|------------------------------|-----------|-----------|-----------|----------------------|
| AP-TRSEAH20 | 195 | 200 | 1,20 | 0,593 |
| AP-TRSEAH25 | 245 | 200 | 1,20 | 0,688 |
| AP-TRSEAH30 | 295 | 200 | 1,20 | 0,782 |

➤ AÇIKLAMALAR / INSTRUCTIONS :

NOT: Ölçü toleransı ± 3 mm.'dir.

! Belirtilen ağırlıklar kesim ağırlıktır.

NOTE: The dimension tolerance in ± 3 mm

! The indicated weights are the weights before fabrication.

TRUNKING İÇ BÜKEY DÖNÜŞ ELEMANLARI
TRUNKING INTERNAL BEND ELEMENTS

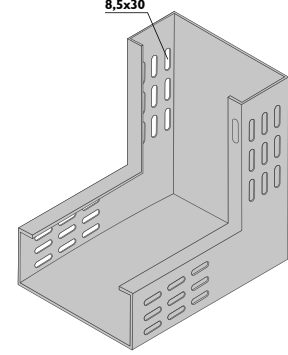
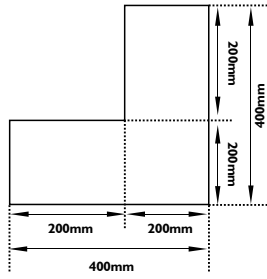
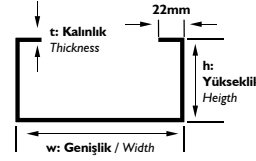

TRUNKING DIŞ BÜKEY DÖNÜŞ ELEMANLARI
TRUNKING EXTERNAL BEND ELEMENTS

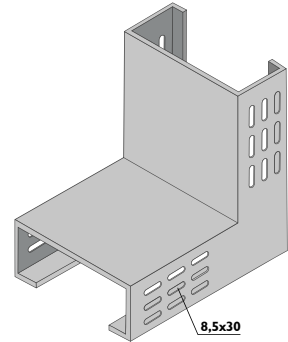
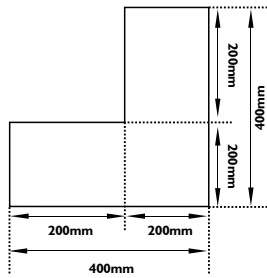
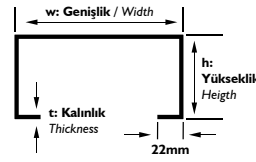

SONLANDIRMA
END CAP

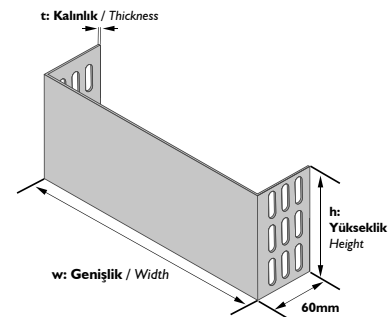

| Sipariş Kodu (Order Code) | w (mm) | h (mm) | t (mm) | Kg/Takım (Kg/Set) |
|------------------------------|-----------|-----------|-----------|----------------------|
| AP-TRZEAH1-50 | 50 | 200 | 1,50 | 0,969 |
| AP-TRZEAH-100 | 100 | 200 | 1,50 | 1,087 |

SOLA / LEFT

Z TİPİ REDÜKSİYONLAR SOLA
Z TYPE REDUCERS LEFT

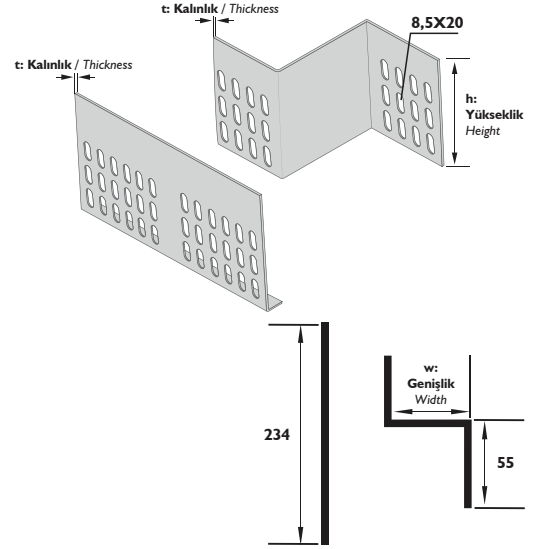
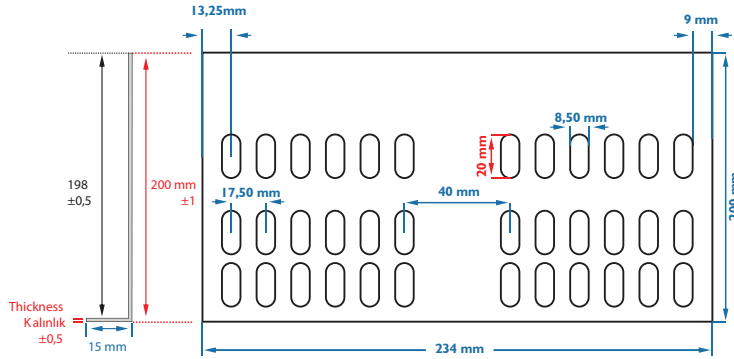

| Sipariş Kodu (Order Code) | w (mm) | h (mm) | t (mm) | Kg/Takım (Kg/Set) |
|------------------------------|-----------|-----------|-----------|----------------------|
| AP-TRZEAH1-50 | 50 | 200 | 1,50 | 0,969 |
| AP-TRZEAH-100 | 100 | 200 | 1,50 | 1,087 |

SAĞA / RIGHT

Z TİPİ REDÜKSİYONLAR SAĞA
Z TYPE REDUCERS RIGHT

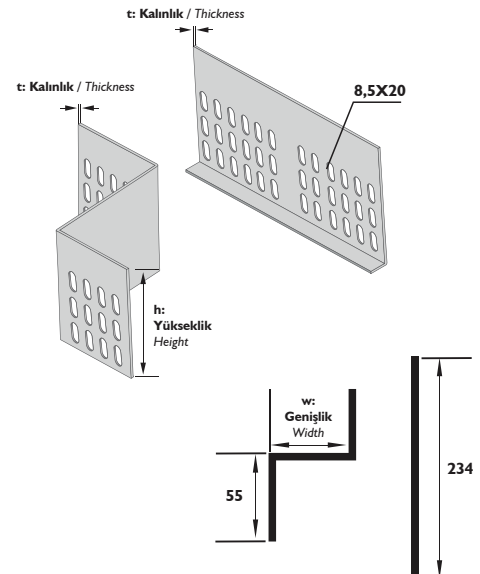
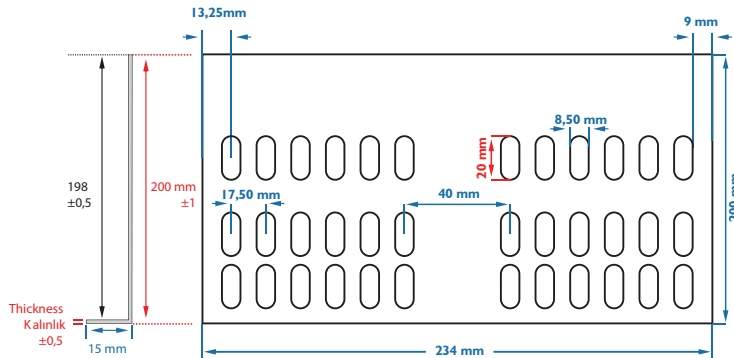

| Sipariş Kodu (Order Code) | w (mm) | h (mm) | t (mm) | Kg/Takım (Kg/Set) |
|------------------------------|-----------|-----------|-----------|----------------------|
| AP-TRZEAH2-25 | 25 | 200 | 1,50 | 0,636 |
| AP-TRZEAH2-50 | 50 | 200 | 1,50 | 0,754 |

ORTADAN / CENTER

Z TİPİ REDÜKSİYONLAR ORTADAN
Z TYPE REDUCERS CENTER

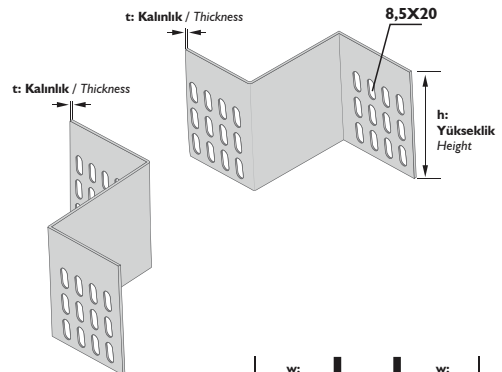

► AÇIKLAMALAR / INSTRUCTIONS :

NOT: Lütfen siparişlerinizde redüksiyon tipini ve "w" ölçüsünü belirtiniz.

! Özel ölçüler için lütfen 0850 300 00 00 ile irtibata geçiniz.

! Metrik 8 civata ve somun kullanımına uygundur. Belirtilen ağırlıklar kesim ağırlıklarıdır.

NOTE: Please assert the reduction type and "w" dimension.

! For special dimensions please contact our 0850 300 00 00

! M8 bolt and Nut usage. The indicated weights are the weights before fabrication.

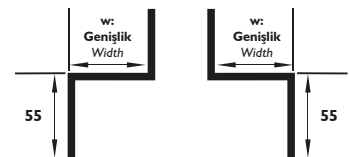

| Sipariş Kodu (Order Code) | w (mm) | h (mm) | t (mm) | Kg/Mt (Kg/Mt) |
|------------------------------|-----------|-----------|-----------|------------------|
| AP-TR25.12/250 | 250 | 250 | 1,20 | 7,423 |
| AP-TR25.15/250 | 250 | 250 | 1,50 | 9,279 |
| AP-TR25.20/250 | 250 | 250 | 2,00 | 11,134 |
| AP-TR30.12/250 | 300 | 250 | 1,20 | 7,894 |
| AP-TR30.15/250 | 300 | 250 | 1,50 | 9,867 |
| AP-TR30.20/250 | 300 | 250 | 2,00 | 11,841 |

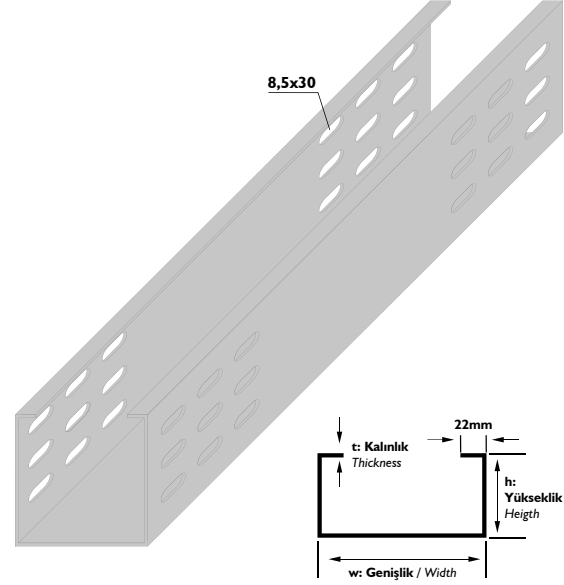

➤ AÇIKLAMALAR / INSTRUCTIONS :

NOT: Standart uzunluk 2500mm. İsteğe bağlı olarak uzunluklar değişebilir.

! Trunking'lerde ölçü toleransı ± 3 mm.'dir.

! Belirtilen ağırlıklar kesim ağırlıklarıdır.

! Trunking'ler, Metrik 6, 8 civata ve somun kullanımına uygundur.

NOTE: Standart Length is 2500mm. On request the Lengths can change.

! The dimension tolerance in Trunking is ± 3 mm.

! The indicated weights are the weights before fabrication.

! All the Trunkings are convenient for M8 bolt and nut usage.

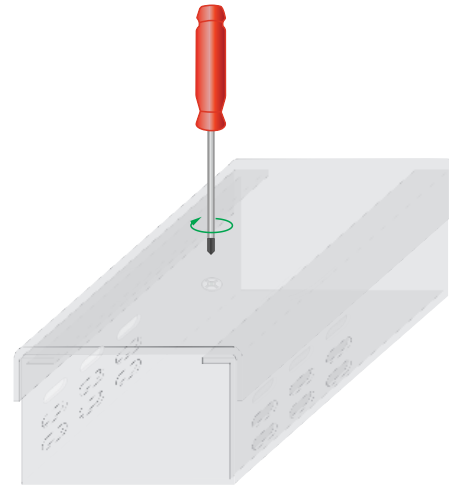

| Sipariş Kodu (Order Code) | w (mm) | h (mm) | t (mm) | L (mm) | Kg/Adet (Kg/Pcs.) |
|------------------------------|-----------|-----------|-----------|-----------|----------------------|
| AP-AI-25.15 | 15 | 252 | 1,50 | 234 | 0,730 |

EK ELEMANI JOINT PIECE

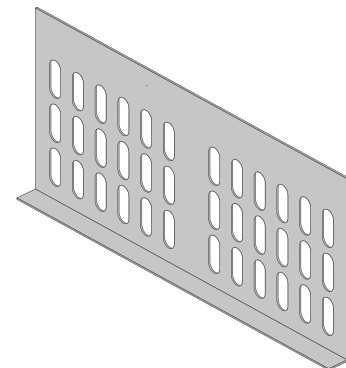
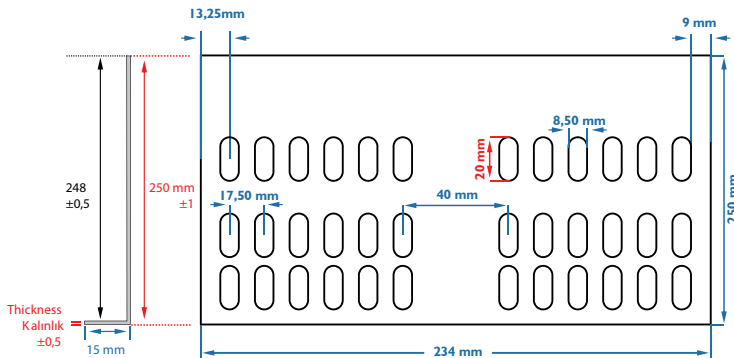

➤ AÇIKLAMALAR / INSTRUCTIONS :

NOT: Ölçü toleransı ± 3 mm.'dir.

! Belirtilen ağırlıklar kesim ağırlıklarıdır.

! Metrik 8 civata ve somun kullanımına uygundur.

NOTE: The dimension tolerance in perforated cable trays is ± 3 mm

! The indicated weights are the weights before fabrication.

! Convenient for M8 bolt and nut usage.

| Sipariş Kodu (Order Code) | a, b (mm) | h (mm) | t (mm) | Kg/Adet (Kg/Pcs.) |
|------------------------------|--------------|-----------|-----------|----------------------|
| AP-YDTR125/250 | 250 | 250 | 1,20 | 4,110 |
| AP-YDTR130/250 | 300 | 250 | 1,50 | 5,869 |

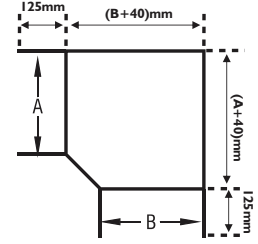
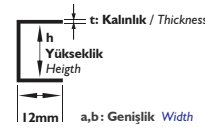
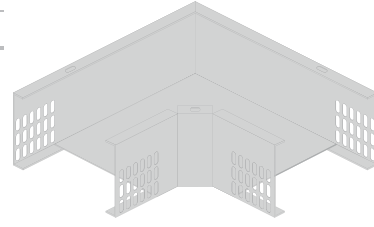
TRUNKING 90° DÖNÜŞ ELEMANLARI
TRUNKING TYPE 90° BENDS

► AÇIKLAMALAR / INSTRUCTIONS :
NOT: Ölçü toleransı ± 3 mm.'dir.

! Belirtilen ağırlıklar kesim ağırlıklarıdır.

NOTE: The dimension tolerance in ± 3 mm

! The indicated weights are the weights before fabrication.

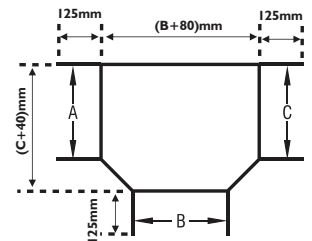
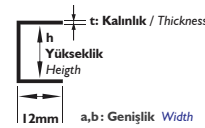
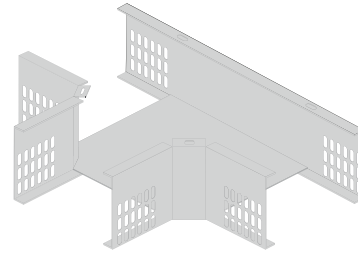
| Sipariş Kodu (Order Code) | a, b, c (mm) | h (mm) | t (mm) | Kg/Adet (Kg/Pcs.) |
|------------------------------|-----------------|-----------|-----------|----------------------|
| AP-TDTR225/250 | 250 | 250 | 1,20 | 4,447 |
| AP-TDTR230/250 | 300 | 250 | 1,50 | 6,145 |

TRUNKING TİP T DÖNÜŞ ELEMANLARI
TRUNKING TYPE TEE-BRANCHES

► AÇIKLAMALAR / INSTRUCTIONS :
NOT: Ölçü toleransı ± 3 mm.'dir.

! Belirtilen ağırlıklar kesim ağırlıklarıdır.

NOTE: The dimension tolerance in ± 3 mm

! The indicated weights are the weights before fabrication.

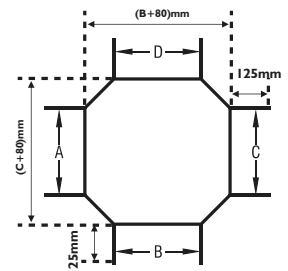
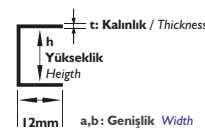
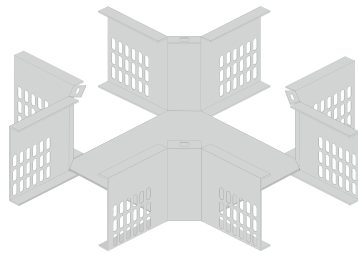
| Sipariş Kodu (Order Code) | a, b, c, d (mm) | h (mm) | t (mm) | Kg/Adet (Kg/Pcs.) |
|------------------------------|--------------------|-----------|-----------|----------------------|
| AP-DDTR325/250 | 250 | 250 | 1,20 | 4,558 |
| AP-DDTR330/250 | 300 | 250 | 1,50 | 6,110 |

TRUNKING TİP DÖRTLÜ BAĞLANTILAR
TRUNKING TYPE CROSSINGS

► AÇIKLAMALAR / INSTRUCTIONS :
NOT: Ölçü toleransı ± 3 mm.'dir.

! Belirtilen ağırlıklar kesim ağırlıklarıdır.

NOTE: The dimension tolerance in ± 3 mm

! The indicated weights are the weights before fabrication.

AÇIKLAMALAR / INSTRUCTIONS : Ekstra / Extra

 Tüm dönüş uygulamaları, Metrik 8 civata ve somun kullanımına uygundur.
 Belirtilen ağırlıklar kesim ağırlıklarıdır.

 All the bend implementation are convenient for M8 bolt and Nut usage.
 The indicated weights are the weights before fabrication.

| Sipariş Kodu (Order Code) | w (mm) | h (mm) | t (mm) | Kg/Adet (Kg/Pcs.) |
|------------------------------|-----------|-----------|-----------|----------------------|
| AP-BTRS25/250 | 250 | 250 | 1,20 | 3,909 |
| AP-BTRS30/250 | 300 | 250 | 1,20 | 4,145 |

➤ AÇIKLAMALAR / INSTRUCTIONS :

NOT: Ölçü toleransı ± 3 mm.'dir.

! Belirtilen ağırlıklar kesim ağırlıklarıdır.

NOTE: The dimension tolerance in ± 3 mm

! The indicated weights are the weights before fabrication.

| Sipariş Kodu (Order Code) | w (mm) | h (mm) | t (mm) | Kg/Adet (Kg/Pcs.) |
|------------------------------|-----------|-----------|-----------|----------------------|
| AP-BTR625/250 | 250 | 250 | 1,20 | 3,674 |
| AP-BTR630/250 | 300 | 250 | 1,20 | 3,862 |

➤ AÇIKLAMALAR / INSTRUCTIONS :

NOT: Ölçü toleransı ± 3 mm.'dir.

! Belirtilen ağırlıklar kesim ağırlıklarıdır.

NOTE: The dimension tolerance in ± 3 mm

! The indicated weights are the weights before fabrication.

| Sipariş Kodu (Order Code) | w (mm) | h (mm) | t (mm) | Kg/Adet (Kg/Pcs.) |
|------------------------------|-----------|-----------|-----------|----------------------|
| AP-TRSEAH25 | 245 | 250 | 1,20 | 0,860 |
| AP-TRSEAH30 | 295 | 250 | 1,20 | 0,977 |

➤ AÇIKLAMALAR / INSTRUCTIONS :

NOT: Ölçü toleransı ± 3 mm.'dir.

! Belirtilen ağırlıklar kesim ağırlıklarıdır.

NOTE: The dimension tolerance in ± 3 mm

! The indicated weights are the weights before fabrication.

TRUNKING İÇ BÜKEY DÖNÜŞ ELEMANLARI
TRUNKING INTERNAL BEND ELEMENTS

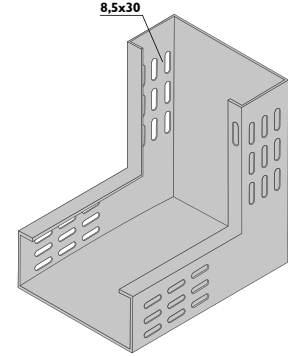
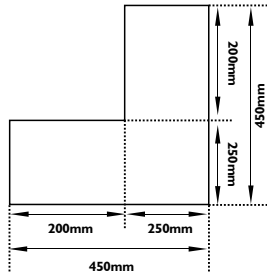
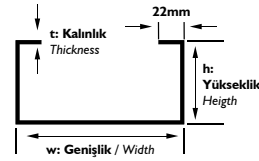

TRUNKING DIŞ BÜKEY DÖNÜŞ ELEMANLARI
TRUNKING EXTERNAL BEND ELEMENTS

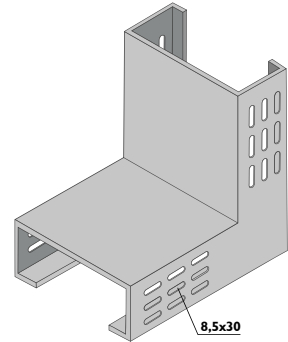
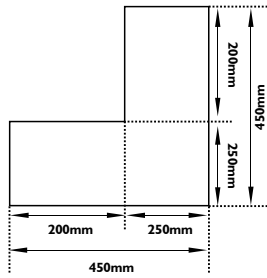
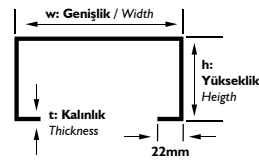

SONLANDIRMA
END CAP

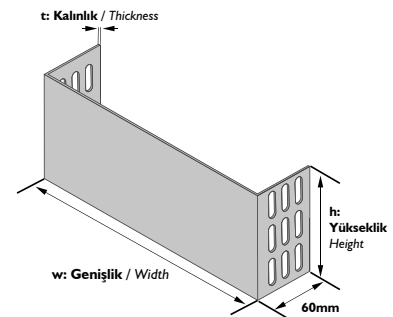

| Sipariş Kodu (Order Code) | w (mm) | h (mm) | t (mm) | Kg/Takım (Kg/Set) |
|------------------------------|-----------|-----------|-----------|----------------------|
| AP-TRZEAHI-50 | 50 | 250 | 1,50 | 1,201 |

SOLA / LEFT

Z TİPİ REDÜKSİYONLAR SOLA
Z TYPE REDUCERS LEFT

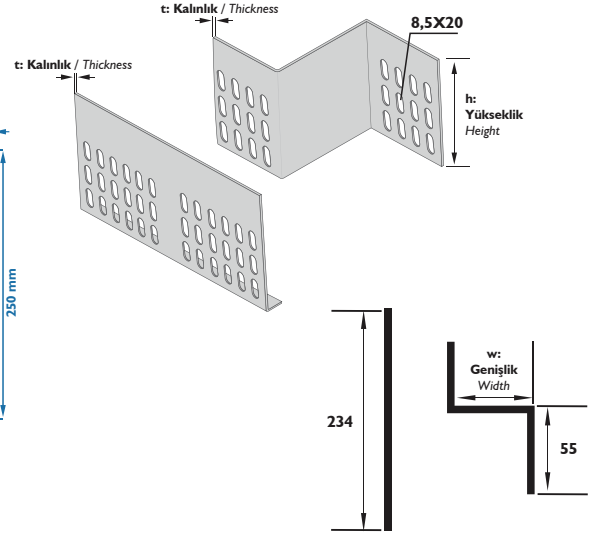
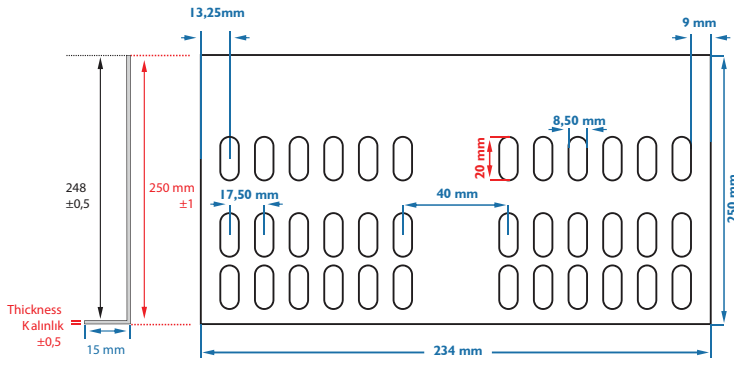

| Sipariş Kodu (Order Code) | w (mm) | h (mm) | t (mm) | Kg/Takım (Kg/Set) |
|------------------------------|-----------|-----------|-----------|----------------------|
| AP-TRZEAHI-50 | 50 | 250 | 1,50 | 1,201 |

SAĞA / RIGHT

Z TİPİ REDÜKSİYONLAR SAĞA
Z TYPE REDUCERS RIGHT

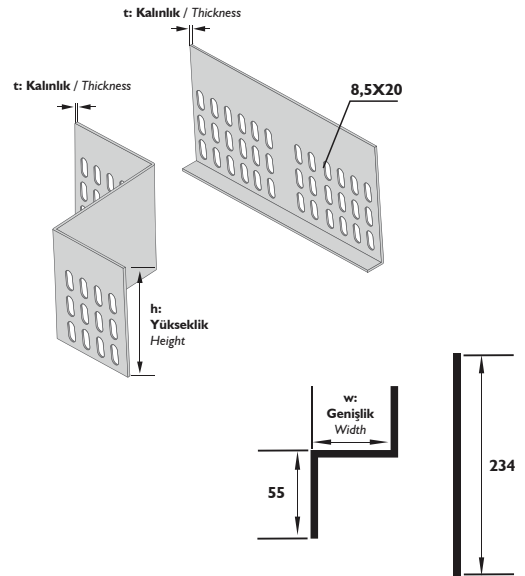
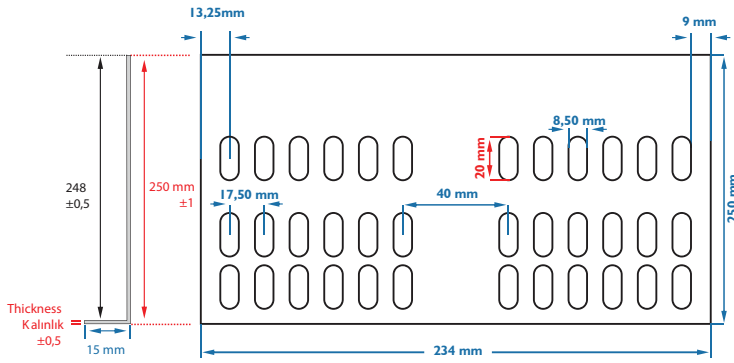

| Sipariş Kodu (Order Code) | w (mm) | h (mm) | t (mm) | Kg/Takım (Kg/Set) |
|------------------------------|-----------|-----------|-----------|----------------------|
| AP-TRZEAH2-25 | 25 | 250 | 1,50 | 0,795 |

ORTADAN / CENTER

Z TİPİ REDÜKSİYONLAR ORTADAN
Z TYPE REDUCERS CENTER

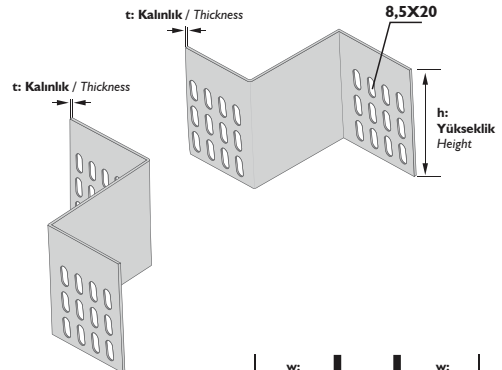

- **AÇIKLAMALAR / INSTRUCTIONS :**
- NOT:** Lütfen siparişlerinizde redüksiyon tipini ve "w" ölçüsünü belirtiniz.
- ! Özel ölçüler için lütfen 0850 300 00 00 ile irtibata geçiniz.
- ! Metrik 8 civata ve somun kullanımına uygundur. Belirtilen ağırlıklar kesim ağırlıklarıdır.
- NOTE:** Please assert the reduction type and "w" dimension.
- ! For special dimensions please contact our 0850 300 00 00
- ! M8 bolt and Nut usage. The indicated weights are the weights before fabrication.

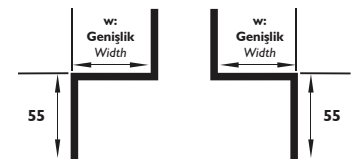

| Sipariş Kodu (Order Code) | w (mm) | h (mm) | t (mm) | Kg/Mt (Kg/Mt) |
|------------------------------|-----------|-----------|-----------|------------------|
| AP-TR30.12/300 | 300 | 300 | 1,20 | 8,836 |
| AP-TR30.15/300 | 300 | 300 | 1,50 | 11,045 |
| AP-TR30.20/300 | 300 | 300 | 2,00 | 13,254 |

TRUNKING

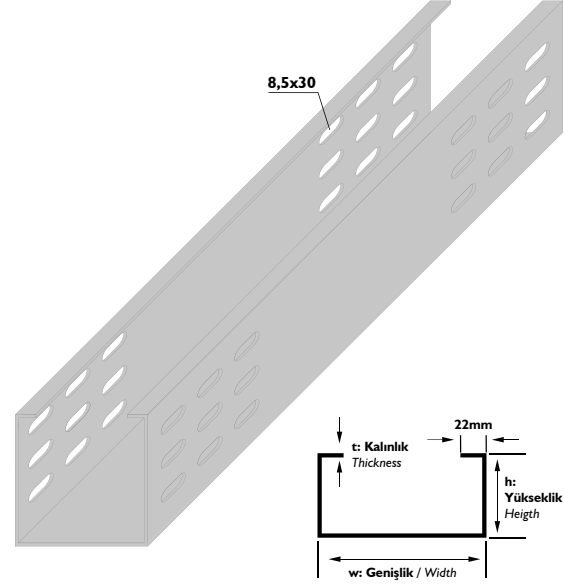

➤ **ACIKLAMALAR / INSTRUCTIONS :**

NOT: Standart uzunluk 2500mm. İsteğe bağlı olarak uzunluklar değişebilir.

! Trunking'lerde ölçü toleransı ± 3 mm.'dir.

! Belirtilen ağırlıklar kesim ağırlıklarıdır.

! Trunking'ler, Metrik 6, 8 cıvata ve somun kullanımına uygundur.

NOTE: Standart Length is 2500mm. On request the Lengths can change.

! The dimension tolerance in Trunking is ± 3 mm.

! The indicated weights are the weights before fabrication.

! All the Trunkings are convenient for M8 bolt and nut usage.

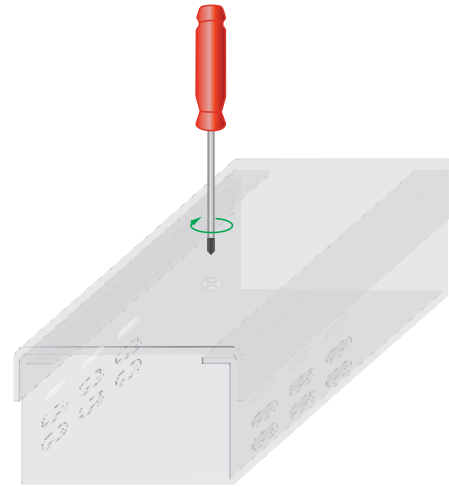

| Sipariş Kodu (Order Code) | w (mm) | h (mm) | t (mm) | L (mm) | Kg/Adet (Kg/Pcs.) |
|------------------------------|-----------|-----------|-----------|-----------|----------------------|
| AP-AI-30.15 | 15 | 300 | 1,50 | 234 | 0,868 |

EK ELEMANI
JOINT PIECE

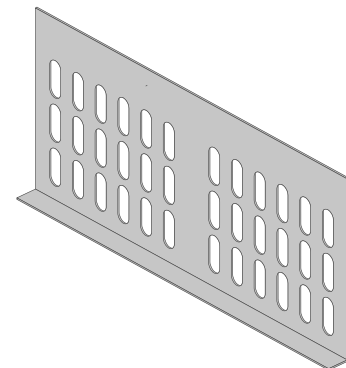
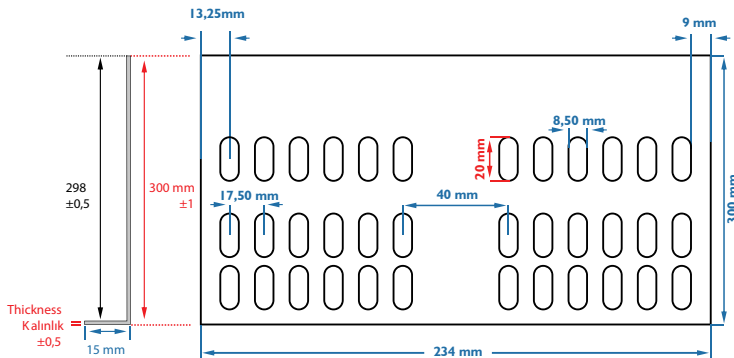

➤ **ACIKLAMALAR / INSTRUCTIONS :**

NOT: Ölçü toleransı ± 3 mm.'dir.

! Belirtilen ağırlıklar kesim ağırlıklarıdır.

! Metrik 8 cıvata ve somun kullanımına uygundur.

NOTE: The dimension tolerance in perforated cable trays is ± 3 mm

! The indicated weights are the weights before fabrication.

! Convenient for M8 bolt and nut usage.

| Sipariş Kodu (Order Code) | a, b (mm) | h (mm) | t (mm) | Kg/Adet (Kg/Pcs.) |
|------------------------------|--------------|-----------|-----------|----------------------|
| AP-YDTR130/300 | 300 | 300 | 1,50 | 6,617 |

TRUNKING 90° DÖNÜŞ ELEMANLARI
TRUNKING TYPE 90° BENDS

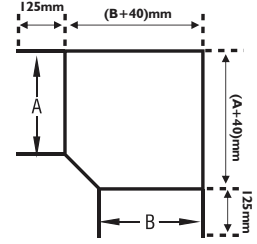
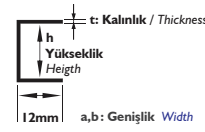
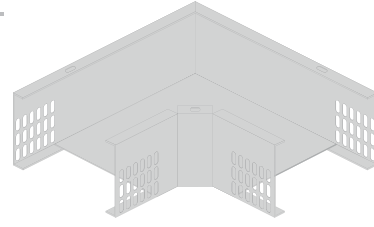

► AÇIKLAMALAR / INSTRUCTIONS :

NOT: Ölçü toleransı ± 3 mm.'dir.

! Belirtilen ağırlıklar kesim ağırlıklarıdır.

NOTE: The dimension tolerance in ± 3 mm

! The indicated weights are the weights before fabrication.

| Sipariş Kodu (Order Code) | a, b, c (mm) | h (mm) | t (mm) | Kg/Adet (Kg/Pcs.) |
|------------------------------|-----------------|-----------|-----------|----------------------|
| AP-TDTR230/300 | 300 | 300 | 1,50 | 6,904 |

TRUNKING TİP T DÖNÜŞ ELEMANLARI
TRUNKING TYPE TEE-BRANCHES

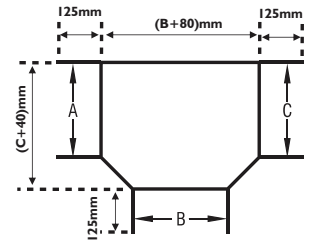
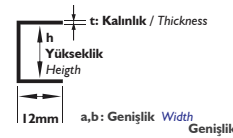
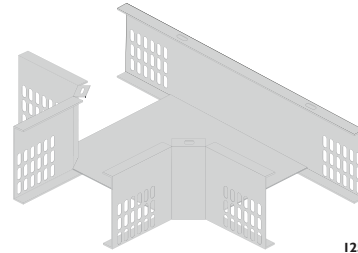

► AÇIKLAMALAR / INSTRUCTIONS :

NOT: Ölçü toleransı ± 3 mm.'dir.

! Belirtilen ağırlıklar kesim ağırlıklarıdır.

NOTE: The dimension tolerance in ± 3 mm

! The indicated weights are the weights before fabrication.

| Sipariş Kodu (Order Code) | a, b, c, d (mm) | h (mm) | t (mm) | Kg/Adet (Kg/Pcs.) |
|------------------------------|--------------------|-----------|-----------|----------------------|
| AP-DDTR330/300 | 300 | 300 | 1,50 | 6,863 |

TRUNKING TİP DÖRTLÜ BAĞLANTILAR
TRUNKING TYPE CROSSINGS

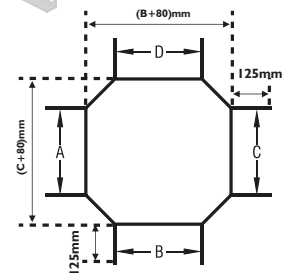
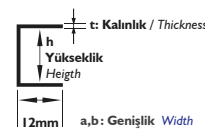
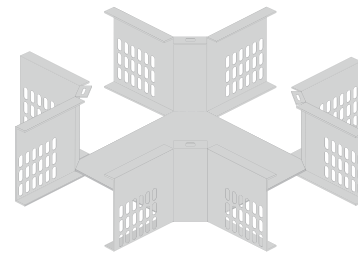

► AÇIKLAMALAR / INSTRUCTIONS :

NOT: Ölçü toleransı ± 3 mm.'dir.

! Belirtilen ağırlıklar kesim ağırlıklarıdır.

NOTE: The dimension tolerance in ± 3 mm

! The indicated weights are the weights before fabrication.

AÇIKLAMALAR / INSTRUCTIONS : Ekstra / Extra

Tüm dönüş uygulamaları, Metrik 8 civata ve somun kullanımına uygundur.
Belirtilen ağırlıklar kesim ağırlıklarıdır.

All the bend implementation are convenient for M8 bolt and Nut usage.
The indicated weights are the weights before fabrication.

| Sipariş Kodu (Order Code) | w (mm) | h (mm) | t (mm) | Kg/Adet (Kg/Pcs.) |
|------------------------------|-----------|-----------|-----------|----------------------|
| AP-BTR530/300 | 300 | 300 | 1,20 | 4,616 |

TRUNKING İÇ BÜKEY DÖNÜŞ ELEMANLARI
TRUNKING INTERNAL BEND ELEMENTS

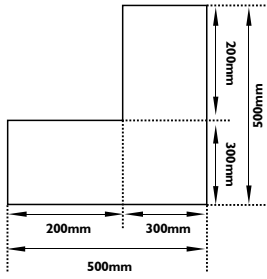
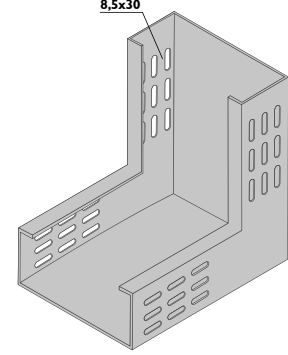
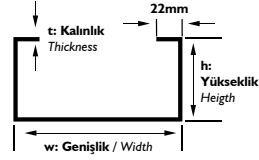

➤ AÇIKLAMALAR / INSTRUCTIONS :

NOT: Ölçü toleransı ± 3 mm.'dir.

! Belirtilen ağırlıklar kesim ağırlıktır.

NOTE: The dimension tolerance in ± 3 mm

! The indicated weights are the weights before fabrication.

| Sipariş Kodu (Order Code) | w (mm) | h (mm) | t (mm) | Kg/Adet (Kg/Pcs.) |
|------------------------------|-----------|-----------|-----------|----------------------|
| AP-BTR630/300 | 300 | 300 | 1,20 | 4,333 |

TRUNKING DIŞ BÜKEY DÖNÜŞ ELEMANLARI
TRUNKING EXTERNAL BEND ELEMENTS

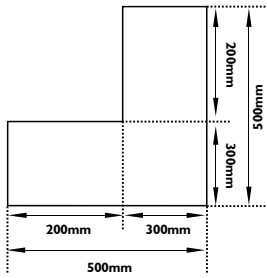
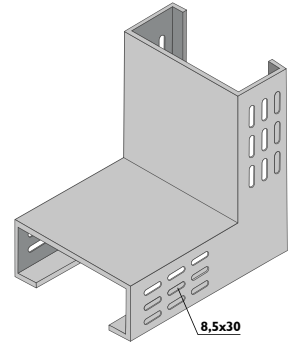
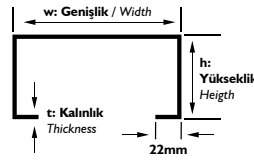

➤ AÇIKLAMALAR / INSTRUCTIONS :

NOT: Ölçü toleransı ± 3 mm.'dir.

! Belirtilen ağırlıklar kesim ağırlıktır.

NOTE: The dimension tolerance in ± 3 mm

! The indicated weights are the weights before fabrication.

| Sipariş Kodu (Order Code) | w (mm) | h (mm) | t (mm) | Kg/Adet (Kg/Pcs.) |
|------------------------------|-----------|-----------|-----------|----------------------|
| AP-TRSEAH30 | 295 | 300 | 1,20 | 1,173 |

SONLANDIRMA
END CAP

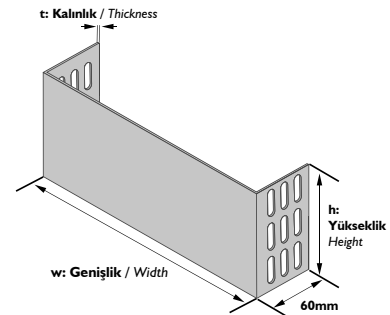

➤ AÇIKLAMALAR / INSTRUCTIONS :

NOT: Ölçü toleransı ± 3 mm.'dir.

! Belirtilen ağırlıklar kesim ağırlıktır.

NOTE: The dimension tolerance in ± 3 mm

! The indicated weights are the weights before fabrication.

| Sipariş Kodu (Order Code) | w (mm) | h (mm) | t (mm) | Kg/Mt (Kg/Mt) |
|------------------------------|-----------|-----------|-----------|------------------|
| AP-TR05K | 50 | 10 | 1,20 | 0,697 |
| AP-TR07K | 75 | 10 | 1,20 | 0,933 |
| AP-TR10K | 100 | 10 | 1,20 | 1,168 |
| AP-TR12K | 125 | 10 | 1,20 | 1,404 |
| AP-TR15K | 150 | 10 | 1,20 | 1,639 |
| AP-TR20K | 200 | 10 | 1,20 | 2,110 |
| AP-TR25K | 250 | 10 | 1,20 | 2,581 |
| AP-TR30K | 300 | 10 | 1,20 | 3,052 |

TRUNKING KAPAK / COVERS

AÇIKLAMALAR / INSTRUCTIONS :

NOT: Standart uzunluk 2500mm. İsteğe bağlı olarak uzunluklar değişebilir.

! Trunking kapaklarda ölçü toleransı ± 3 mm.'dir.

! Belirtilen ağırlıklar kesim ağırlıklarıdır.

! Trunking'ler, Metrik 6, 8 civata ve somun kullanımına uygundur.

NOTE: Standart Length is 2500mm. On request the Lengths can change.

! The dimension tolerance in Trunking Covers is ± 3 mm.

! The indicated weights are the weights before fabrication.

! All the Trunkings are convenient for M6-8 bolt and nut usage.

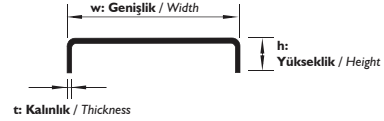

| Sipariş Kodu (Order Code) | w (mm) | h (mm) | t (mm) | Kg/Adet (Kg/Pcs.) |
|------------------------------|-----------|-----------|-----------|----------------------|
| AP-BTR505K | 50 | 10 | 1,20 | 0,279 |
| AP-BTR507K | 75 | 10 | 1,20 | 0,373 |
| AP-BTR510K | 100 | 10 | 1,20 | 0,467 |
| AP-BTR512K | 125 | 10 | 1,20 | 0,561 |
| AP-BTR515K | 150 | 10 | 1,20 | 0,656 |
| AP-BTR520K | 200 | 10 | 1,20 | 0,844 |
| AP-BTR525K | 250 | 10 | 1,20 | 1,032 |
| AP-BTR530K | 300 | 10 | 1,20 | 1,221 |

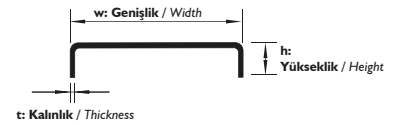
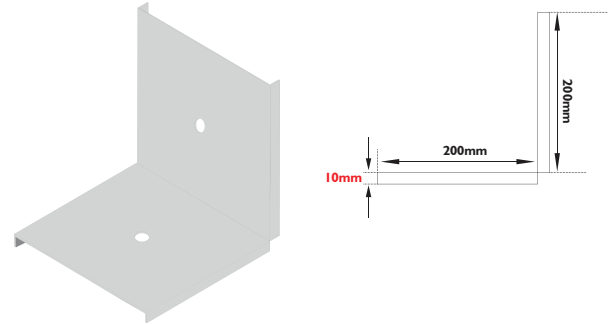
TRUNKING İÇ BÜKEY DÖNÜŞ ELEMAN KAPAKLARI
TRUNKING INTERNAL BEND ELEMENT COVERS

AÇIKLAMALAR / INSTRUCTIONS :

NOT: Ölçü toleransı ± 3 mm.'dir.

! Belirtilen ağırlıklar kesim ağırlıklarıdır.

NOTE: The dimension tolerance in ± 3 mm

! The indicated weights are the weights before fabrication.

| Sipariş Kodu (Order Code) | w (mm) | h (mm) | t (mm) | L (mm) | Kg/Adet (Kg/Pcs.) |
|------------------------------|-----------|-----------|-----------|-----------|----------------------|
| AP-BTR605K | 50 | 10 | 1,20 | 250 | 0,349 |
| AP-BTR607K | 75 | 10 | 1,20 | 275 | 0,513 |
| AP-BTR610K | 100 | 10 | 1,20 | 300 | 0,701 |
| AP-BTR612K | 125 | 10 | 1,20 | 325 | 0,912 |
| AP-BTR615K | 150 | 10 | 1,20 | 350 | 1,147 |
| AP-BTR620K | 200 | 10 | 1,20 | 400 | 1,688 |
| AP-BTR625K | 250 | 10 | 1,20 | 450 | 2,323 |
| AP-BTR630K | 300 | 10 | 1,20 | 500 | 3,052 |

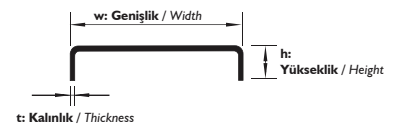
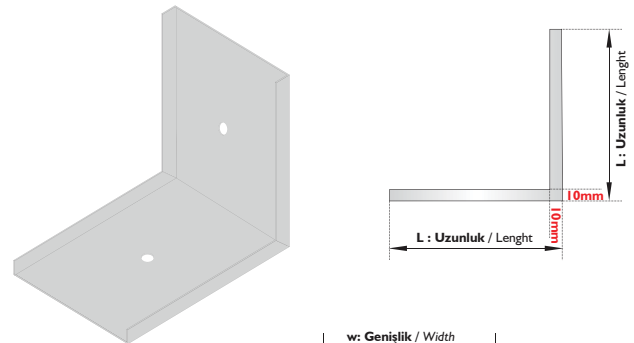
TRUNKING DIŞ BÜKEY DÖNÜŞ ELEMAN KAPAKLARI
TRUNKING EXTERNAL BEND ELEMENT COVERS

AÇIKLAMALAR / INSTRUCTIONS :

NOT: Ölçü toleransı ± 3 mm.'dir.

! Belirtilen ağırlıklar kesim ağırlıklarıdır.

NOTE: The dimension tolerance in ± 3 mm

! The indicated weights are the weights before fabrication.

| Sipariş Kodu (Order Code) | a, b (mm) | h (mm) | t (mm) | Kg/Adet (Kg/Pcs.) |
|------------------------------|--------------|-----------|-----------|----------------------|
| AP-YDTR105K | 54 | 10 | 1,20 | 0,125 |
| AP-YDTR107K | 79 | 10 | 1,20 | 0,173 |
| AP-YDTR110K | 104 | 10 | 1,20 | 0,257 |
| AP-YDTR112K | 129 | 10 | 1,20 | 0,323 |
| AP-YDTR115K | 154 | 10 | 1,20 | 0,436 |
| AP-YDTR120K | 204 | 10 | 1,20 | 0,662 |
| AP-YDTR125K | 254 | 10 | 1,20 | 0,935 |
| AP-YDTR130K | 304 | 10 | 1,20 | 1,255 |

TRUNKING 90° DÖNÜŞ ELEMANI KAPAKLARI
TRUNKING TYPE 90° BEND COVERS

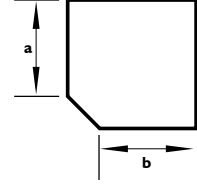
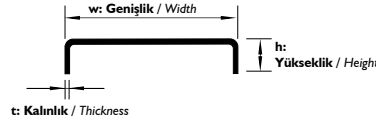
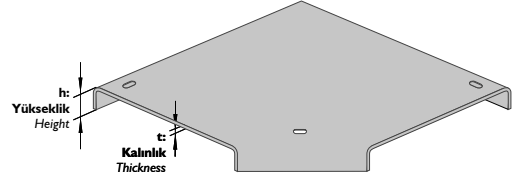

| Sipariş Kodu (Order Code) | a, b, c (mm) | h (mm) | t (mm) | Kg/Adet (Kg/Pcs.) |
|------------------------------|-----------------|-----------|-----------|----------------------|
| AP-TDTR205K | 50 | 10 | 1,20 | 0,168 |
| AP-TDTR207K | 75 | 10 | 1,20 | 0,223 |
| AP-TDTR210K | 100 | 10 | 1,20 | 0,319 |
| AP-TDTR212K | 125 | 10 | 1,20 | 0,392 |
| AP-TDTR215K | 150 | 10 | 1,20 | 0,517 |
| AP-TDTR220K | 200 | 10 | 1,20 | 0,762 |
| AP-TDTR225K | 250 | 10 | 1,20 | 1,054 |
| AP-TDTR230K | 300 | 10 | 1,20 | 1,392 |

TRUNKING T DÖNÜŞ ELEMANI KAPAKLARI
TRUNKING TYPE TEE-BRANCH COVERS

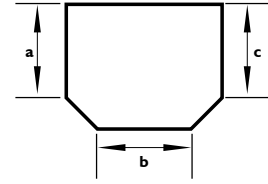
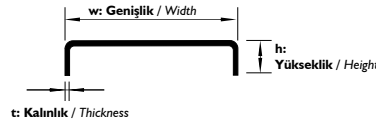
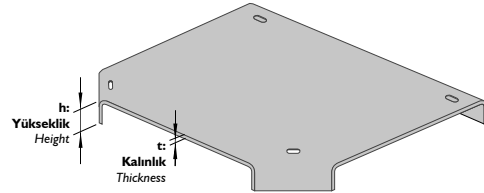

| Sipariş Kodu (Order Code) | a, b, c, d (mm) | h (mm) | t (mm) | Kg/Adet (Kg/Pcs.) |
|------------------------------|--------------------|-----------|-----------|----------------------|
| AP-DDTR305K | 50 | 10 | 1,20 | 0,227 |
| AP-DDTR307K | 75 | 10 | 1,20 | 0,289 |
| AP-DDTR310K | 100 | 10 | 1,20 | 0,396 |
| AP-DDTR312K | 125 | 10 | 1,20 | 0,478 |
| AP-DDTR315K | 150 | 10 | 1,20 | 0,613 |
| AP-DDTR320K | 200 | 10 | 1,20 | 0,877 |
| AP-DDTR325K | 250 | 10 | 1,20 | 1,188 |
| AP-DDTR330K | 300 | 10 | 1,20 | 1,546 |

TRUNKING TİP DÖRTLÜ BAĞLANTI KAPAKLARI
TRUNKING TYPE CROSSING COVERS

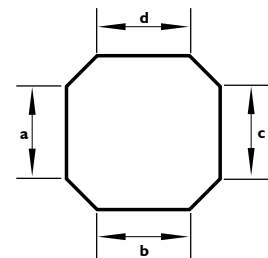
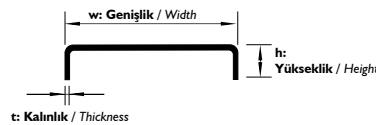
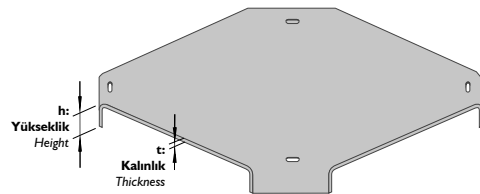

AÇIKLAMALAR / INSTRUCTIONS :

Ölçü toleransı ± 3 mm.'dir.

Belirtilen ağırlıklar kesim ağırlıklarıdır.

The dimension tolerance in ± 3 mm

The indicated weights are the weights before fabrication.

AÇIKLAMALAR / INSTRUCTIONS : Ekstra / Extra

Tüm dönüş uygulamaları, Metrik 8 civata ve somun kullanımına uygundur.
Belirtilen ağırlıklar kesim ağırlıklarıdır.

All the bend implementation are convenient for M8 bolt and Nut usage.
The indicated weights are the weights before fabrication.

