

# **DTK** Deliksiz Tip Kablo Kanalları Non-perforated Type Cable Trays

A P E X M E T A L C A B L E T R A Y S Y S T E M S

**DTK Serisi / Serie**

*ve Aksesuarlar  
and Accessories*

# DTK Deliksiz Tip Kablo Kanalları Non-perforated Type Cable Trays

Sayfa No Page No	İNDEKS / INDEX
<b>DTK 01</b>	H:40 Deliksiz Normal Tip Kablo Kanalı ve Ek Elemanı / <i>H:40 Non perforated Normal Type Cable Trays and Joint Pieces</i>
<b>DTK 02</b>	H:50 Deliksiz Normal Tip Kablo Kanalı ve Ek Elemanı / <i>H:50 Non perforated Normal Type Cable Trays and Joint Pieces</i>
<b>DTK 03</b>	H:60 Deliksiz Normal Tip Kablo Kanalı ve Ek Elemanı / <i>H:60 Non perforated Normal Type Cable Trays and Joint Pieces</i>
<b>DTK 04</b>	H:40 Deliksiz Ağır Hizmet Tipi Kablo Kanalı ve Ek Elemanı / <i>H:40 Non perforated HEAVY DUTY Type Cable Trays and Joint Pieces</i>
<b>DTK 05</b>	H:50 Deliksiz Ağır Hizmet Tipi Kablo Kanalı ve Ek Elemanı / <i>H:50 Non perforated HEAVY DUTY Type Cable Trays and Joint Pieces</i>
<b>DTK 06</b>	H:60 Deliksiz Ağır Hizmet Tipi Kablo Kanalı ve Ek Elemanı / <i>H:60 Non perforated HEAVY DUTY Type Cable Trays and Joint Pieces</i>
<b>DTK 07</b>	H:100 Deliksiz Ağır Hizmet Tipi Kablo Kanalı ve Ek Elemanı / <i>H:100 Non perforated HEAVY DUTY Type Cable Trays and Joint Pieces</i>
<b>DTK 08</b>	H:150 Deliksiz Ağır Hizmet Tipi Kablo Kanalı ve Ek Elemanı / <i>H:150 Non perforated HEAVY DUTY Type Cable Trays and Joint Pieces</i>

EN 61537

Sipariş Kodu (Order Code)	w (mm)	h (mm)	t (mm)	Kg/Mt (Kg/Mt)
AP-05D.08	50	40	0,80	0,779
AP-05D.10	50	40	1,00	0,973
AP-05D.12	50	40	1,20	1,168
AP-05D.15	50	40	1,50	1,460
AP-05D.20	50	40	2,00	1,751
AP-07D.08	70	40	0,80	0,904
AP-07D.10	70	40	1,00	1,130
AP-07D.12	70	40	1,20	1,356
AP-07D.15	70	40	1,50	1,696
AP-07D.20	70	40	2,00	2,034
AP-10D.08	100	40	0,80	1,093
AP-10D.10	100	40	1,00	1,366
AP-10D.12	100	40	1,20	1,639
AP-10D.15	100	40	1,50	2,049
AP-10D.20	100	40	2,00	2,459
AP-12D.08	120	40	0,80	1,218
AP-12D.10	120	40	1,00	1,523
AP-12D.12	120	40	1,20	1,827
AP-12D.15	120	40	1,50	2,284
AP-12D.20	120	40	2,00	2,741
AP-15D.08	150	40	0,80	1,470
AP-15D.10	150	40	1,00	1,758
AP-15D.12	150	40	1,20	2,110
AP-15D.15	150	40	1,50	2,638
AP-15D.20	150	40	2,00	3,164
AP-20D.08	200	40	0,80	1,721
AP-20D.10	200	40	1,00	2,151
AP-20D.12	200	40	1,20	2,581
AP-20D.15	200	40	1,50	3,222
AP-20D.20	200	40	2,00	3,872
AP-25D.12	250	40	1,20	3,052
AP-25D.15	250	40	1,50	3,815
AP-25D.20	250	40	2,00	4,578
AP-30D.12	300	40	1,20	3,523
AP-30D.15	300	40	1,50	4,404
AP-30D.20	300	40	2,00	5,285
AP-40D.15	400	40	1,50	5,581
AP-40D.20	400	40	2,00	6,698
AP-50D.15	500	40	1,50	6,759
AP-50D.20	500	40	2,00	8,111
AP-60D.15	600	40	1,50	7,936
AP-60D.20	600	40	2,00	9,524

DELİKSİZ NORMAL TİP KABLO KANALLARI  
NON-PERFORATED NORMAL TYPE CABLE TRAYS

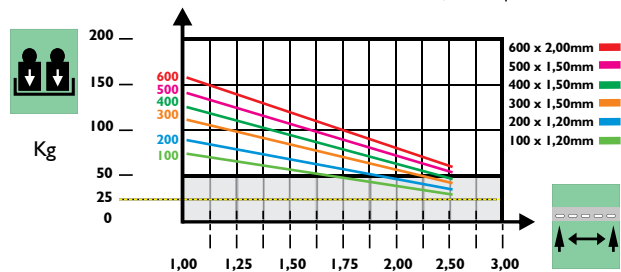
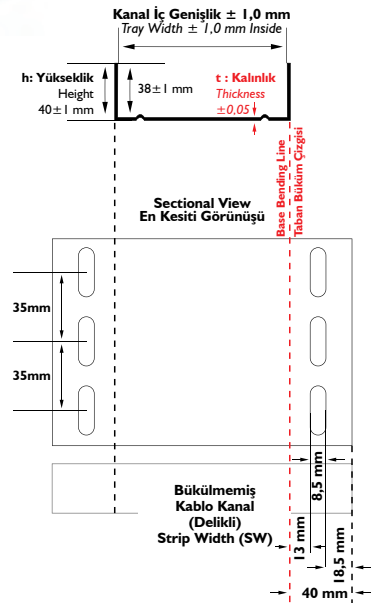

'm' Destekler Arası Mesafe  
'm' Span Between Supports

Kilogram Olarak Müsade  
Edilen Kablo Kanalı Yüklü  
Cable Tray Load in Kg

Sipariş Kodu (Order Code)	w (mm)	h (mm)	t (mm)	L (mm)	Kg/Adet (Kg/Pcs.)
AP-KNI-04.12	15	42	1,20	174	0,093

EK ELEMANI  
JOINT PIECE

► AÇIKLAMALAR / INSTRUCTIONS :

NOT: Ölçü toleransı ± 3 mm.'dir.

! Belirtilen ağırlıklar kesim ağırlıklarıdır.

! Metrik 8 civata ve somun kullanımına uygundur.

NOTE: The dimension tolerance in perforated cable trays is ± 3 mm

! The indicated weights are the weights before fabrication.

! Convenient for M8 bolt and nut usage.

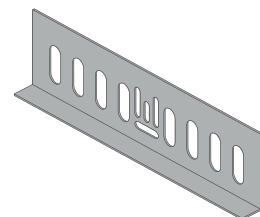
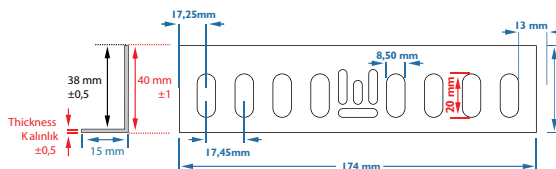

Sipariş Kodu (Order Code)	w (mm)	h (mm)	t (mm)	Kg/Mt (Kg/Mt)
AP-05DH.08	50	50	0,80	0,904
AP-05DH.10	50	50	1,00	1,130
AP-05DH.12	50	50	1,20	1,356
AP-05DH.15	50	50	1,50	1,696
AP-05DH.20	50	50	2,00	2,034
AP-07DH.08	70	50	0,80	1,030
AP-07DH.10	70	50	1,00	1,287
AP-07DH.12	70	50	1,20	1,545
AP-07DH.15	70	50	1,50	1,931
AP-07DH.20	70	50	2,00	2,317
AP-10DH.08	100	50	0,80	1,218
AP-10DH.10	100	50	1,00	1,523
AP-10DH.12	100	50	1,20	1,827
AP-10DH.15	100	50	1,50	2,284
AP-10DH.20	100	50	2,00	2,741
AP-12DH.08	120	50	0,80	1,344
AP-12DH.10	120	50	1,00	1,680
AP-12DH.12	120	50	1,20	2,016
AP-12DH.15	120	50	1,50	2,520
AP-12DH.20	120	50	2,00	3,024
AP-15DH.08	150	50	0,80	1,532
AP-15DH.10	150	50	1,00	1,915
AP-15DH.12	150	50	1,20	2,298
AP-15DH.15	150	50	1,50	2,873
AP-15DH.20	150	50	2,00	3,447
AP-20DH.08	200	50	0,80	1,846
AP-20DH.10	200	50	1,00	2,308
AP-20DH.12	200	50	1,20	2,769
AP-20DH.15	200	50	1,50	3,462
AP-20DH.20	200	50	2,00	4,154
AP-25DH.12	250	50	1,20	3,240
AP-25DH.15	250	50	1,50	4,051
AP-25DH.20	250	50	2,00	4,861
AP-30DH.12	300	50	1,20	3,711
AP-30DH.15	300	50	1,50	4,639
AP-30DH.20	300	50	2,00	5,568
AP-40DH.15	400	50	1,50	5,817
AP-40DH.20	400	50	2,00	6,980
AP-50DH.15	500	50	1,50	6,994
AP-50DH.20	500	50	2,00	8,393
AP-60DH.15	600	50	1,50	8,172
AP-60DH.20	600	50	2,00	9,806

Sipariş Kodu (Order Code)	w (mm)	h (mm)	t (mm)	L (mm)	Kg/Adet (Kg/Pcs.)
AP-KNI-05.12	15	52	1,20	174	0,110

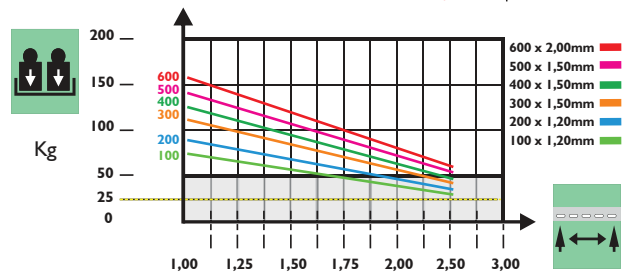
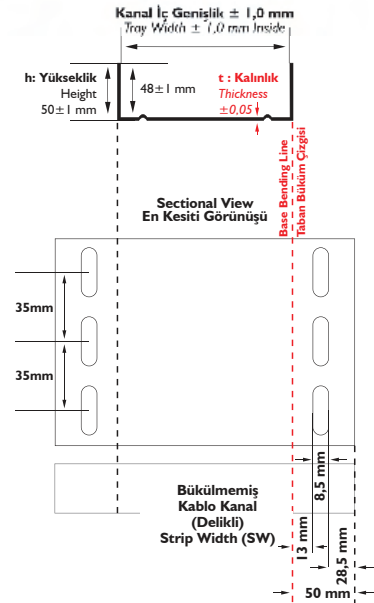
**DELİKSİZ NORMAL TİP KABLO KANALLARI**  
 NON-PERFORATED NORMAL TYPE CABLE TRAYS

 'm' Destekler Arası Mesafe  
 'm' Span Between Supports

 Kilogram Olarak Müsade  
 Edilen Kablo Kanalı Yüğü  
 Cable Tray Load in Kg

**EK ELEMANI**  
 JOINT PIECE

**AÇIKLAMALAR / INSTRUCTIONS :**

NOT: Ölçü toleransı  $\pm 3$  mm.'dir.

! Belirtilen ağırlıklar kesim ağırlıklarındadır.

! Metrik 8 civata ve somun kullanımına uygundur.

NOTE: The dimension tolerance in perforated cable trays is  $\pm 3$  mm

! The indicated weights are the weights before fabrication.

! Convenient for M8 bolt and nut usage.

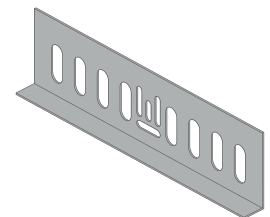
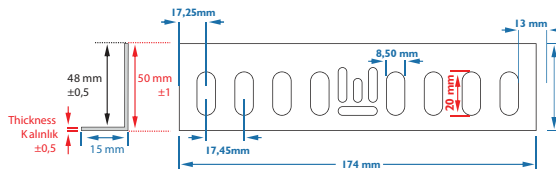

Sipariş Kodu (Order Code)	w (mm)	h (mm)	t (mm)	Kg/Mt (Kg/Mt)
AP-05DEH.08	50	60	0,80	1,030
AP-05DEH.10	50	60	1,00	1,287
AP-05DEH.12	50	60	1,20	1,545
AP-05DEH.15	50	60	1,50	1,931
AP-05DEH.20	50	60	2,00	2,317
AP-07DEH.08	70	60	0,80	1,156
AP-07DEH.10	70	60	1,00	1,444
AP-07DEH.12	70	60	1,20	1,733
AP-07DEH.15	70	60	1,50	2,167
AP-07DEH.20	70	60	2,00	2,599
AP-10DEH.08	100	60	0,80	1,344
AP-10DEH.10	100	60	1,00	1,680
AP-10DEH.12	100	60	1,20	2,016
AP-10DEH.15	100	60	1,50	2,520
AP-10DEH.20	100	60	2,00	3,024
AP-12DEH.08	120	60	0,80	1,470
AP-12DEH.10	120	60	1,00	1,837
AP-12DEH.12	120	60	1,20	2,204
AP-12DEH.15	120	60	1,50	2,755
AP-12DEH.20	120	60	2,00	3,307
AP-15DEH.08	150	60	0,80	1,658
AP-15DEH.10	150	60	1,00	2,072
AP-15DEH.12	150	60	1,20	2,487
AP-15DEH.15	150	60	1,50	3,109
AP-15DEH.20	150	60	2,00	3,730
AP-20DEH.08	200	60	0,80	1,972
AP-20DEH.10	200	60	1,00	2,465
AP-20DEH.12	200	60	1,20	2,958
AP-20DEH.15	200	60	1,50	3,697
AP-20DEH.20	200	60	2,00	4,437
AP-25DEH.12	250	60	1,20	3,429
AP-25DEH.15	250	60	1,50	4,286
AP-25DEH.20	250	60	2,00	5,144
AP-30DEH.12	300	60	1,20	3,900
AP-30DEH.15	300	60	1,50	4,875
AP-30DEH.20	300	60	2,00	5,850
AP-40DEH.15	400	60	1,50	6,052
AP-40DEH.20	400	60	2,00	7,263
AP-50DEH.15	500	60	1,50	7,230
AP-50DEH.20	500	60	2,00	8,676
AP-60DEH.20	600	60	2,00	8,408
AP-60DEH.20	600	60	2,00	10,089

DELİKSİZ NORMAL TİP KABLO KANALLARI  
NON-PERFORATED NORMAL TYPE CABLE TRAYS

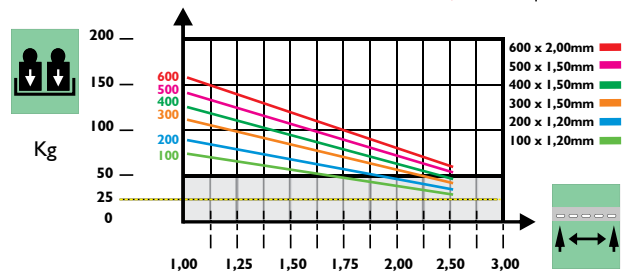
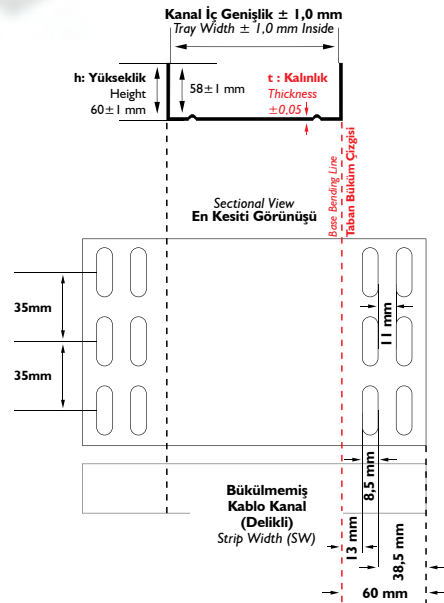

'm' Destekler Arası Mesafe  
'm' Span Between Supports

Kilogram Olarak Müsade  
Edilen Kablo Kanalı Yüğü  
Cable Tray Load in Kg

Sipariş Kodu (Order Code)	w (mm)	h (mm)	t (mm)	L (mm)	Kg/Adet (Kg/Pcs.)
AP-KN1-06.12	15	62	1,20	174	0,126

EK ELEMANI  
JOINT PIECE

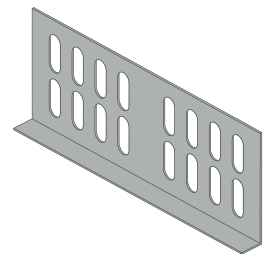

AÇIKLAMALAR / INSTRUCTIONS :	
NOT:	Ölçü toleransı ± 3 mm.'dir.
!	Belirtilen ağırlıklar kesim ağırlıktır.
!	Metrik 8 cıvata ve somun kullanımına uygundur.
NOTE:	The dimension tolerance in perforated cable trays is ± 3 mm
!	The indicated weights are the weights before fabrication.
!	Convenient for M8 bolt and nut usage.

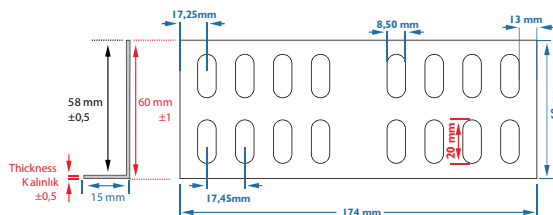

Sipariş Kodu (Order Code)	w (mm)	h (mm)	t (mm)	Kg/Mt (Kg/Mt)
AP-05DA.08	50	40	0,80	0,904
AP-05DA.10	50	40	1,00	1,130
AP-05DA.12	50	40	1,20	1,356
AP-05DA.15	50	40	1,50	1,696
AP-05DA.20	50	40	2,00	2,034
AP-07DA.08	70	40	0,80	1,030
AP-07DA.10	70	40	1,00	1,287
AP-07DA.12	70	40	1,20	1,545
AP-07DA.15	70	40	1,50	1,931
AP-07DA.20	70	40	2,00	2,317
AP-10DA.08	100	40	0,80	1,218
AP-10DA.10	100	40	1,00	1,523
AP-10DA.12	100	40	1,20	1,827
AP-10DA.15	100	40	1,50	2,284
AP-10DA.20	100	40	2,00	2,741
AP-12DA.08	120	40	0,80	1,344
AP-12DA.10	120	40	1,00	1,680
AP-12DA.12	120	40	1,20	2,016
AP-12DA.15	120	40	1,50	2,520
AP-12DA.20	120	40	2,00	3,024
AP-15DA.08	150	40	0,80	1,532
AP-15DA.10	150	40	1,00	1,915
AP-15DA.12	150	40	1,20	2,298
AP-15DA.15	150	40	1,50	2,873
AP-15DA.20	150	40	2,00	3,447
AP-20DA.08	200	40	0,80	1,846
AP-20DA.10	200	40	1,00	2,308
AP-20DA.12	200	40	1,20	2,769
AP-20DA.15	200	40	1,50	3,462
AP-20DA.20	200	40	2,00	4,154
AP-25DA.12	250	40	1,20	3,240
AP-25DA.15	250	40	1,50	4,051
AP-25DA.20	250	40	2,00	4,861
AP-30DA.12	300	40	1,20	3,711
AP-30DA.15	300	40	1,50	4,639
AP-30DA.20	300	40	2,00	5,567
AP-40DA.15	400	40	1,50	5,817
AP-40DA.20	400	40	2,00	6,980
AP-50DA.15	500	40	1,50	6,994
AP-50DA.20	500	40	2,00	8,393
AP-60DA.15	600	40	1,50	8,172
AP-60DA.20	600	40	2,00	9,806

Sipariş Kodu (Order Code)	w (mm)	h (mm)	t (mm)	L (mm)	Kg/Adet (Kg/Pcs.)
AP-KNI-04.12	15	42	1,20	174	0,093

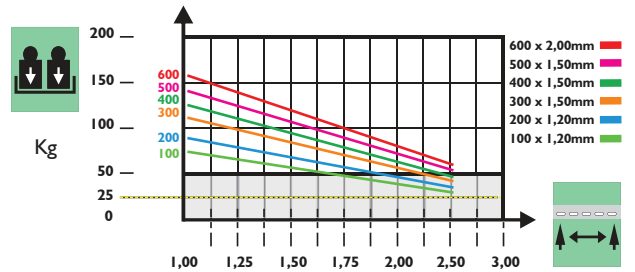
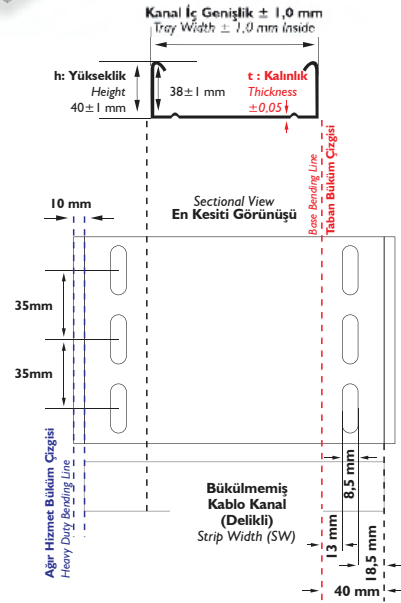
**DELİKSİZ AĞIR HİZMET TİPİ KABLO KANALLARI**  
 NON-PERFORATED HEAVY DUTY TYPE CABLE TRAYS

'm' Destekler Arası Mesafe  
'm' Span Between Supports

Kilogram Olarak Müsade  
Edilen Kablo Kanalı Yüğü  
Cable Tray Load in Kg

**EK ELEMANI**  
 JOINT PIECE

**AÇIKLAMALAR / INSTRUCTIONS :**

NOT: Ölçü toleransı ± 3 mm'dir.

! Belirtilen ağırlıklar kesim ağırlıklarıdır.

! Metrik 8 civata ve somun kullanımına uygundur.

NOTE: The dimension tolerance in perforated cable trays is ± 3 mm

! The indicated weights are the weights before fabrication.

! Convenient for M8 bolt and nut usage.

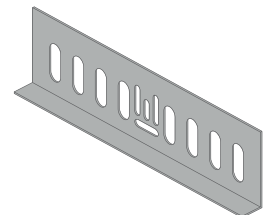
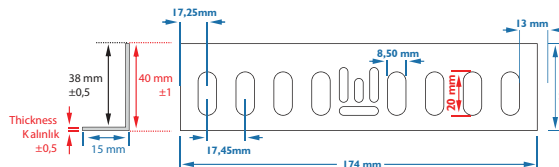

Sipariş Kodu (Order Code)	w (mm)	h (mm)	t (mm)	Kg/Mt (Kg/Mt)
AP-05DHA.08	50	50	0,80	1,030
AP-05DHA.10	50	50	1,00	1,287
AP-05DHA.12	50	50	1,20	1,545
AP-05DHA.15	50	50	1,50	1,931
AP-05DHA.20	50	50	2,00	2,317
AP-07DHA.08	70	50	0,80	1,156
AP-07DHA.10	70	50	1,00	1,444
AP-07DHA.12	70	50	1,20	1,733
AP-07DHA.15	70	50	1,50	2,167
AP-07DHA.20	70	50	2,00	2,599
AP-10DHA.08	100	50	0,80	1,344
AP-10DHA.10	100	50	1,00	1,680
AP-10DHA.12	100	50	1,20	2,016
AP-10DHA.15	100	50	1,50	2,520
AP-10DHA.20	100	50	2,00	3,024
AP-12DHA.08	120	50	0,80	1,470
AP-12DHA.10	120	50	1,00	1,837
AP-12DHA.12	120	50	1,20	2,204
AP-12DHA.15	120	50	1,50	2,755
AP-12DHA.20	120	50	2,00	3,379
AP-15DHA.08	150	50	0,80	1,658
AP-15DHA.10	150	50	1,00	2,078
AP-15DHA.12	150	50	1,20	2,487
AP-15DHA.15	150	50	1,50	3,109
AP-15DHA.20	150	50	2,00	3,740
AP-20DHA.08	200	50	0,80	1,972
AP-20DHA.10	200	50	1,00	2,465
AP-20DHA.12	200	50	1,20	2,958
AP-20DHA.15	200	50	1,50	3,697
AP-20DHA.20	200	50	2,00	4,437
AP-25DHA.12	250	50	1,20	3,429
AP-25DHA.15	250	50	1,50	4,286
AP-25DHA.20	250	50	2,00	5,143
AP-30DHA.12	300	50	1,20	3,900
AP-30DHA.15	300	50	1,50	4,875
AP-30DHA.20	300	50	2,00	5,800
AP-40DHA.15	400	50	1,50	6,052
AP-40DHA.20	400	50	2,00	7,263
AP-50DHA.15	500	50	1,50	7,230
AP-50DHA.20	500	50	2,00	8,676
AP-60DHA.15	600	50	1,50	8,408
AP-60DHA.20	600	50	2,00	10,090

DELİKSİZ AĞIR HİZMET TİPİ KABLO KANALLARI  
NON-PERFORATED HEAVY DUTY TYPE CABLE TRAYS

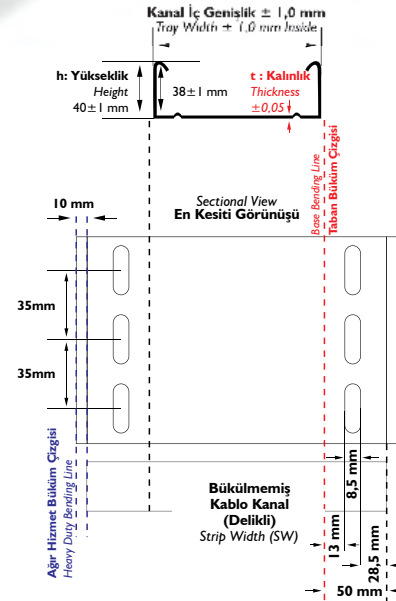

'm' Destekler Arası Mesafe  
'm' Span Between Supports

Kilogram Olarak Müsadere Edilen Kablo Kanalı Yüklü  
Cable Tray Load in Kg

Sipariş Kodu (Order Code)	w (mm)	h (mm)	t (mm)	L (mm)	Kg/Adet (Kg/Pcs.)
AP-KNI-05.12	15	52	1,20	174	0,110

EK ELEMANI  
JOINT PIECE

► AÇIKLAMALAR / INSTRUCTIONS :

NOT: Ölçü toleransı ± 3 mm.'dir.

! Belirtilen ağırlıklar kesim ağırlıklarıdır.

! Metrik 8 civata ve somun kullanımına uygundur.

NOTE: The dimension tolerance in perforated cable trays is ± 3 mm

! The indicated weights are the weights before fabrication.

! Convenient for M8 bolt and nut usage.

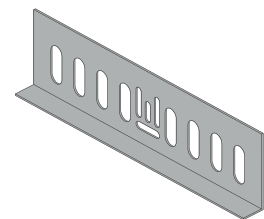
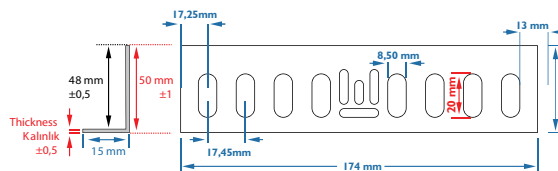

Sipariş Kodu (Order Code)	w (mm)	h (mm)	t (mm)	Kg/Mt (Kg/Mt)
AP-05DEHA.08	50	60	0,80	1,156
AP-05DEHA.10	50	60	1,00	1,444
AP-05DEHA.12	50	60	1,20	1,733
AP-05DEHA.15	50	60	1,50	2,167
AP-05DEHA.20	50	60	2,00	2,599
AP-07DEHA.08	70	60	0,80	1,281
AP-07DEHA.10	70	60	1,00	1,601
AP-07DEHA.12	70	60	1,20	1,922
AP-07DEHA.15	70	60	1,50	2,402
AP-07DEHA.20	70	60	2,00	2,882
AP-10DEHA.08	100	60	0,80	1,470
AP-10DEHA.10	100	60	1,00	1,837
AP-10DEHA.12	100	60	1,20	2,204
AP-10DEHA.15	100	60	1,50	2,755
AP-10DEHA.20	100	60	2,00	3,307
AP-12DEHA.08	120	60	0,80	1,595
AP-12DEHA.10	120	60	1,00	1,994
AP-12DEHA.12	120	60	1,20	2,393
AP-12DEHA.15	120	60	1,50	2,991
AP-12DEHA.20	120	60	2,00	3,589
AP-15DEHA.08	150	60	0,80	1,784
AP-15DEHA.10	150	60	1,00	2,229
AP-15DEHA.12	150	60	1,20	2,675
AP-15DEHA.15	150	60	1,50	3,344
AP-15DEHA.20	150	60	2,00	4,102
AP-20DEHA.08	200	60	0,80	2,098
AP-20DEHA.10	200	60	1,00	2,622
AP-20DEHA.12	200	60	1,20	3,146
AP-20DEHA.15	200	60	1,50	3,933
AP-20DEHA.20	200	60	2,00	4,720
AP-25DEHA.12	250	60	1,20	3,617
AP-25DEHA.15	250	60	1,50	4,522
AP-25DEHA.20	250	60	2,00	5,426
AP-30DEHA.12	300	60	1,20	4,088
AP-30DEHA.15	300	60	1,50	5,110
AP-30DEHA.20	300	60	2,00	6,132
AP-40DEHA.15	400	60	1,50	6,288
AP-40DEHA.20	400	60	2,00	7,545
AP-50DEHA.15	500	60	1,50	7,465
AP-50DEHA.20	500	60	2,00	8,959
AP-60DEHA.15	600	60	1,50	8,585
AP-60DEHA.20	600	60	2,00	10,372

Sipariş Kodu (Order Code)	w (mm)	h (mm)	t (mm)	L (mm)	Kg/Adet (Kg/Pcs.)
AP-KN1-06.12	15	62	1,20	174	0,126

AÇIKLAMALAR / INSTRUCTIONS :	
NOT:	Ölçü toleransı $\pm 3$ mm.'dir.
!	Belirtilen ağırlıklar kesim ağırlığıdır.
!	Metrik 8 civata ve somun kullanımına uygundur.
NOTE:	The dimension tolerance in perforated cable trays is $\pm 3$ mm
!	The indicated weights are the weights before fabrication.
!	Convenient for M8 bolt and nut usage.

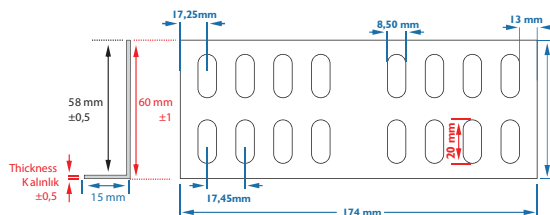
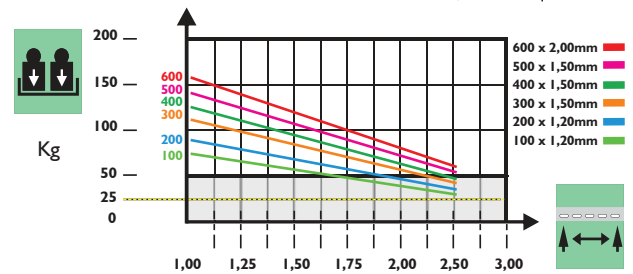
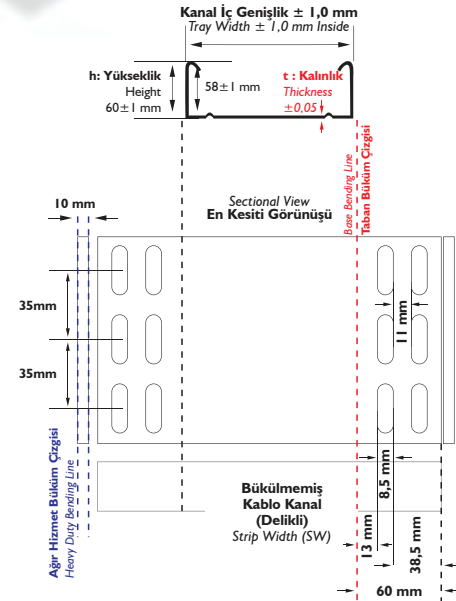
**DELİKSİZ AĞIR HİZMET TİPİ KABLO KANALLARI**  
 NON-PERFORATED HEAVY DUTY TYPE CABLE TRAYS

 'm' Destekler Arası Mesafe  
 'm' Span Between Supports

 Kilogram Olarak Müsade  
 Edilen Kablo Kanalı Yüğü  
 Cable Tray Load in Kg

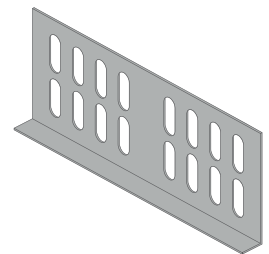
**EK ELEMANI**  
 JOINT PIECE

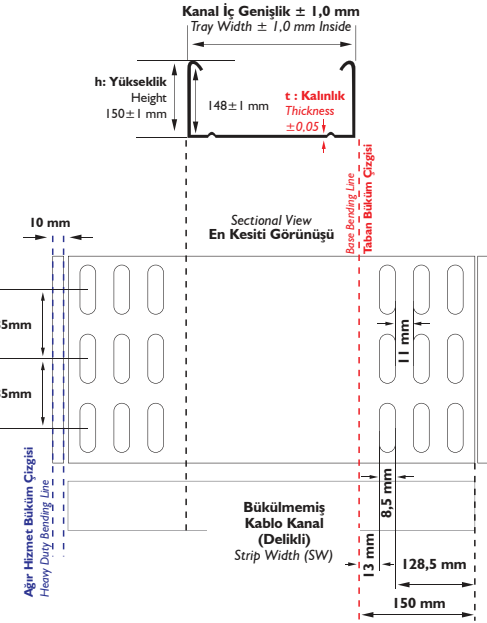
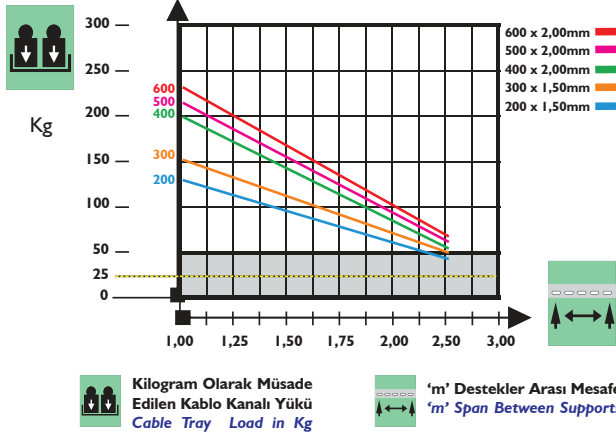

Sipariş Kodu (Order Code)	w (mm)	h (mm)	t (mm)	Kg/Mt (Kg/Mt)
AP-15DEAH.15	150	150	1,50	5,464
AP-15DEAH.20	150	150	2,00	6,556
AP-20DEAH.15	200	150	1,50	6,052
AP-20DEAH.20	200	150	2,00	7,263
AP-25DEAH.15	250	150	1,50	6,641
AP-25DEAH.20	250	150	2,00	7,969
AP-30DEAH.20	300	150	2,00	9,640
AP-40DEAH.20	400	150	2,00	11,210
AP-50DEAH.20	500	150	2,00	12,780
AP-60DEAH.20	600	150	2,00	14,350

**DELİKSİZ AĞIR HİZMET TİPİ KABLO KANALLARI**  
 NON-PERFORATED HEAVY DUTY TYPE CABLE TRAYS

Sipariş Kodu (Order Code)	w (mm)	h (mm)	t (mm)	L (mm)	Kg/Adet (Kg/Pcs.)
AP-AI-15.15	15	152	1,50	234	0,454

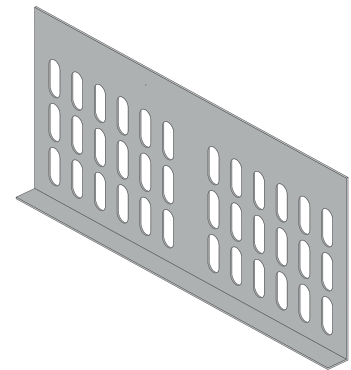
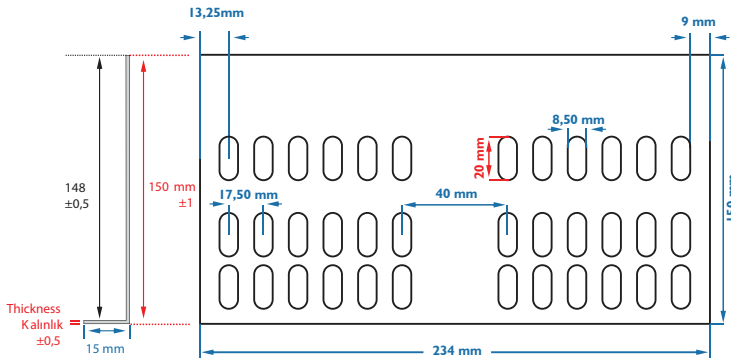
**EK ELEMANI**  
 JOINT PIECE

- AÇIKLAMALAR / INSTRUCTIONS :**
- NOT:** Ölçü toleransı ± 3 mm.'dir.
- ! Belirtilen ağırlıklar kesim ağırlıklarıdır.
- ! Metrik 8 cıvata ve somun kullanımına uygundur.
- NOTE:** The dimension tolerance in perforated cable trays is ± 3 mm
- ! The indicated weights are the weights before fabrication.
- ! Convenient for M8 bolt and nut usage.